

LOW VOLTAGE - model ME-826

LED MR16 Display Spot Light

WAC LIGHTING

Responsible Lighting®

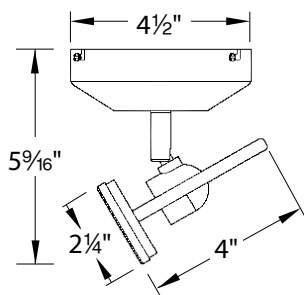

Fixture Type:

Catalog Number:

Project: _____

Location: _____

LED

Power:	8W	Color Temp:	3000K
Lumens:	450	CRI:	85
CBCP:	833	Dimming:	Yes
Comparable:	35 W MR16	Rated Life:	25,000 hours

PRODUCT DESCRIPTION

Engineered with an integral transformer and designed for mounting to walls or ceilings, Display Spot Lights deploy optimal accent lighting from surface mounted canopies that can be custom designed with any of WAC low voltage track heads.

FEATURES

- Integral Electronic transformer
- Accepts 12V LED MR16, Halogen MR16 lamps up to 50W max
- LED MR16 included when ordered as LED
- 1 watt minimum load
- Can be wall or ceiling mounted
- Available extensions from 6 to 48 inches
- Fixtures available with 6", 12", 18", 24", 36", 48", 72" and 96" extensions (factory assembled in BK, WT, or BN). Specify fixture style and finish when ordering (i.e.: ME-826LED-X6-BK). Extended fixtures are available only as a complete unit from the factory.
- Special lens types such as spread lenses and UV lenses can be ordered from WAC and used in place of the supplied clear lens.

SPECIFICATIONS

Construction: Die-cast aluminum fixture with bi-pin ceramic socket and 18 gauge teflon insulated wires, with fiberglass sleeves. Supplied with tempered clear glass lens.

Transformer: 120V/12V Electronic transformer with auto reset, soft start, and short circuit protection features.

Dimming: Smooth and continuous ELV dimming to 10%

Aiming: 350° horizontal rotation and 90° vertical aiming. Two aiming screws (one on each side of fixture) allow for locking fixture aiming angle.

Standards: UL & CUL Listed

ORDER NUMBER

Model #	Lamping	Extension (Optional)	Finish
ME-826LED	LED	X6 6"	BK Black BN Brushed Nickel WT White
		X12 12"	
ME-826	Halogen	X18 18"	
		X24 24"	
		X36 36"	
		X48 48"	



Example: **ME-826LED-BK** or **ME-826LED-X6-BK**

ALTERNATIVE LENSES

		Color
Color Lens	LENS-16	AMB Amber BLU Blue GRN Green RED Red YEL Yellow
	UV Filter Lens	LENS-16-UVF
	Frosted Lens	LENS-16-FR
	Spread Lens	LENS-16-SPR
Beam Elongating	LENS-16-BEL	
Honeycomb Louver	LENS-16-HCL	

WAC Lighting

www.waclighting.com
Phone (800) 526.2588 • Fax (800) 526.2585

Headquarters/Eastern Distribution Center

44 Harbor Park Drive • Port Washington, NY 11050
Phone (516) 515.5000 • Fax (516) 515.5050

Western Distribution Center

1750 Archibald Avenue • Ontario, CA 91760
Phone (800) 526.2588 • Fax (800) 526.2585