

Type _____
 -30EB
 P7094
 P7095
 P7096

Catalog No.	Finish	Lamping	Dimensions (Inches)		
	White		A	B	C
P7094	-30EB	2-F17T8	4	4-3/4	25-5/8
P7095	-30EB	2-F25T8	4	4-3/4	37-5/8
P7096	-30EB	2-F32T8	4	4-3/4	49-5/8

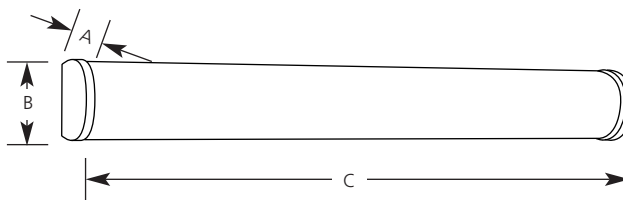

Specifications:

General

- Extruded white acrylic
- White opaque acrylic ends permanently attached
- Push-on installation – self centering
- Horizontal or vertical mounting
- Wall Mount only
- Complies with ADA 4" extension requirement
- Will accept 8623 decorative end caps
- Certified Energy Star Product

Housing

- White chassis complete with ends
- White cover plate
- 1/2" KO in back center, and one near each end for wiring
- Keyhole KO's on back near each end for mounting

Electrical

- Bi-pin twist-in sockets
- 120V HPF electronic two-lamp ballasts

Labeling

- UL-CUL listed

