

Assembly Instructions For

F2585/6+3 (E) 5/10

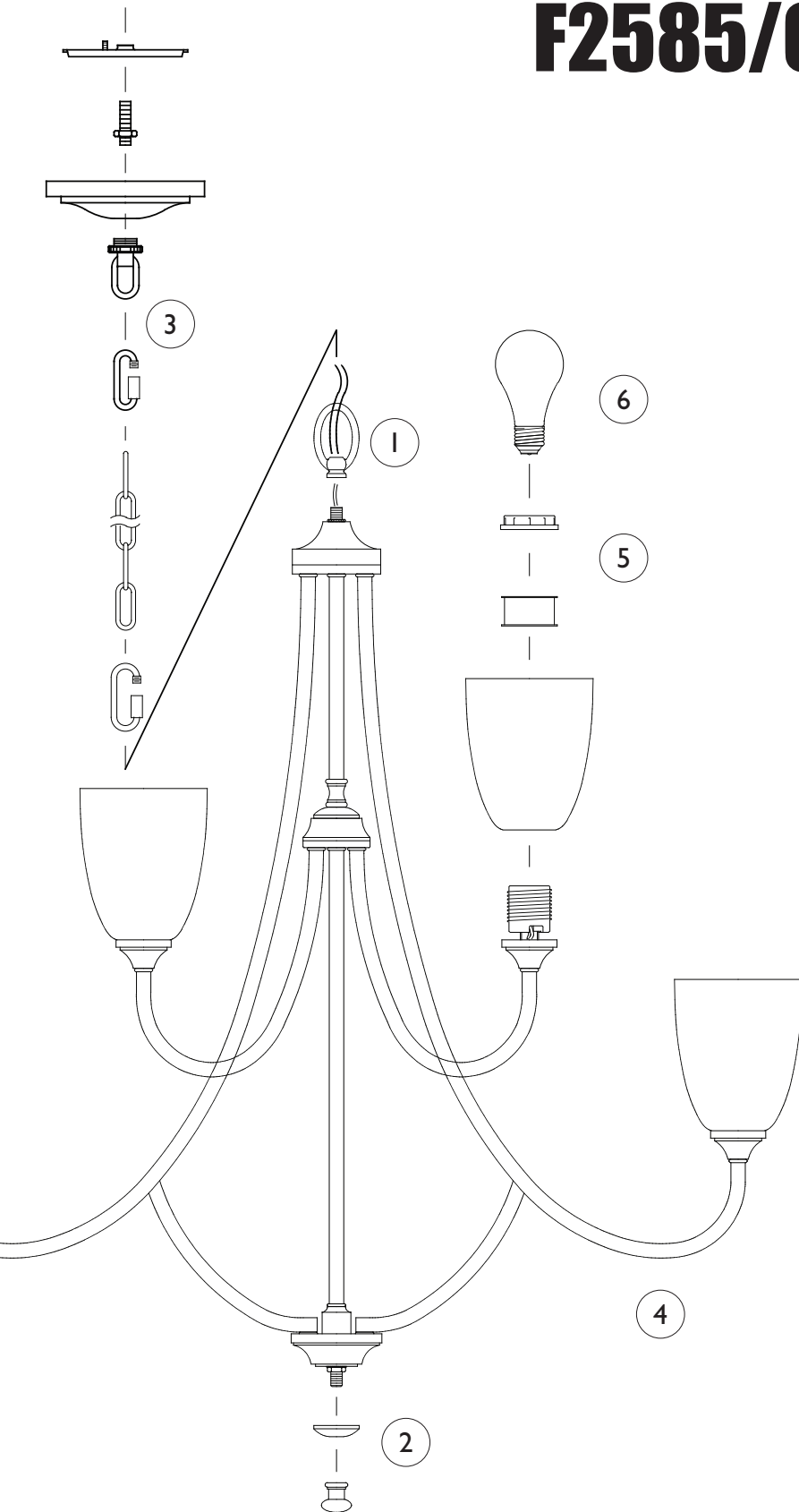

IMPORTANT
TURN OFF THE POWER AT THE MAIN
FUSE OR CIRCUIT BREAKER BOX
BEFORE STARTING INSTALLATION

Carefully unpack and identify all parts before assembly. Bulbs not included.

1. Slip fixture loop down through the fixture wires, and then screw on top of fixture.
2. Slip cover onto bottom of fixture and secure by fastening with finial.
3. Follow enclosed supplement installation instructions for electrical and fixture installation onto house outlet box. If you do not have an outlet box at desired location to attach the fixture then hire a qualified electrician to create one.
4. Turn arms so they are equally spaced apart from each other.
5. Install shade onto sockets by fastening with spacer tube and counter ring.
6. Install light bulb (not included). See relamping label at spacer tube for type and maximum allowed wattage.

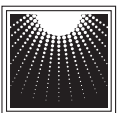

MURRAY
FEISS

GENERATION
BRANDS™