

### FEATURED MODEL

440953 Single Lever Bar, CHROME

### ADDITIONAL MODELS

440954 Single Lever Bar, SATIN NICKEL

### FEATURES

- Solid brass body
- Ceramic disk cartridge
- Extra long supply lines
- 2.2 GPM flow rate
- Installation in a 1-3/8" hole
- Color coded hot and cold supply lines
- 360 degree spout swivel
- 3-1/4" backsplash clearance off center
- 1-3/4" maximum deck thickness

### OPTIONAL ACCESSORIES

Meridian Soap Dispenser: 440059 (Chrome)

### CODE/STANDARDS COMPLIANCE

ASME A112.18.1-2011  
IAPMO listed  
CMR 248 - MA

**AB1953 Lead Free**

### WARRANTY

BLANCO'S kitchen and bar faucets feature a LIMITED LIFETIME WARRANTY to be free of all manufacturing defects under normal use. See our complete warranty for details.

While BLANCO endeavors to provide accurate information, all dimensions are nominal, cannot be guaranteed, and are subject to change or cancellation. BLANCO assumes no responsibility for use of superseded or voided specifications.

### JOB INFORMATION

Job Name: \_\_\_\_\_

Contact: \_\_\_\_\_

Date Specified: \_\_\_\_\_

Specifier: \_\_\_\_\_

Contractor: \_\_\_\_\_



Model 440953 shown

### NOMINAL DIMENSIONS

REACH	SPOUT HEIGHT	FAUCET HEIGHT
7"	7-3/4"	13-1/4"

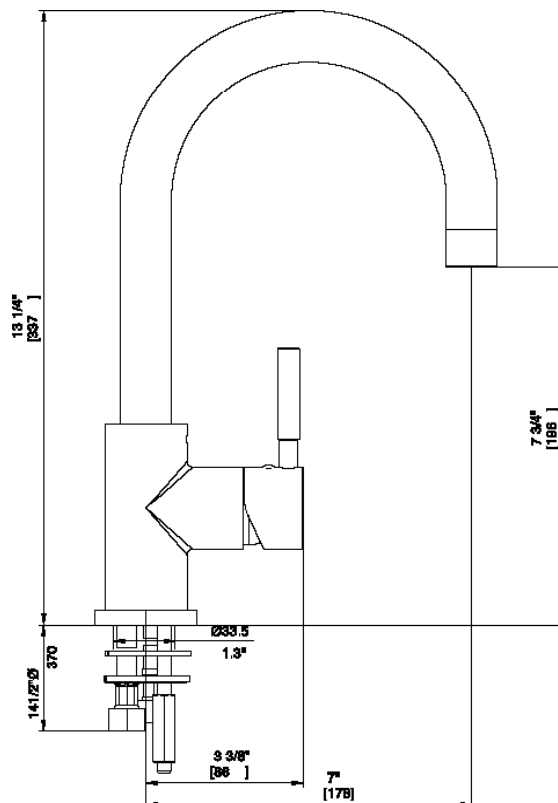

See next page for exploded parts drawing and parts list.

**BLANCO AMERICA**

800.451.5782

www.blancoamerica.com

© 2013 BLANCO AMERICA

11/14

SPEC-004

Old Model #: 157-105-CR

REPAIR PART GUIDE		
Num.	Description	Part #
1, 1.1	Handle, screw and cap - Chrome	441777
1.1	Handle - Screw and Cap only	441778
2	Cartridge - Cap	441780
3	Cartridge Lock Nut	441781
4	Cartridge	440750
5	Mounting nut assembly	441782
6	Aerator	441784
7	Ring set	441785

**Need to Change a Faucet Cartridge?**



Scan this QR code  
to see our how-to video

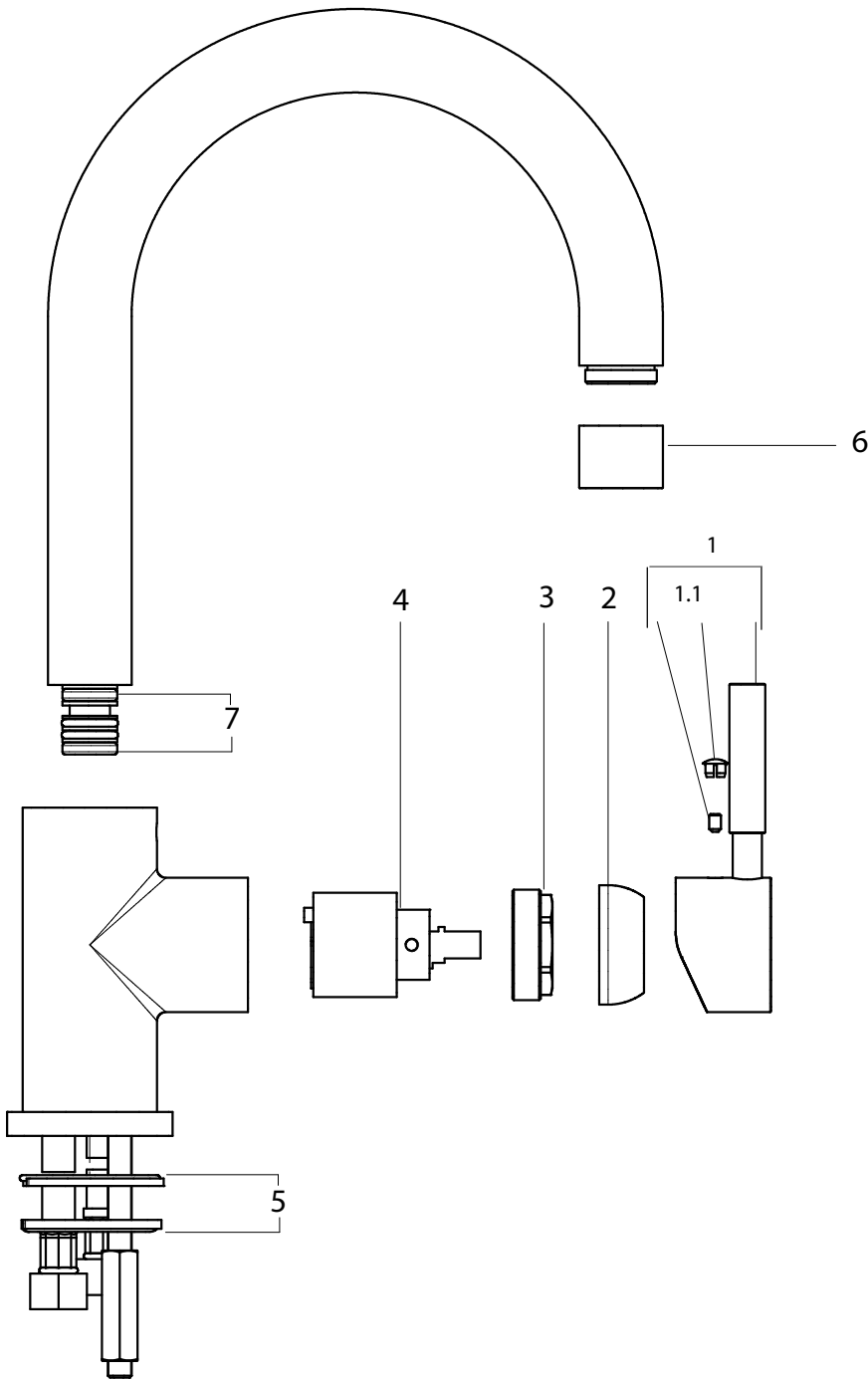

For faucet technical support or questions,  
 please e-mail us at [faucets@blancoamerica.com](mailto:faucets@blancoamerica.com)