

Slim Line Back Bar Refrigeration

FBB-24 Series *New!*

- FBB-24-48 • FBB-24-48G • FBB-24-48S • FBB-24-48GS
- FBB-24-60 • FBB-24-60G • FBB-24-60S • FBB-24-60GS
- FBB-24-72 • FBB-24-72G • FBB-24-72S • FBB-24-72GS
- FBB-24U-48 • FBB-24U-48G • FBB-24U-48S • FBB-24U-48GS
- FBB-24U-60 • FBB-24U-60G • FBB-24U-60S • FBB-24U-60GS
- FBB-24U-72 • FBB-24U-72G • FBB-24U-72S • FBB-24U-72GS



Item # _____

Standard Features

- Our new slim line back bar units have been designed to be fully front breathing, able to handle those tight bar applications and extreme **100°F environments**.
- Refrigeration system is a free flowing air system throughout the box to ensure "ICE COLD" products at all times with a side mount evaporator system.
- Heavy duty 18 gauge stainless steel top, durable stainless steel inside walls and coved corner floor. Reinforced bottom door frame to protect your long term investment.
- Unit comes standard with flat shelves on one door, balance with **adjustable bottle rails** for greater merchandising and inventory control.
- Greater usable capacity with the ability for 3 tall boys high and ability to take the beer the full depth of the box.
- **Field interchangeable doors** from Solid to Glass or Glass to Solid to adapt to ever changing needs.
- Units come with compressor mounted on the left side with service friendly slide out rail system.
- LED light underneath the mullion to protect itself from normal operations.



FBB-24-48G



FBB-24-72S

Options & Accessories

- Additional adjustable rails
- 2.5" Castors
- 6" Adjustable stainless steel legs
- 220 volts / 50 cycles / 1 phase



*Conforms to UL & NSF-7 standards

Slim Line Back	Model*	Doors	Capacity 12 Oz cans	Capacity 12 Oz Bottles	Kegs	Shlvs	Amp	HP	Volt	NEMA Plug	Cabinet Dimensions			Shipping (Wt. Cubes)	
											W	D	H		
	FBB-24(U)-48(S)	2	300	360	2	4	7.4	1/4	115	5-15P	49-5/8"	24-5/8"	35-1/2"	213	7.4
	FBB-24(U)-60(S)	2	390	450	3	4	8.4	1/4	115	5-15P	62-1/4"	24-5/8"	35-1/2"	266	8.4
	FBB-24(U)-72(S)	3	540	612	3	6	9.2	1/4	115	5-15P	72"	24-5/8"	35-1/2"	319	9.2
	FBB-24(U)-48G(S)	2	300	360	2	4	7.4	1/4	115	5-15P	49-5/8"	24-5/8"	35-1/2"	237	7.4
	FBB-24(U)-60G(S)	2	390	450	3	4	8.4	1/4	115	5-15P	62-1/4"	24-5/8"	35-1/2"	290	8.4
	FBB-24(U)-72G(S)	3	540	612	3	6	9.2	1/4	115	5-15P	72"	24-5/8"	35-1/2"	341	9.2

(U): Undercounter models - 34" high / (S) Stainless steel units / (G) Glass door units.

Slim Line Back Bar Refrigeration

FBB-24 Series



Specifications Slim Line Back Bar

Construction

Heavy duty stainless steel top, 18 gauge. Black vinyl front, sides and back. (S) Models have stainless steel front and sides. Galvanized back panel. Interior constructed of heavy duty stainless steel walls with coved corner NSF approved stainless steel floor. Door is comprised of heavy duty black vinyl steel. (S) Models are stainless steel. (G) Models are a dual pane glass with black frame, (SG) Models are a dual pane glass with aluminum frame. Provided with lock per door, magnetic door gaskets, removable without tools. Door openings have a plastic breaker strips to retard condensate formation.

Unit comes complete with a 2" Ecomate CFC-Free polyurethane insulation, foamed in place.

Refrigeration System

Self-contained capillary tube system using environmentally friendly (CFC Free) R-134a refrigerant. Front breathing compressor on left side for built-in applications. Evaporator coil is mounted to interior left side above the compressor. Large fan motor and fan blades for greater air flow.

Automatic condensate evaporator, no drain connection required. Evaporator condensate has been plumbed to a condensate pan located in the compressor housing. Access for the condensing unit behind the front grill, slides out for easy cleaning and maintenance.

Cabinets are designed to maintain temperatures between 33° F to 38° F in the interior cabinet.

Lights

Interior LED light underneath the mullion.

Shelving

Two adjustable epoxy coated shelves provided per door standard. One door with standard flat shelves, balance will come with adjustable bottle rails.

Others

Unit is supplied standard with an 8' cord and plug (Nema 5-15p).

Warranty

3 year parts and labor warranty plus 2 additional year compressor warranty. (Continental U.S.A. & Canada only).

FBB-24-48 Top View

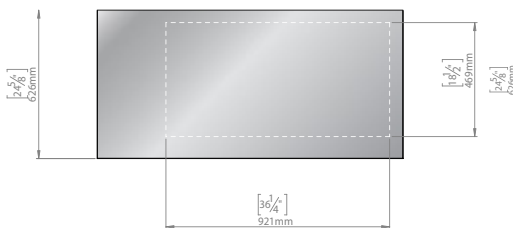

FBB-24-60 Top View

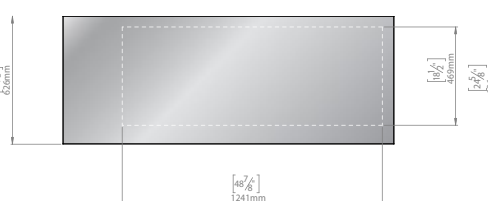

FBB-24-72 Top View

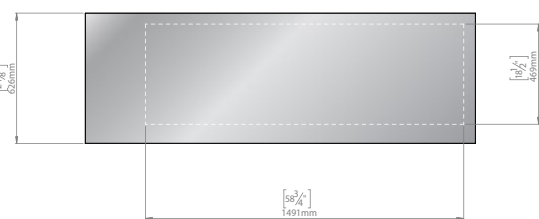

FBB-24-48 Front View

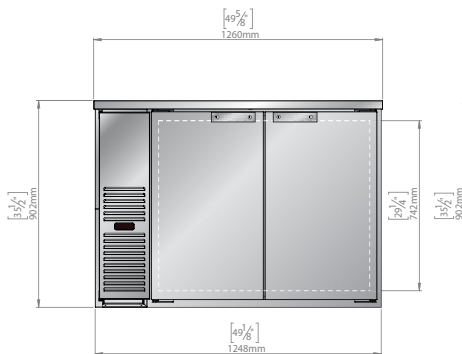

FBB-24-60 Front View

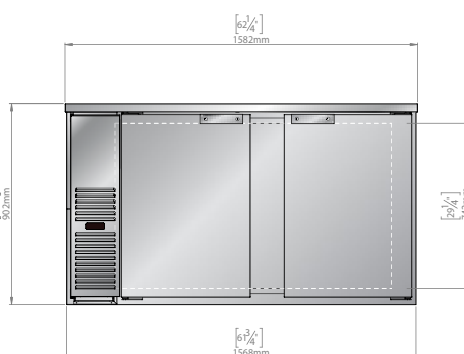

FBB-24-72 Front View

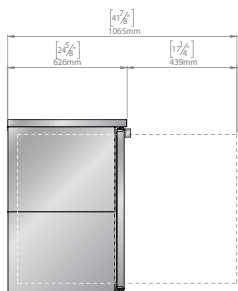
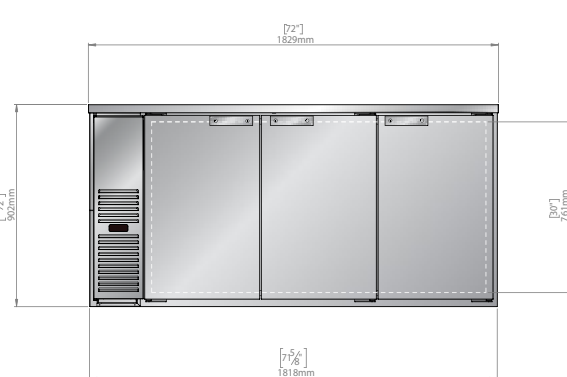

Common Side View

The manufacturer reserves the rights to modify materials and specifications without notice.

