

This adaptor will fit a sink opening of: 4-1/2" I.D. and NO FLANGE

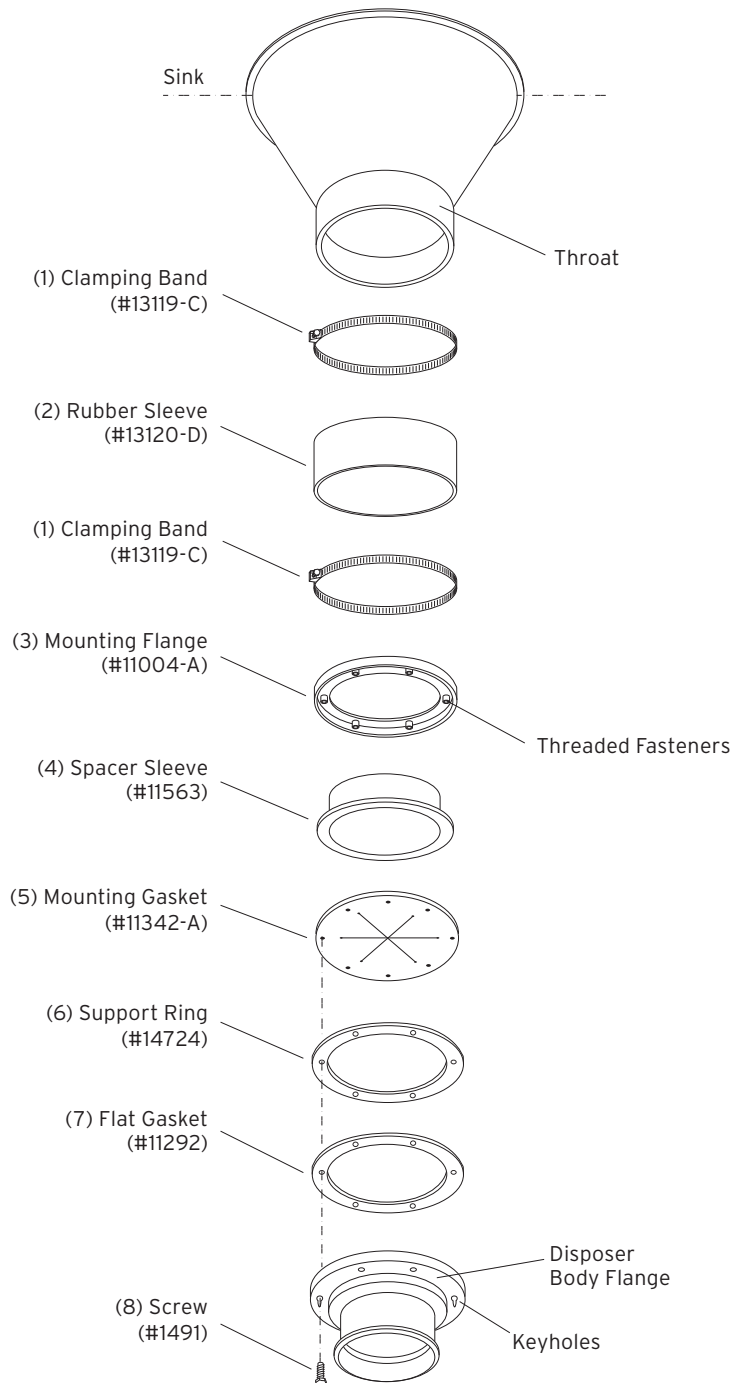

Installation Instructions (SUPPORT LEGS ARE REQUIRED)

1. Assemble the rubber sleeve (2) to the throat of the sink bowl with one of the clamping bands (1).
 2. Insert the flange of the spacer sleeve (4) into the groove of the mounting gasket (5).
 3. Place the flat gasket (7), support ring (6), spacer sleeve/mounting gasket assembly on top of the disposer body flange. Slide the mounting flange (3) over the spacer sleeve (4) and onto the mounting gasket (5). Be certain that the threaded fasteners in the mounting flange (3) fit into the recesses in the top of the mounting gasket (5).
 4. Fasten six screws (8) through holes in disposer body flange, flat gasket (7), support ring (6), mounting gasket (5), and into the threaded fasteners in the mounting flange (3). Tighten screws evenly.
 5. Position the disposer under the rubber sleeve (2). Extend the adjustable legs of the disposer to provide support from the floor.
- NOTE:** Disposers from 3 H.P. through 10 H.P. have factory assembled legs. Disposers from 1/2 H.P. through 2 H.P. require two accessory legs.
6. Turn the disposer into position for plumbing connections. Slide the spacer sleeve (4) into the bottom of the rubber sleeve (2) and tighten with the other clamping band (1). Adjust the support legs for final positioning.