

# Duro™



- 363TB-18 Towel bar
- 363TB-24 Towel bar
- 363DTB-18 Towel bar
- 363DTB-24 Towel bar
- 363TS-22 Towel shelf
- 363TR Towel ring
- 363RH Robe hook
- 363TP Paper holder



### Feature Highlights

- Metal construction
- Standard finish is polished chrome

### Finish Options

- Append appropriate-suffix to model number.
- STN Satin Nickel finish

### Warranty

- Limited Lifetime - to the original end purchaser in residential/consumer installations
- 5 years - for commercial installations

## MEASUREMENT BEFORE INSTALLATION

MODEL NO.	LENGTH X=inch
363TB-18	18.03
363TB-24	23.62
363DTB-18	18.03
363DTB-24	23.62
363TS-22	22.05

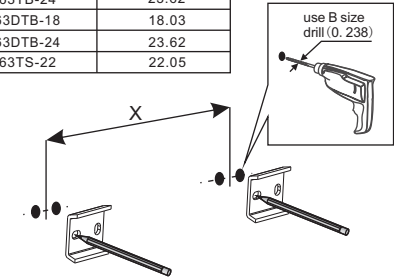

1

Measure and mark holes as listed in the above table. Drill screw mounting holes using a B size drill bit (0.238). **-IMPORTANT:** Ensure that the holes you have drilled for installation are level.

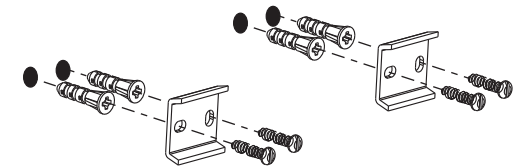

2

Affix your mounting hardware to the wall using your mounting screws. - For walls with brick or other types on masonry we suggest using nylon plugs. For cavity walls we suggest using toggle anchors if you are unable to screw into studs.

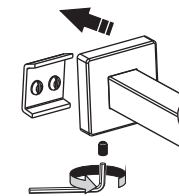

3

After securing your mounting hardware to the wall place the mounting end of your accessory onto the mounting hardware as is shown in the picture below. - Affix your accessory to the mounting hardware using the allen wrench that shipped with the product.

## RECOMMENDED TOOLS AND MATERIALS



Drill

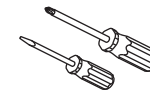

Flathead Screwdriver, Phillips Screwdriver



Tape Measure

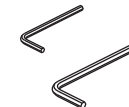

Hex Wrench

■ All specifications subject to change without prior notice. (Unit = inch)

DIMENSIONS

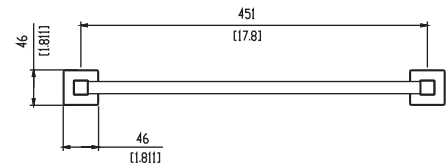

363TB-18

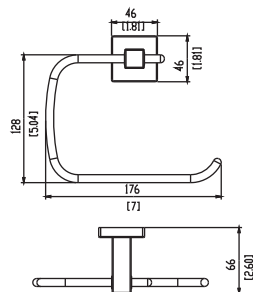
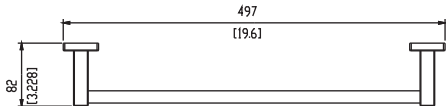

363TR

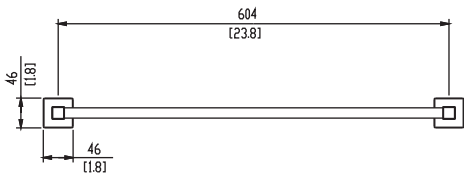

363TB-24

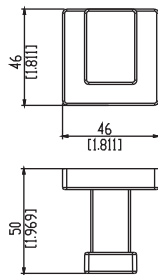
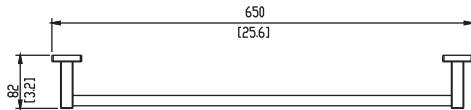

363RH

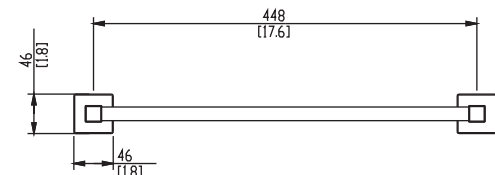

363DTB-18

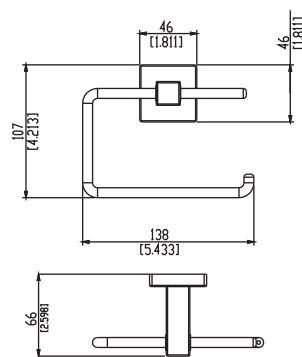
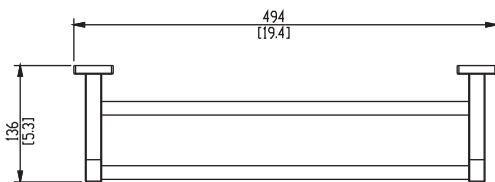

363TP

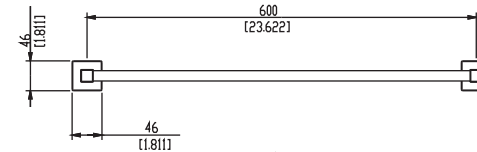

363DTB-24

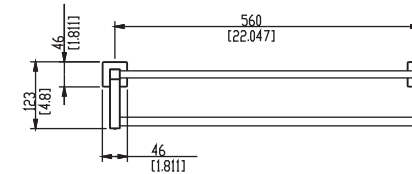
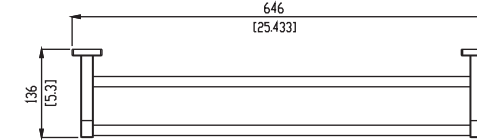

363TS-22

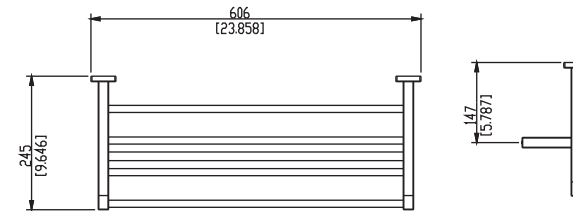

IMPORTANT CLEANING INSTRUCTIONS

- ▲ To ensure that your Symmons product will continue to look as beautiful as the day it was installed, please follow these simple cleaning instructions.
  1. To clean the finish on your Symmons product, rinse with clean water, wipe with a soft damp cloth and blot dry with a soft cotton cloth or towel.
  2. If heavy cleaning is required start by cleaning as described in Step 1. Use a mild liquid soap or liquid glass cleaner to remove any remaining surface buildup. Rinse product with clean water to remove any remaining cleaning solution and blot dry with a soft cotton cloth or towel.
- ▲ Do not use cleaning products containing abrasives, acids, alcohol, bleach or foaming compounds. If any unintentional splashing or overspray of these types of cleaning products comes in contact with your Symmons product, immediately rinse it with clean water and blot dry with a clean soft cotton cloth or towel.