

WARRANTY
 Limited Lifetime – Residential
 Limited 25-year – Commercial

Manufactured from Swanstone solid surface
 (see page 2 for detailed information)

Recommended for high use traffic areas and commercial surfaces

FEATURES

- Reinforced solid surface means color and texture run all the way through and cannot wear away
- Renewable surface will not wear away
- Coordinates with Swanstone shower and bath systems
- Wide variety of styles, sizes and colors
- Easily accommodates all faucet styles
- Chemical resistant—acetone will not harm
- Heat resistant—hot curling irons will not burn
- Make-up and hair-dye can be buffed out with household cleansers
- Heat, stain and scratch resistant for lasting beauty

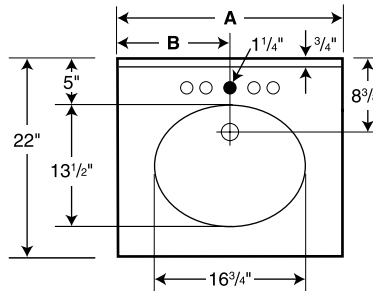

Model	A	B
VT1B2225	25"	12-1/2"
VT1B2231	31"	15-1/2"
VT1B2237	37"	18-1/2"
VT1B2243	43"	21-1/2"
VT1B2249	49"	24-1/2"
VT1B2255	55"	27-1/2"
VT1B2261	61"	30-1/2"

○ Drill Points ● Pre-drilled

Capacity:
 1-3/4 gallons
 to overflow

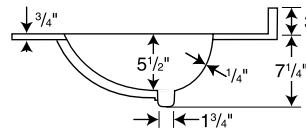

Available only in minimum quantities and limited colors

SPECIFICATIONS

Ellipse 22" Single Bowl Vanity Tops

Model	Part	Dimensions	Ship Wt. Lb.	Ship UPS	Carton Dims. In.	Cu. Ft.
VT1B2225	VT02225	22" D x 25" W	21	UPS	29 x 25 x 13	5.45
VT1B2231	VT02231	22" D x 31" W	26	UPS	35 x 25 x 13	6.58
VT1B2237	VT02237	22" D x 37" W	30	UPS	41 x 25 x 13	7.71
VT1B2243	VT02243	22" D x 43" W	31	UPS	46 x 25 x 13	8.65
VT1B2249	VT02249	22" D x 49" W	36	UPS	53 x 25 x 12	9.21
VT1B2255	VC02255	22" D x 55" W	55	-	58 x 25 x 13	10.91
VT1B2261	VC02261	22" D x 61" W	59	-	63 x 27 x 13	12.80

COLORS (See pg. 139 for color sample.)

- White (010)
- Bone (037)
- Bisque (018)
- Arctic Granite (035)
- Gray Granite (042)
- Tahiti Desert (050)
- Tahiti Ivory (059)
- Cornflower (063)

Kit Includes: One compression molded vanity top with overflow and integral bowl and back splash plus complete installation instructions.

Packaging: Each Swanstone unit is packed in a rectangular carton.

ACCESSORIES

- Optional VT21-3SS Side Splash available (see page 40)
- Optional Front and Side Apron available (see page 40)

STANDARDS AND RATINGS

Class 1A fire rating
 American National Standard Institute—ANSI Z124.3
 International Association of Plumbing and Mechanical Officials (IAPMO)—listed
 cUPC listed—Certified to CSA Standard B45 by IAPMO
 National Sanitation Foundation-NSF Splash Zone, -NSF Food Zone
 American Society for Testing and Materials
 National Electrical Manufacturers Association

For a complete list of tests and results see the Technical Data Sheet – page 129.

SUPPORT DOCUMENTS

Installation instructions available on line at www.swanstone.com

MAINTENANCE AND CLEANING INFORMATION

Clean your Swanstone vanity top with powdered abrasive cleaners. Use of a Scotch-Brite pad is recommended to remove stubborn stains. Occasional use of a mild bleach and water solution ensures that the original luster is maintained.