



Single Door Series Refrigerator & Freezer Top Mount Compressor

KTSR-1 | KTSF-1

Durable Design

- Stainless steel interior & exterior
- Coated evaporator coil
- 3 height adjustable, heavy duty, PE coated wire shelves
- LED interior lighting
- Digital temperature display
- Door lock with keys
- Simple plug-in installation
- Oversized top mount compressor section
- Door swing is field reversible with kit # KB-BLHK

Energy Efficient

- Self-closing door with stay open feature
- Seals tight with magnetic vinyl gasket
- Open door alert beeps when door has been open for 3 minutes.
- Foamed-in place high-density polyurethane insulated body, CFC-free
- Large evaporator & condenser for quick cooling and greater efficiency

Superior Quality

- Designed for mobility, reliability & efficiency in commercial kitchens
- Certified with ETL & Energy Star guaranteeing quality standards and energy efficiency
- 4" swivel castors with 2 front brakes
- Easy grip handle
- Entirely self-contained system
- Automatic defrost system
- Digitally controlled temperature system
- Accommodates full-size bun sheet pans
- Easily adjustable shelf height
- Internal storage capacity is 19.4 cu. ft.
- NEMA 5-15 plug
- R-290 Natural Refrigerant
- Compressor : Refrigerator - 1/4 HP / Freezer - 1/2 HP Holding temperature:
Refrigerator 33°F to 39°F / Freezer 5°F to -9.4°F



Nema 5-15P
Dedicated Circuit



| | |
|---------------|------|
| Project Name: | |
| Location: | |
| Item: | Qty: |
| Model: | |



5659 Royalmount Ave.
Montreal, QC, Canada H4P 2P9
Telephone: 514.737.9701 / Toll Free: 888.275.4538
Fax: 514.342.3854 / Toll Free: 877.453.8832
sales@mvpgroupcorp.com / mvpgroupcorp.com

Miami, FL, United States
Telephone: 786.600.4687 / Toll Free: 844.218.8477
Fax: 786.661.4100

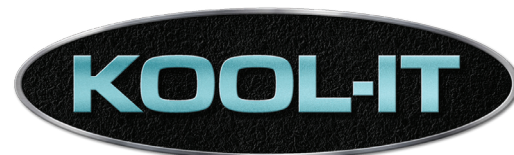

Single Door Series Refrigerator & Freezer Bottom Mount Compressor

KTSR-1 | KTSF-1

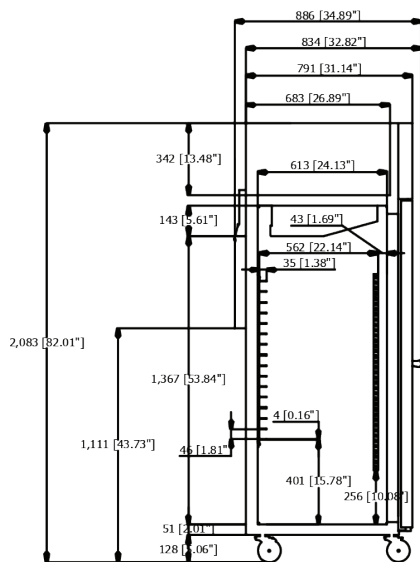

Side View

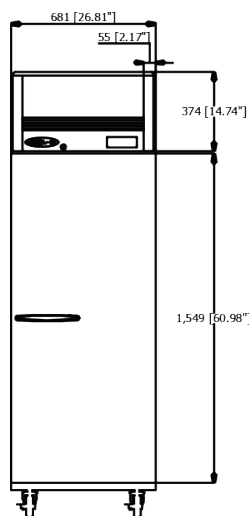

Front View

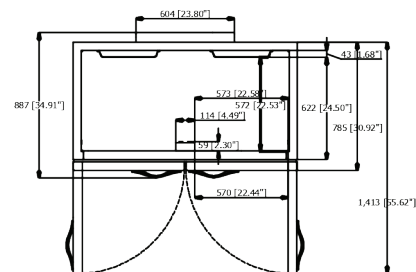

Top View

| Model Number | Description | # of Doors | # of Shelves | Capacity (cubic ft) | External Dimensions w/handle (W x D x H in) | Internal Dimensions (W x D x H in) | Compressor Size | Voltage / Frequency | Amps | Working Temp | Refrigerant | Ship Weight (lbs) |
|--------------|------------------------------------|------------|--------------|---------------------|---|------------------------------------|-----------------|---------------------|------|--------------|-------------|-------------------|
| KTSR-1 | Top Mount Single Door Refrigerator | 1 | 3 | 19.4 | 26.8 x 34.89 x 81.8 | 24.5 x 22.9 x 53.8 | 1/4 | 115V 60 HZ | 3.0 | 33°F to 39°F | R-290 | 315 |
| KTSF-1 | Top Mount Single Door Freezer | 1 | 3 | 19.4 | 26.8 x 34.89 x 81.8 | 24.5 x 22.9 x 53.8 | 1/2 | 115V 60 HZ | 4.9 | 5°F to -9°F | R-290 | 328 |



Nema 5-15P
Dedicated Circuit

These units are designed for maximum performance in an air-conditioned area of 75°F ambient temperature and 55% relative humidity. There must be adequate ventilation at the top, sides & rear of the unit for proper operation.

Warranty: 36 months parts and labor.
Additional 24 months on compressor (part only)

KOOL-IT is a registered trademark of MVP Group.
Specifications subject to change without notice.



5659 Royalmount Ave.
Montreal, QC, Canada H4P 2P9
Telephone: 514.737.9701 / Toll Free: 888.275.4538
Fax: 514.342.3854 / Toll Free: 877.453.8832
sales@mvpgroupcorp.com / mvpgroupcorp.com

Miami, FL, United States
Telephone: 786.600.4687 / Toll Free: 844.218.8477
Fax: 786.661.4100