

**QEPE_X**

CR POLYMER F1960 EXPANSION PEX ELBOW

SPECIFICATION SHEET

TAG _____

Dimensional Data (inches and [mm]) are Subject to Manufacturing Tolerances and Change Without Notice

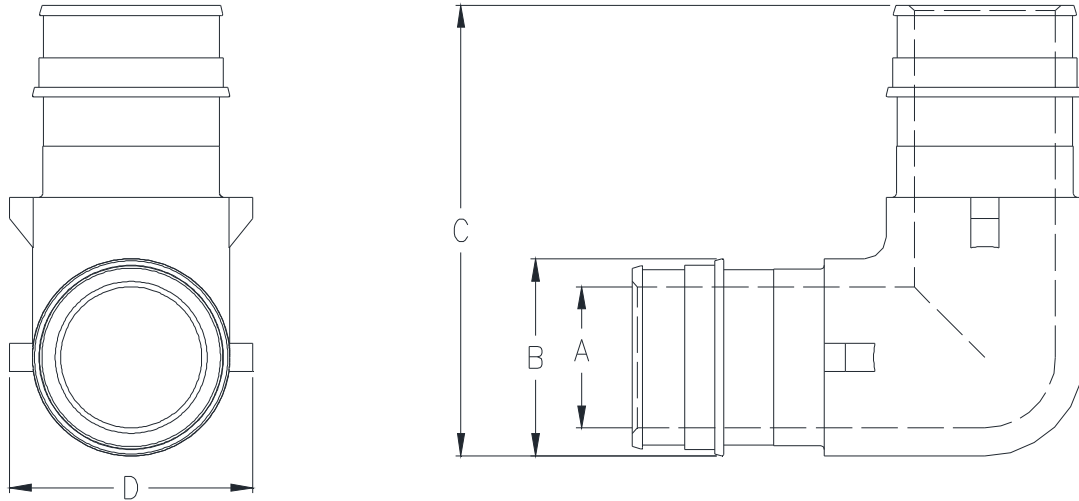

Part Number	CR F1960 Expansion PEX Elbow size	Dimensions in Inches [mm]			
		A	B	C	D
QEPE33X	1/2" EXPEX x 1/2" EXPEX	0.39 [10]	0.61 [16]	1.53 [39]	0.81 [21]
QEPE44X	3/4" EXPEX x 3/4" EXPEX	0.59 [15]	0.87 [22]	2.02 [51]	1.13 [29]
QEPE55X	1" EXPEX x 1" EXPEX	0.79 [20]	1.11 [28]	2.52 [64]	1.36 [35]
QEPE66X	1-1/4" EXPEX x 1-1/4" EXPEX	0.97 [25]	1.36 [34]	3.12 [79]	1.70 [43]
QEPE77X	1-1/2" EXPEX x 1-1/2" EXPEX	1.08 [28]	1.49 [38]	3.66 [93]	1.85 [47]
QEPE88X	2" EXPEX x 2" EXPEX	1.48 [38]	2.08 [53]	4.72 [120]	2.76 [70]

Engineering Specification: Zurn PEX® CR Polymer F1960 Expansion PEX Elbow

The QEPE_X is used to make sharp 90° bends in Zurn Non-Barrier PEX tubing in potable water applications. Molded from PPSU, these fittings, as a system with Zurn PEX® tube and Zurn PEX reinforcing rings are pressure rated at 160 PSI at 73°F, 100 PSI at 180°F, and 80 PSI at 200°F. These fittings are 3rd party certified as complying with the following standards: NSF/ANSI Standard 14, NSF/ANSI Standard 61, NSF/ANSI Standard 372 (Low Lead), ASTM F1960, CSA B137.5.

Accessories

___	QER3X	1/2" PEX Expansion Reinforcing Ring w/ stop
___	QER4X	3/4" PEX Expansion Reinforcing Ring w/ stop
___	QER5X	1" PEX Expansion Reinforcing Ring w/ stop
___	QER6X	1-1/4" PEX Expansion Reinforcing Ring w/ stop
___	QER7X	1-1/2" PEX Expansion Reinforcing Ring w/ stop
___	QER8X	2" PEX Expansion Reinforcing Ring w/ stop
___	QEMT345	F1960 Manual Expansion Tool Kit - 1/2" to 1"