

# WYNDHAM COLLECTION

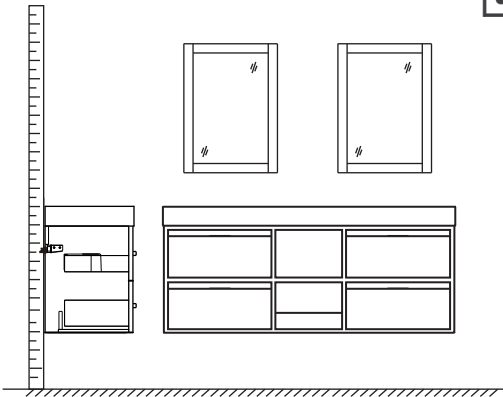

- Prior to installation please check received items against the "Packing List". Please report any missing items to your retailer immediately.
- Protect all surfaces from sharp objects, high heat sources, direct prolonged sunlight and chemical hazards.
- Professional installation recommended.

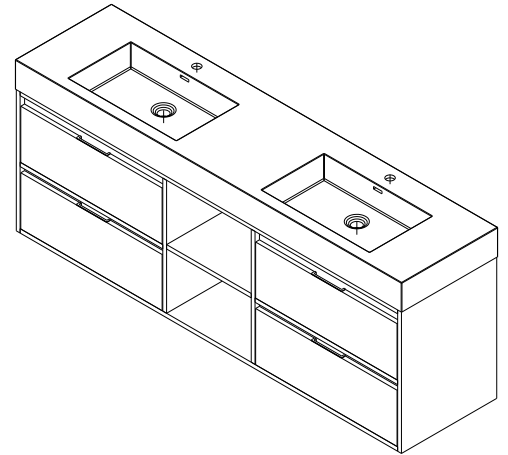

## PACKING LIST

(Not all components may be included, depending on your purchase)

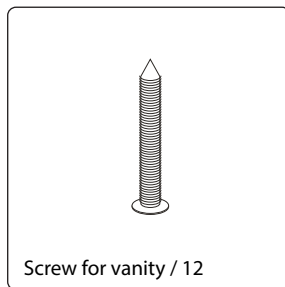
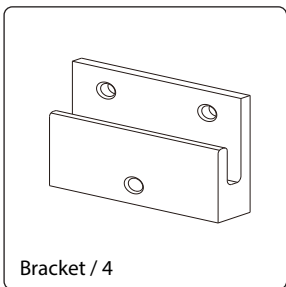
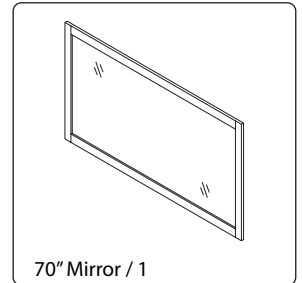
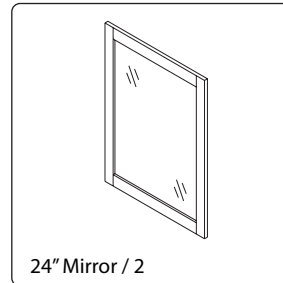
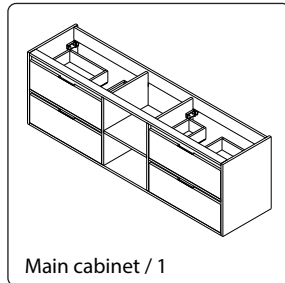
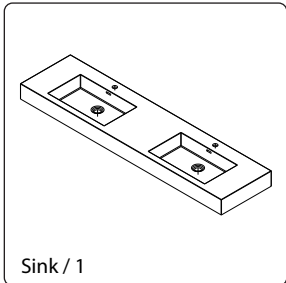

## INSTALLATION AND ADJUSTMENT OF HINGES (if required)

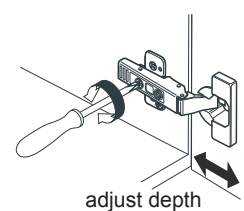
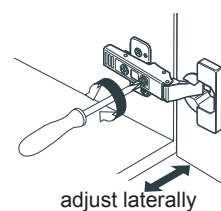
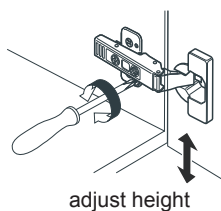
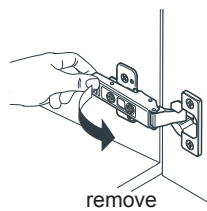
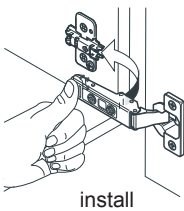

## REQUIRED TOOLS NOT IN BOX

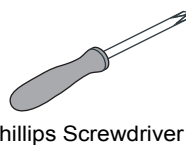
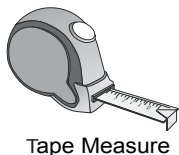

WC-R4600-72-DBL  
INSTALLATION-GUIDE

# WYNDHAM COLLECTION

## INSTALLATION INSTRUCTIONS

- ① Mark the position of the screw holes on the wall by measuring the space between the centers of the mounting brackets on the back of the vanity. Vertical position (X) is decided by the purchaser. Remember to mark low enough to accommodate the sink on the top of the top of the vanity counter or it will be too high when installed. Use a spirit level to ensure the screw holes are horizontal.

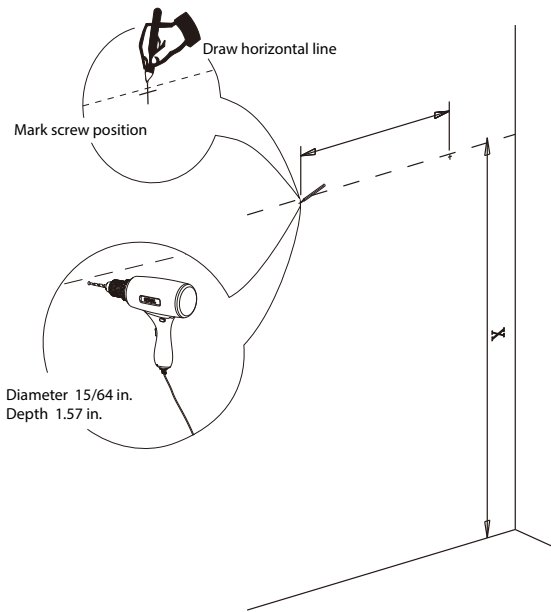

- ② Attach the bracket by screwing into a wall stud reinforcement.

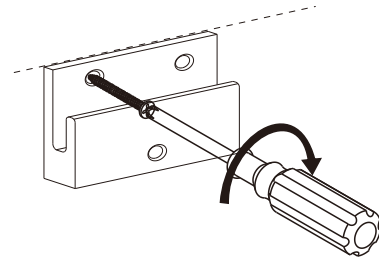

- ③ Attach vanity to wall by lowering onto the mounting brackets.

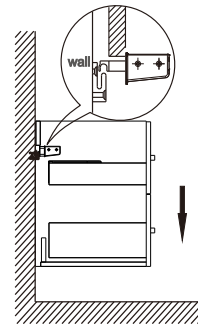

- ④ Adjust the mounting attachment as required.

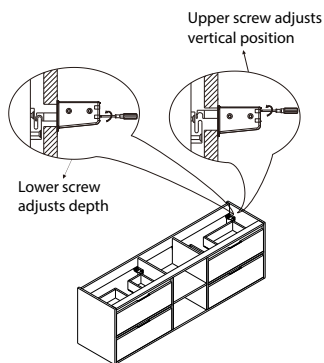

- ⑤ Attach counter to cabinet with silicone sealant applied to top of front and side cabinet edges. Do not over apply. Allow to dry for 24 hours for proper curing.

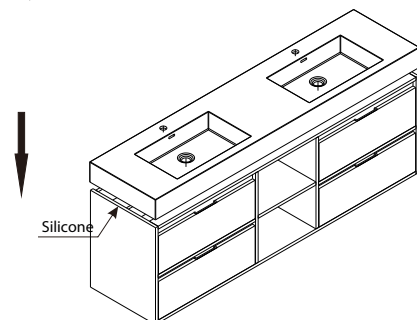

WC-R4600-72-DBL  
INSTALLATION-GUIDE

# WYNDHAM COLLECTION

- ⑥ Licensed professional installation recommended. These instructions are for mounting into studs or other in wall reinforcement, drywall alone is not sufficient to support wall hung vanities. Other installation techniques may require a licensed professional.

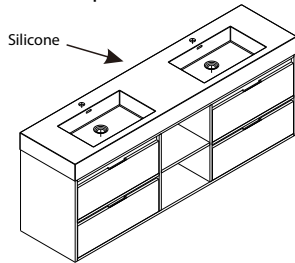

- ⑦ Install the mirror: use a pencil to mark the placement of the screw holes on the wall, drill the holes and insert the plastic wall anchors.

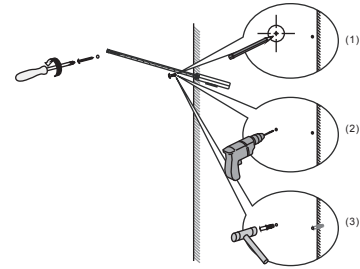

- ⑧ Install the screws into the wall anchors, leaving enough of the screw exposed to hang the mirror - approx. 1/4" - 1/2".

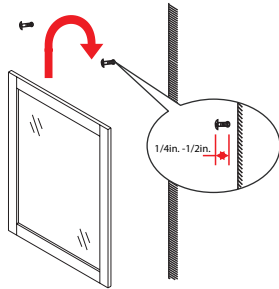

WC-R4600-72-DBL  
INSTALLATION-GUIDE