

# Product Specs Sheets

Cover Page

## Features

- Complete Vanity Unit
- Includes integrated sink and vanity top in gloss white ceramic
- Fully assembled
- Timeless design with clean and seamless look. Available in several finishes.
- Four soft close drawers with organizer in upper drawers
- Handle integrated in front of furniture
- Structure and front made of engineered wood in wood finishes and high gloss lacquered
- Wall-hung design offers a clean, streamlined look
- Hettich total extraction rails
- Hidden hanging bracket directly assembled with great resistance and depth regulations
- Sink with Faucet Hole and Overflow
- Choice of wire or lite decorative legs in 3 different finishes (optional)
- Made in Spain

## Ambra 120N









## Related Items:

- WSBC 53991 | Push Waste Drain
- WSBC 53922 | Decorative Trap

## SKU# | Options:

- Ambra 120N NO | Nordic Oak
- Ambra 120N SA | Samara Ash
- Ambra 120N WG | Glossy White
- Ambra 120N AN | Anthracite
- Ambra 120N WM | Matte White
- Ambra 120N SM | Matte Sand
- Ambra 120N RB | Royal Blue

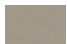
## Finishes:

-  Nordic Oak
-  Samara Ash
-  Glossy White
-  Anthracite
-  Matte White
-  Matte Sand
-  Royal Blue

## Codes & Standards:

- CARB2 Compliant and Certified
- TSCA Compliant and Certified

\* WS Bath Collections reserve the right to make revisions without notice to product specifications, dimensions, or information.

**Collection |**  
Ambra









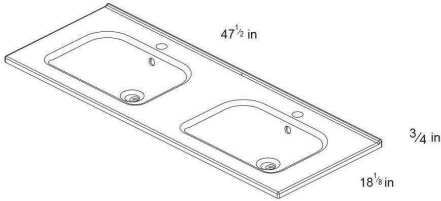

**Model |**  
Ambra 120N

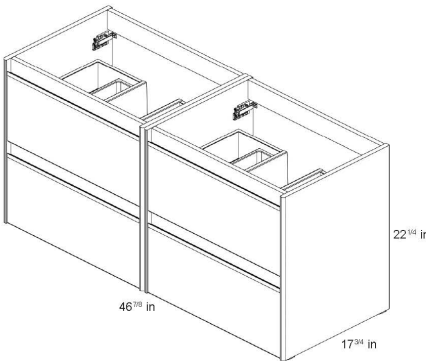
**Dimensions Metric**  
*1 inch = 2.54 cm*  
*1 inch = 25.4 mm*

**WS<sup>®</sup> BATH COLLECTIONS**

1051 Lea Drive - Collegeville, PA 19426  
Tel. 215 513 9400 - Fax 610 831 0215  
[www.ws bathcollections.com](http://www.ws bathcollections.com) - [info@ws bathcollections.com](mailto:info@ws bathcollections.com)

## Technical features

Technical drawing	Name	Material	Colour	Colour
	SLIM			Gloss White
	<b>AMBRA</b> 4 Drawers 	      		

## Technical information

STRUCTURE	MDF board in 5/8 in. continous wrapping in 2D/ Cyclum Process.
FRONT	MDF board in 5/8 in. continous wrapping in 2D/ Cyclum Process.
HANDLE	Integrated in the front of the furniture.
DRAWER	Drawers made in mokka textile poly laminate coated board with hidden parcial extraction runners with soft close system. Includes organizer in upper drawer. Lower drawer useful space (widthxhighxdepth): 20 <sup>1/16</sup> x 4 <sup>5/16</sup> x 12 <sup>2/4</sup> in.
WALL HANGING BRACKET	Hidden hanging bracket of directly assembled with great resistance and depth regulations.
HINGE	105° opening, 1 <sup>3/8</sup> in. cap, easy assembly and soft close system.
LEGS	Metallic in bright chrome finish. (optional)
PIPE DEPTH	Pipe depth 2 <sup>1/54</sup> in.

Collection  
Ambra

Model |  
Ambra 120N

Dimensions Metric  
1 inch = 2.54 cm  
1 inch = 25.4 mm

**WS<sup>®</sup>**  
BATH  
COLLECTIONS

1051 Lea Drive - Collegeville, PA 19426  
Tel. 215 513 9400 - Fax 610 831 0215  
[www.ws bathcollections.com](http://www.ws bathcollections.com) - [info@ws bathcollections.com](mailto:info@ws bathcollections.com)

2 Drawers

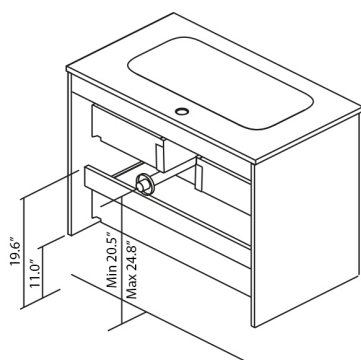

2 Drawers - 1 Door

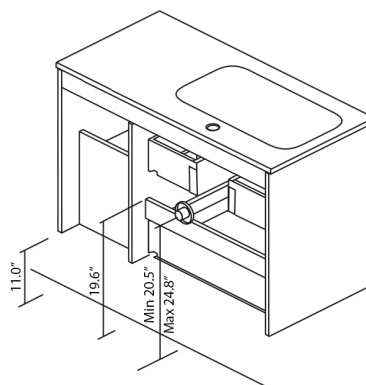

1 Door - 2 Drawers - 1 Door

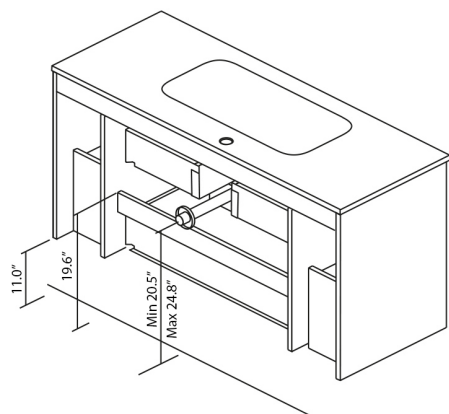

SIDE PANELS	FRONTS	DRAWERS				HANDLE	FINISHES	RANGE	
MDF 16 mm	MDF 16 mm	Partially extraction Hettich	Smoky leather interior	Drawer organis.	Soft close	Integral front handle	Foil 2D / Foil 3D	D-46	Suspended

\* Dimensions indicated in the drawing are based on the level of the whole leg, in case of wall hanging the furniture dimensions. The measures of these schemes are represented in mm.

Collection  
Ambra

Model |  
Ambra

Dimensions Metric  
1 inch = 2.54 cm  
1 inch = 25.4 mm

**WS<sup>®</sup>** BATH  
COLLECTIONS  
1051 Lea Drive - Collegeville, PA 19426  
Tel. 215 513 9400 - Fax 610 831 0215  
[www.ws bathcollections.com](http://www.ws bathcollections.com) - [info@ws bathcollections.com](mailto:info@ws bathcollections.com)

## FURNITURE AND AUXILIARIES

\* Measure in cm.

### FURNITURE

Depth 45

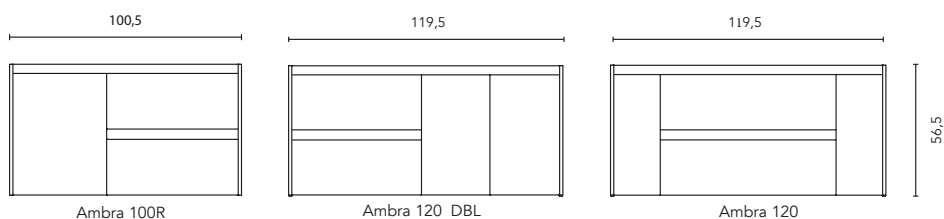

### COLUMN

Depth 24

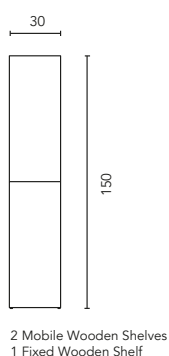

### WALLS

Depth 15

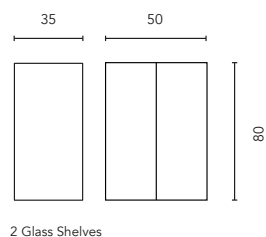

## Finishes:

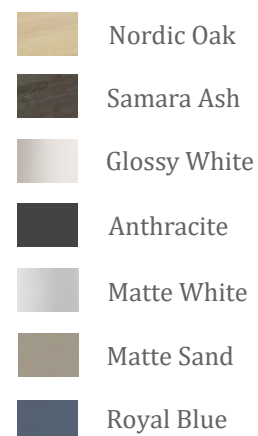

Collection  
Ambra

Model  
Ambra

Dimensions Metric  
1 inch = 2.54 cm  
1 inch = 25.4 mm

**WS<sup>®</sup> BATH COLLECTIONS**  
1051 Lea Drive - Collegeville, PA 19426  
Tel. 215 513 9400 - Fax 610 831 0215  
[www.ws bathcollections.com](http://www.ws bathcollections.com) - [info@ws bathcollections.com](mailto:info@ws bathcollections.com)

# Product Specs Sheets

We recommend the following items that work with your sink.

## TRAPS



WSBC 53922  
*Our best seller*

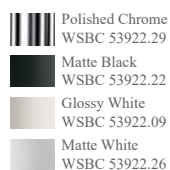

WSBC 5392



WSBC 53925



WSBC 53921  
*Space saving*



## DRAINS



WSBC 00076  
Push waste drain (click clack)  
*without overflow*

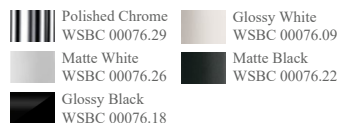

WSBC 53991  
Push waste drain (click clack)  
*with overflow*

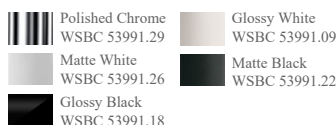

## MOUNTING HARDWARE

### Wall-Mount Installation



Bolts

### Vessel/Countertop Installation



Silicone (optional)

\* WS Bath Collections reserve the right to make revisions without notice to product specifications, dimensions, or information.

<b>Collection  </b> Ambra	<b>Model  </b> Ambra	Dimensions Metric <i>1 inch = 2.54 cm</i> <i>1 inch = 25.4 mm</i>	 1051 Lea Drive - Collegeville, PA 19426 Tel. 215 513 9400 - Fax 610 831 0215 <a href="http://www.ws bathcollections.com">www.ws bathcollections.com</a> - <a href="mailto:info@ws bathcollections.com">info@ws bathcollections.com</a>
------------------------------	-------------------------	-------------------------------------------------------------------------	---------------------------------------------------------------------------------------------------------------------------------------------------------------------------------------------------------------------------------------------------------------------------------------------------------------------------------------