

Camilia AUX45

Features

- Mirrored Medicine Cabinet
- Soft closing door
- Reversible Opening (Can be Installed with a Left or Right Hinge)
- Wall-hung Surface Mount Installation with Hidden Brackets
- Includes Two Glasses Shelves
- Structure made of engineered wood
- Durable Anodized Aluminum Finish
- Made in Spain



SKU# | Options:

- Camilia AUX45 | Mirrored Medicine Cabinet

Codes & Standards:

- CARB2 Compliant and Certified
- TSCA Compliant and Certified

* WS Bath Collections reserves the right to revise dimensions or information on this sheet without notice

Collection |
Camilia

Model |
Camilia AUX45

Dimensions Metric

1 inch = 2.54 cm

1 inch = 25.4 mm

WS®
BATH
COLLECTIONS

1051 Lea Drive - Collegeville, PA 19426
Tel. 215 513 9400 - Fax 610 831 0215

www.ws bathcollections.com - info@ws bathcollectins.com

Camilia AUX45

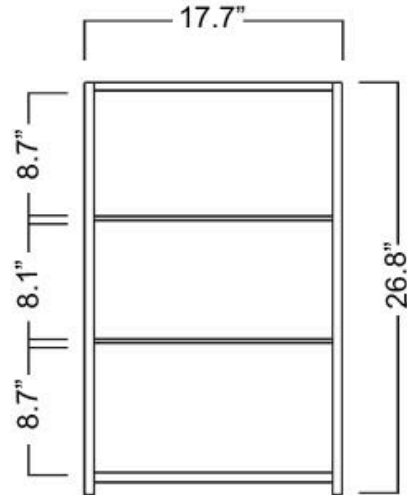
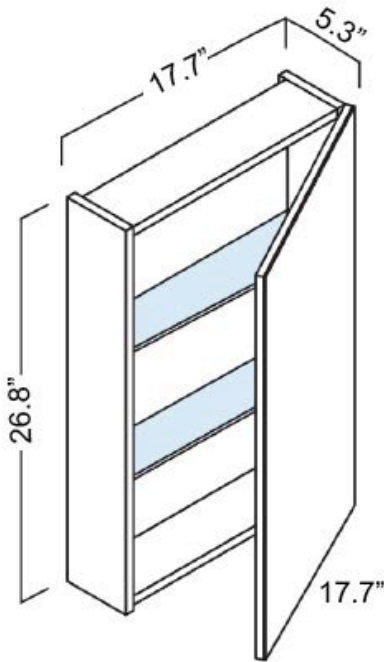

Technical information



Soft close



Glass shelf



Reversible rotating door

Collection |
Camilia

Model |
Camilia AUX45

Dimensions Metric
1 inch = 2.54 cm
1 inch = 25.4 mm



1051 Lea Drive - Collegeville, PA 19426
Tel. 215 513 9400 - Fax 610 831 0215

www.ws bathcollections.com - info@ws bathcollectins.com