

CATALOG NUMBER	TYPE
PROJECT	

TRACK CURRENT LIMITER

SINGLE LIVE END SERIES

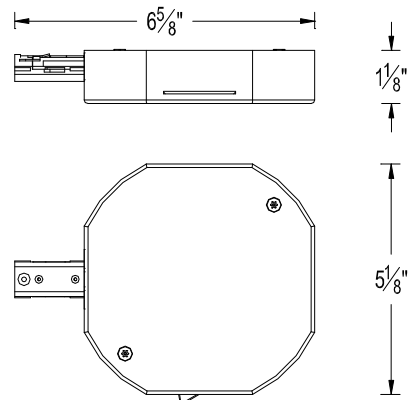

Ordering Matrix

Model	Series	Circuit Qty.	Rating	Finish
<input type="text"/>	<input type="text"/>	<input type="text"/>	<input type="text"/>	<input type="text"/>
THL TLL TJL	HLE LLE JLE	N/A	1A 2A 5A 7A 10A	BK BN DB PT WT
TJL	J2LE	2		

Ordering Example (model –series –circuit Qty. – rating – finish): THL-HLE-10A-BK

Product Details

Description: Track current limiter, single live end. Designed for using WAC H, L, J&J2 series track. In addition it may fit other manufacturer's original track (consult factory for specific brands).

Materials: Galvanized steel mounting plate, mounted a track connector and a circuit breakers. And a plastic cover secure with two pin Torx head screws to the plate.

Systems: **THL-HLE** is designed for WAC H system track (HT).
TJL-JLE is designed for WAC J system track (JT).
TLL-LLE is designed for WAC L system track (LT).
TJL-J2LE is designed for WAC J2 system track (J2T).

Mounting: Mounts directly to a ceiling surface, or a 4" octagonal outlet box. Connects direct to WAC track units. Also suitable for mounting to grid ceiling runners and WAC stem mounted track.

Finish:	THL-HLE	TLL-LLE	TJL-JLE	TJL-J2LE
BK (Black)	•	•	•	•
BN (Brushed Nickel)	•	•	•	
DB (Dark Bronze)	•	•	•	
PT (Platinum)			•	•
WT (White)	•	•	•	•

Listing: UL & CUL Listed. 5 years WAC Lighting product warranty.

Electrical Information

- ? Capacity is 120V, 60Hz rated.
- ? Switch is polarized, and must be installed in accordance with all national and local codes.
- ? Wire terminals for use with 12 or 14 AWG solid copper wires. Use minimum 90° supply wires.
- ? Circuit breaker can limit the amount of electrical load that can be placed on the circuit. Circuit breaker also can be used as standard ON/OFF switch.
- ? Rating:
 - 1A** – 1 Amp
 - 2A** – 2.5 Amp
 - 5A** – 5 Amp
 - 7A** – 7.5 Amp
 - 10A** – 10 Amp
- ? **Short Circuit Current Rating (AIC): 1kA**