

<b>CATALOG NUMBER</b>	<b>TYPE</b>
<b>PROJECT</b>	

## TRACK CURRENT LIMITER

## DOUBLE LIVE END(RIGHT) SERIES

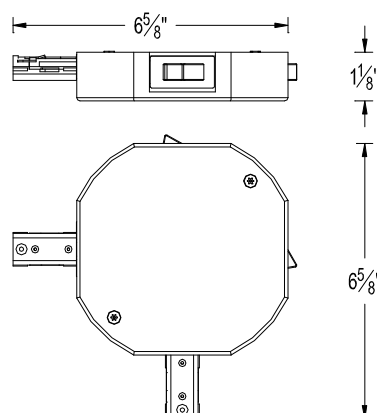

### Ordering Matrix

Model	Series	Circuit Qty.	Rating	Finish
<input type="text"/>	<input type="text"/>	<input type="text"/>	<input type="text"/>	<input type="text"/>
THL TLL TJL	RIGHT	1      2	1A   2A   5A   7A   10A	BK   BN   DB   PT   WT
TJL-J2	RIGHT	2		

Ordering Example (model –series –circuit Qty. – rating – finish): TLL-RIGHT-2-7A-BN

### Product Details

**Description:** Track current limiter, double live end (right). Designed for using WAC H, L, J&J2 series track. In addition it may fit other manufacturer's original track (consult factory for specific brands).

**Materials:** Galvanized steel mounting plate, mounted a track connector and one or two circuit breakers. And a plastic cover secure with two pin Torx head screws to the plate.

**Systems:** **THL-RIGHT** is designed for WAC H system track (HT).  
**TJL-RIGHT** is designed for WAC J system track (JT).  
**TLL-RIGHT** is designed for WAC L system track (LT).  
**TJL-J2-RIGHT** is designed for WAC J2 system track (J2T).

**Mounting:** Mounts directly to a ceiling surface, or a 4" octagonal outlet box. Connects direct to WAC track units.  
Also suitable for mounting to grid ceiling runners and WAC stem mounted track.

Finish:	THL-RIGHT	TLL-RIGHT	TJL-RIGHT	TJL-J2-RIGHT
<b>BK</b> (Black)	•	•	•	•
<b>BN</b> (Brushed Nickel)	•	•	•	
<b>DB</b> (Dark Bronze)	•	•	•	
<b>PT</b> (Platinum)			•	•
<b>WT</b> (White)	•	•	•	•

**Listing:** UL & CUL Listed. 5 years WAC Lighting product warranty.

### Electrical Information

- ? Capacity is 120V, 60Hz rated.
- ? Switch is polarized, and must be installed in accordance with all national and local codes.
- ? Wire terminals for use with 12 or 14 AWG solid copper wires. Use minimum 90° supply wires.
- ? Circuit breaker can limit the amount of electrical load that can be placed on the circuit. Circuit breaker also can be used as standard ON/OFF switch.
- ? Rating:
  - 1A** – 1 Amp
  - 2A** – 2.5 Amp
  - 5A** – 5 Amp
  - 7A** – 7.5 Amp
  - 10A** – 10 Amp
- ? **Short Circuit Current Rating (AIC): 1kA**