

CATALOG NUMBER	TYPE
PROJECT	

5" LINE VOLTAGE DOWNLIGHTS

R-F505-R-A

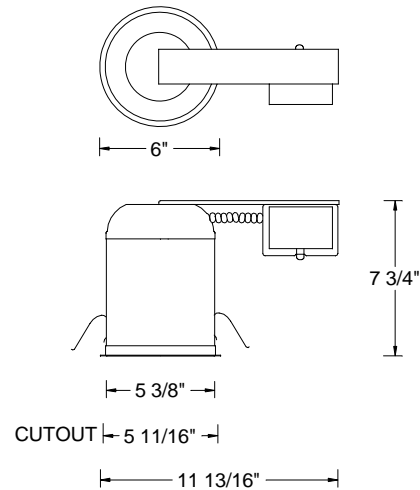

Ordering Matrix		
Model	Installation Type	Options
R-F505: Recessed 5 inch compact fluorescent downlights	R-Remodel Housing N-New construction	A : Air Tight

Product Details	Specification Features
<p>Description: Line voltage remodel housing.</p> <p>Materials: Housing is 20 gauge steel, painted white. Frame, junction box is heavy gauge galvanized steel.</p> <p>Mounting: Clips allow easy removal of housing. Accommodates surface thickness of up to 1". 5 11/16" cutout hole.</p> <p>Ratings: Non-IC rated. Insulation must be kept at least 3" away from the housing.</p> <p>J-Box: Seven knockouts and four Romex® style wiring connectors provided for ease of installation. Rated for branch and chain wiring.</p> <p>Ballast: Rated Lamp Watts: 26W Voltage: 120V Input Current: 0.38A Input Power (ANSI Watts): 26W Minimum 2 years warranty from the manufacturer of the ballast.</p> <p>Lamp: Single compact fluorescent lamp. CFTR26W/GX24q/830, 3000K Lamps are ordered separately.</p> <p>Listing: UL & CUL Listed. Suitable for damp locations.</p>	<ul style="list-style-type: none"> ENERGY STAR qualified. Certified Air Tight per ASTM E283. 5 year W.A.C. Lighting product warranty.

Compatible Trims

R-520 Step baffle

Finish	Baffle	Trim
BK/WT	Black	White
BN	Brushed Nickel	Brushed Nickel
BZ	Bronze	Bronze
WT/WT	White	White

Single 26W compact fluorescent lamp.

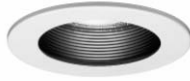

R-521 Open reflector

Finish	Reflector	Trim
CL/WT	Specular Clear	White
BN	Specular Clear	Brushed Nickel
BZ	Specular Clear	Bronze

Single 26W compact fluorescent lamp.



R-540 Scoop wall wash with step baffle

Finish	Baffle	Trim
WT/WT	White	White

Single 26W compact fluorescent lamp.



R-522 Shower Light

Finish	Trim
WT	White

Single 26W compact fluorescent lamp.



Finish Key:

BK-Black, BN-Brushed Nickel, CL-Specular Clear, WT-White, BZ- Bronze

Notes:

The full catalog number for a complete downlight includes the model numbers for both the trim and the housing. More information regarding each individual trim can be viewed on the individual trim spec sheets.