

Model: 763

120V Track Line Voltage Luminaire

WAC LIGHTING

Responsible Lighting®

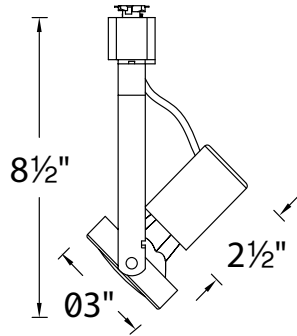

Fixture Type:

Catalog Number:

Project: _____

Location: _____

PRODUCT DESCRIPTION

Line voltage luminaire offered in black, brushed nickel or white finishes and can be used with various lamp options.

FEATURES

- Available with LED lamping option
- 350° horizontal rotation and 90° vertical tilt
- Open-back design for an industrial look
- 5 year WAC product warranty

SPECIFICATIONS

Construction: Formed metal with polycarbonate track adapter. Medium base 250V porcelain socket with nickel-plated copper screw shell.

Finish: Powder coat paint. Available in Black (BK), Brushed Nickel (BN), and White (WT).

Lamp: Order lamps separately. Uses PAR20, 50W max lamp. LED lamp options include LED BR20 or LED PAR20.

Dimming: Dim to 5% with Triac dimmer. LED lamp dims to 10% with electronic low voltage (ELV) dimmer.

Standards: ETL & cETL Listed. UL & CUL Listed.

ORDER NUMBER

System	Model	Lamp	Power	Finish
LTK L Track	763	PAR20	50W max	BK Black
HTK H Track		LED BR20	7.5W	BN Brushed Nickel
JTK J/J2 Track		LED PAR20	10.3W	WT White

- -

Example: HTK-763-BN

FINISHES



LED LAMPS

LED LAMPS		Finish
PAR20LED-10N30	PAR20	BK Black WT White
BR20LED-7N27	BR20	WT White

WAC Lighting
www.waclighting.com
Phone (800) 526.2588 • Fax (800) 526.2585

Headquarters/Eastern Distribution Center
44 Harbor Park Drive • Port Washington, NY 11050
Phone (516) 515.5000 • Fax (516) 515.5050

Western Distribution Center
1750 Archibald Avenue • Ontario, CA 91760
Phone (800) 526.2588 • Fax (800) 526.2585