

# INSTALLATION INSTRUCTION

## COLORSCAPING® CYLINDER WALL MOUNT 12V



3911

### WARNING

IMPORTANT: NEVER attempt to do any work without shutting off the electricity.

1. Read all instructions before installing.
2. System is intended for installation by a qualified electrician in accordance with the National Electrical Code and local regulations.
3. Place the wall switch in the "OFF" position.
4. Go to the main fuse box, or circuit breaker. Unscrew the fuse(s) or switch "OFF" the circuit breaker switch(es) that control the power to the space that you are working on.

### CAUTION

- All parts must be used as indicated in these instructions. Do not substitute any parts, leave parts out, or use any parts that are worn out or broken. Failure to follow this instruction may invalidate the UL/cUL listing of this fixture.

### AVERTISSEMENT

IMPORTANT : Coupez l'électricité avant TOUTE manipulation.

- Lisez toutes les instructions avant d'installer.
- Système est destiné à être installé par un électricien qualifié en conformité avec le code national de l'électricité et les règlements locaux.
- Placez l'interrupteur mural en position d'arrêt (« OFF »).
- Toujours mettre le fusible ou le disjoncteur en position arrêt dans la pièce ou des travaux électriques sont prévus

### MISE EN GARDE

- Toutes les pièces doivent être utilisées tel qu'il est indiqué dans ces instructions. Ne remplacez pas les pièces, n'en laissez pas de côté et ne les utilisez pas si elles sont usées ou brisées. Le non-respect de ces instructions peut annuler l'homologation UL du luminaire.

### ADVERTENCIA

IMPORTANTE: NUNCA intente hacer trabajos sin desconectar el suministro eléctrico.

- Lea y comprenda todas las instrucciones e ilustraciones por completo antes de proceder con el ensamblaje e instalación de esta lámpara.
- Sistema está diseñado para ser instalado por un electricista calificado, de acuerdo con el código eléctrico nacional y las normas locales.
- Coloque el interruptor de la pared en la posición "OFF" (APAGADO).
- Diríjase a la caja de fusibles o a la caja del interruptor de circuito principal en su hogar. Coloque el interruptor de alimentación principal en la posición "OFF" (APAGADO).

### PRECAUCIÓN

- Todas las piezas deben usarse como lo indican estas instrucciones. No reemplace las piezas, no omita piezas durante la instalación ni utilice piezas gastadas o rotas. El incumplimiento de esta indicación podría invalidar la calificación UL/cUL esta lámpara.

*\*Note: WAC Smart Transformer is required to power the fixture. (sold separately)*

**This instruction apply to the model(s) below:**

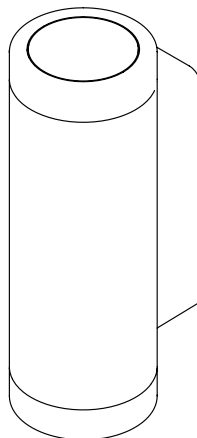

**3911**

waclighting.com	Headquarters, East Manufacturing Facility	South East Manufacturing Facility	Central Manufacturing Facility	West Manufacturing Facility
Phone (800) 526.2588	44 Harbor Park Drive	1600 Distribution Ct	1700 South J Elmer Freeway, Ste 100	1750 S Archibald Ave
Fax (800) 526.2585	Port Washington, NY 11050	Lithia Springs, GA 30122	Cedar Hill, TX 75104	Ontario, CA 91761

INSTALLATION INSTRUCTION  
**COLORSCAPING® CYLINDER WALL MOUNT 12V**  
 3911



**Outdoor Rated Wire Nut**  
Qty: 2pcs

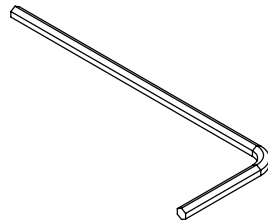

**Hex Key**  
Qty: 1pc

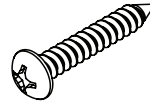

**Mounting Screw**  
Qty: 2pc

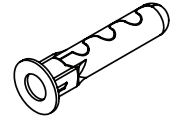

**Mounting Screw Insert**  
Qty: 2pc

**Step 1: Determining the location**

1. Make sure your main power is off.
2. At the point of installation, mount the wall mount bracket by using the two mounting screws.
3. Hang the fixture onto the wall mount bracket by using the notch.
4. Use the hex key to tighten the set screw inside the fixture to secure the fixture on the wall mount bracket.

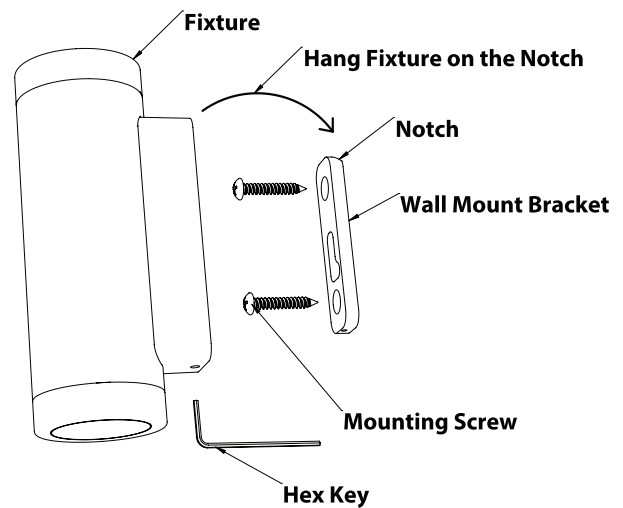

**Step 2: Wiring the Fixture**

- \*Note:** WAC smart transformer is required to power the fixture.  
(Sold Separately)
5. Cut the power supply wire from the transformer at the location of the fixture.
  6. Separate the power supply wire into two individual wires by lightly pulling on each side so that a couple inches are separated.
  7. Strip off ½ inch of the insulating material from each wire and connect one to each of the wires from the fixture using the outdoor rated direct burial wire nuts provided.

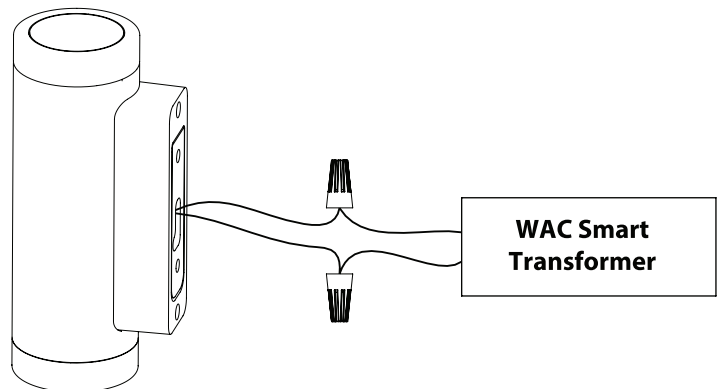

**Note:**  
To install multiple fixtures, also connect the power supply wire of each additional fixture to the connection

Create your **COLORSCAPES™** with **COLORSCAPING®**.

wacighting.com Phone (800) 526.2588 Fax (800) 526.2585	<b>Headquarters, East Manufacturing Facility</b> 44 Harbor Park Drive Port Washington, NY 11050	<b>South East Manufacturing Facility</b> 1600 Distribution Ct Lithia Springs, GA 30122	<b>Central Manufacturing Facility</b> 1700 South J Elmer Freeway, Ste 100 Cedar Hill, TX 75104	<b>West Manufacturing Facility</b> 1750 S Archibald Ave Ontario, CA 91761
--	---	--	--	---