

SAFETY INSTRUCTION

IMPORTANT: NEVER attempt any work without shutting off the electricity.

- Always turn off power at fuse box prior to installation to prevent electrical shock.
- Intended for indoor use. Dry and damp locations.
- For installation and serviced by a qualified, licensed electrician.
- Install in accordance with national electric code, and local regulations.
- Consult with local inspector to assure compliance.
- Do not submerge, or install within 5 feet of a swimming pool.
- Only install with a WAC UL listed Class 2 24VDC LED power supply.
- Do not connect the tape directly to high voltage power
- Do not exceed maximum run recommended for each tape series
- Do not connect the tape with 24VAC output Electronics transformer.

CAUTION

- Read all instructions before installing.
- Handle product with care.
- Do not modify or disassemble product beyond instructions or warranty will be void.
- Cutting anywhere other than the cut point will result in a damage to the tape light
- Failure to follow safety warnings, and installation instruction will void the warranty
- Tape light will begin to flash if maximum rated output power from WAC 24VDC power supply is overloaded.



Avoid contact with sharp objects



Install on stable clean, dry surface

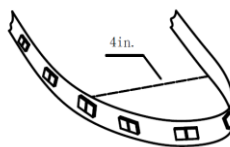

Do not bend the tape light to a diameter less than 4 inches

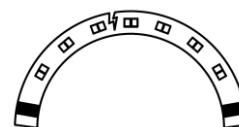

Do not bend the tape light on a horizontal plane

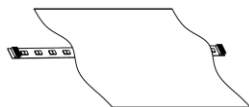

Do not cover LED tape light with any materials



Do not fold or twist LED Tape

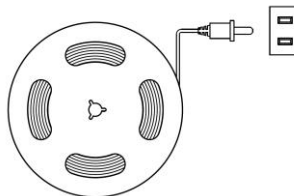

Do not power the LED tape while attached to the spool or tightly coiled

TROUBLESHOOTING

- If LED is damaged due to bending, folding, twisting or any sharp object, that LED section may not light up. Removing that LED section out by cutting and reconnecting using 24VDC Basics Inline Tape to Tape Connector (T24-BS-MM-CL) – Making sure that voltage polarity connection is match between tapes.

WIRING AND INSTALLATION:

1. Turn Power off at circuit breaker

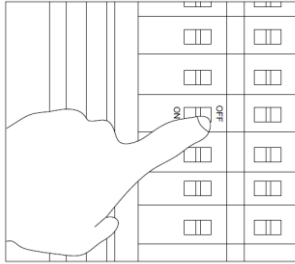

2. Mounting Enclosed 24VDC class 2 output remote power supply at desired location. Measured a distance between power supply to the beginning of the tape run and make sure that it is under 40ft. The allowed maximum distance of wires between the output of power supply to the beginning of tape is 40 ft. The minimum output gauge wire of power supply is 20 AWG.

2.1) Power Supply: PS-24DC-U60R-SP, PS-24DC-U96R-SP, PS-24DC-U288R-SP

This power supply provides a 6 inches output leads wires. To extend the cable length between hard wire power supply or a wiring box to a tape sections, 24VDC Basics Extension Cable (T24-BS-EX2) is needed. The extension cable package also provides small screw driver to unscrew the connector.

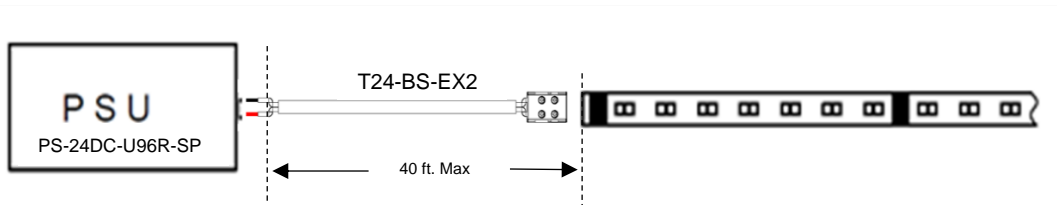

Wire Color		
Power Supply Output	T24-BS-EX2 Cable	Tape marking
RED	RED	+24VDC
BLACK	BLACK	-

24VDC Basics Extension Cable (T24-BS-EX2) and Low Voltage Wiring Box (LED-T-B) can be used to join between wires.

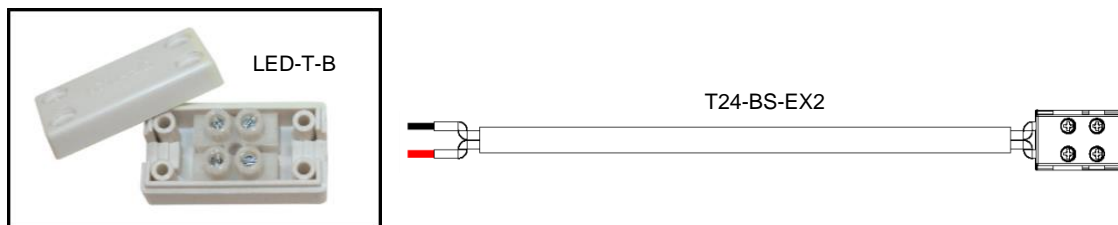

2.2) Power Supply: EN-BT60-24, EN-BT96-24

This power supply provides a 6 foot output leads wires. To extend the cable length between hard wire power supply or a wiring box to a tape sections (if needed), 24VDC Basics Extension Cable (T24-BS-EX2) and Low Voltage Wiring Box (LED-T-B) can be used to join between wires.

The maximum distance between power supply to the beginning of the tape is 40ft.

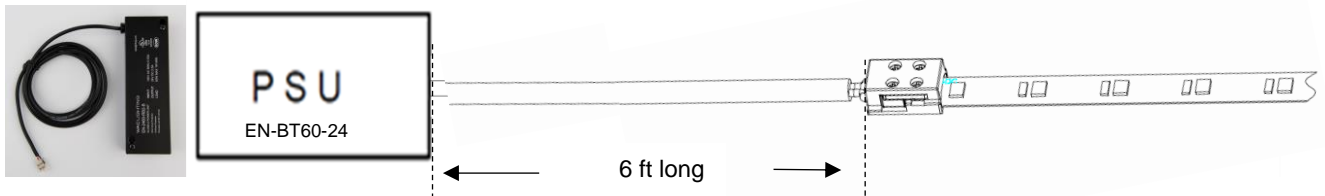

3. Measure the desired length of tape light and round it off to the nearest 4-inch interval. Determine necessary quantities of other accessories and power supply need for each run. Do not exceed maximum run recommended for each tape series

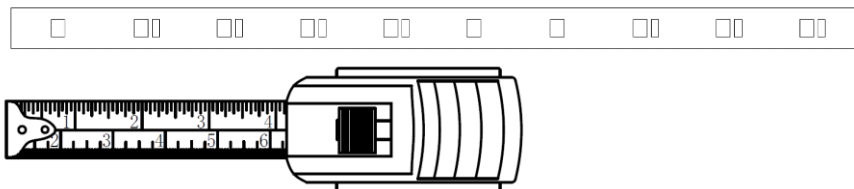

4. If necessary, cut tape light to desired length at line indicated with scissors icon. The tape allows for a cut every 4-inch interval.
5. Mount Tape Light: Clean surface before mounting. Peel off 3M adhesive backing cover off as strip is installed, pressing firmly to mounting surface in increments.

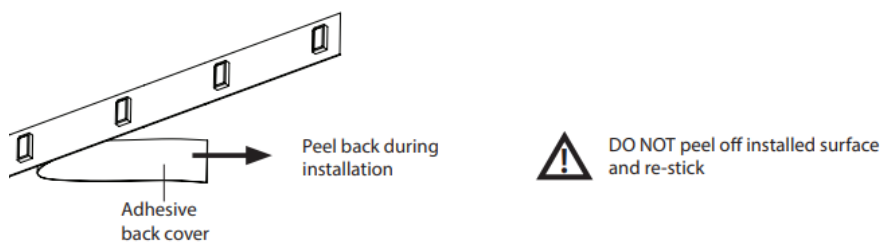

6. Joining between tapes:

Joining tape together (If needed), the following accessories can be used to join between tapes section depending on your application:

24VDC Basics Inline Tape to Tape Connector (T24-BS-MM-CL) – Making sure that voltage polarity connection is match between tapes.

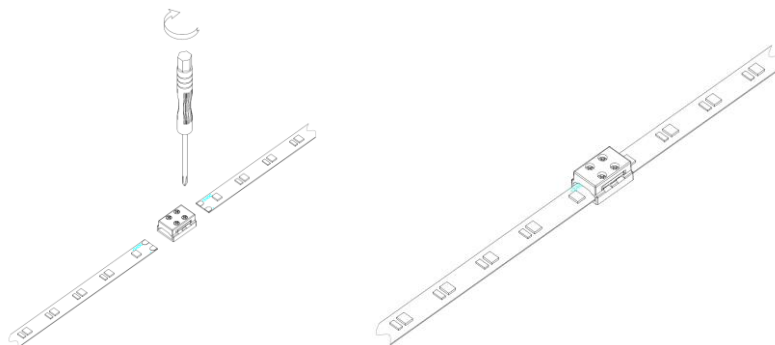

24VDC Basics Joiner Cable (T24-BS-IC) can be used to join between tape sections – the wire insulation jacket shall be stripped. Making sure that voltage polarity connection is match between tapes.

Wire Color		
Power Supply Output	T24-BS-IC Cable	Tape marking
RED	RED	+24VDC
BLACK	BLACK	-

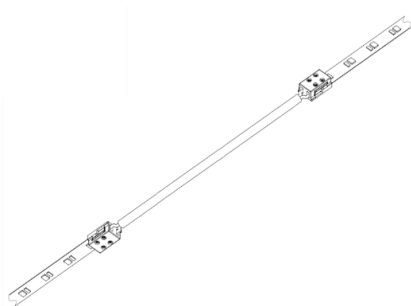

24VDC Basics Flex Y Connector (T24-BS-Y-WT, T24-BS-Y-BK) – the wire insulation jacket shall be stripped

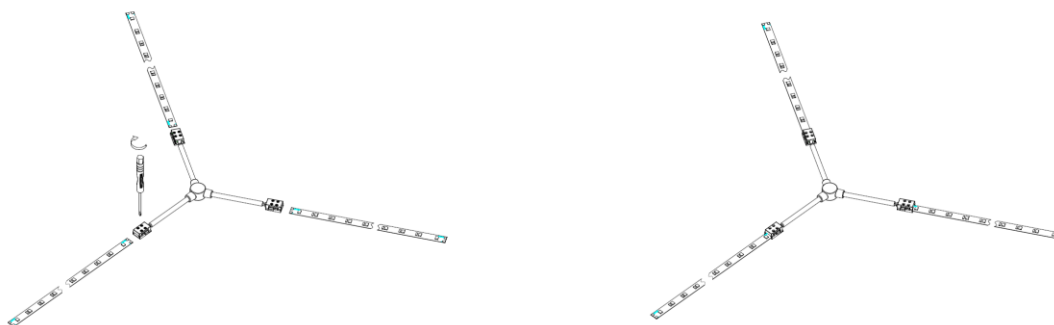

24VDC Basics Flex X Connector (T24-BS-X-WT, T24-BS-X-BK) – the wire insulation jacket shall be stripped

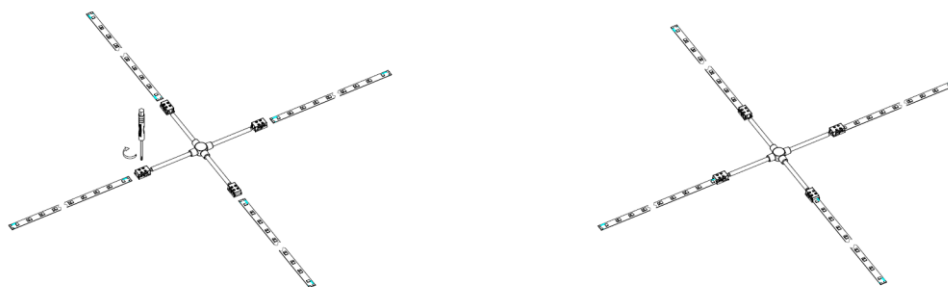

24VDC Basics Flex X & Y Connector can be used for power feeding by using low voltage wiring box (LED-T-B). Making sure that polarity is correct.

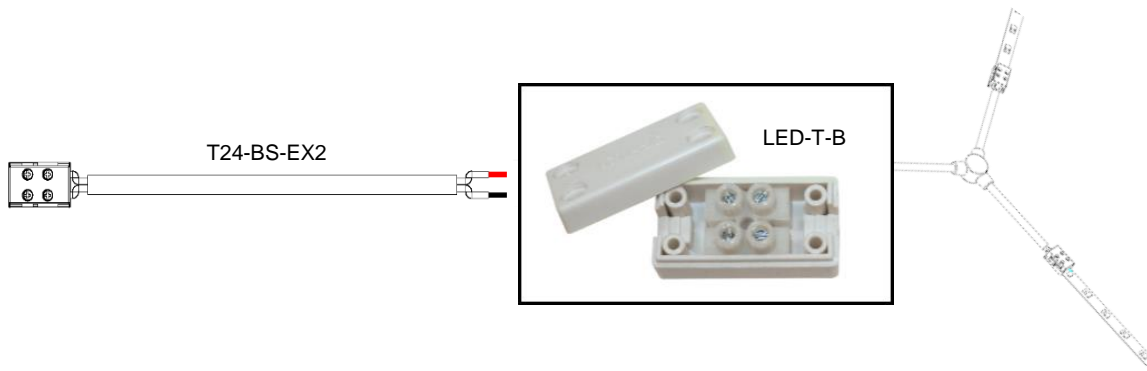

7. Connect electrical power feed wires to 24VDC Basics Inline Power to Tape Connector (T24-BS-PM-CL) with tape. Making sure that polarity is correct. The wire insulation jacket shall be stripped.

Wire Color		
Power Supply Output	T24-BS-PM-CL Cable	Tape marking
RED	RED	+24VDC
BLACK	BLACK	-

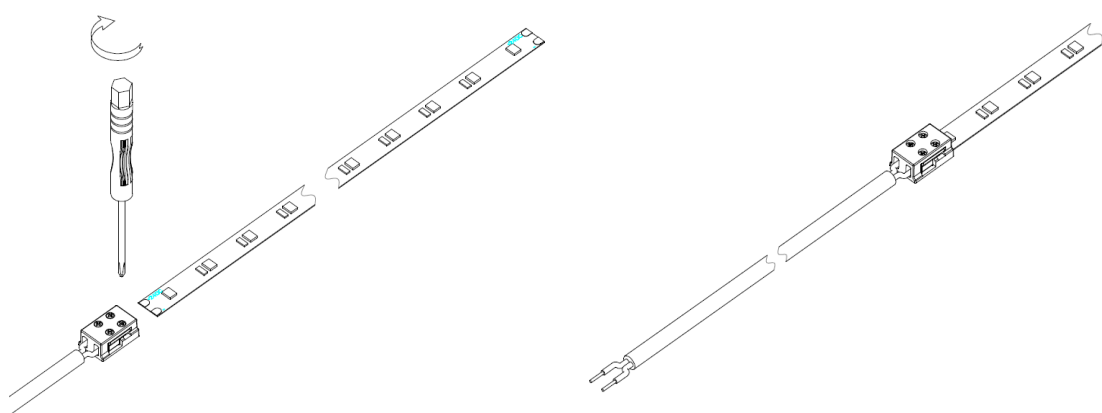

Hard Wire:

- Enclosed 24VDC class 2 output remote power supply must be installed away from any heat sources and it must be accessible for service.
- Enclosed 24VDC class 2 output remote power supply is UL listed.
- The power supply box has a separate line voltage, and low voltage wiring compartments.
- Trade size knock out are provided on both compartments. Connect building wires to the same color power supply wires with wire nuts or UL certified electrical connector.
- Building ground wire may be green or uninsulated, and attaches to green wire from power supply box.
- Additional power feeds and wiring components are available.

Portable:

- 24VDC class 2 output plug-in power supply plugs into standard 120VAC volts 2 prong grounded outlet.
- Power Supply must be installed away from the heat sources.

SYSTEM DIAGRAM:

ON/OFF Switch System

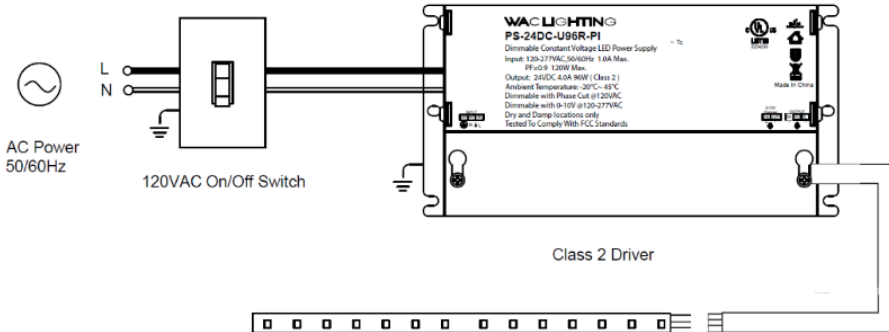

TRIAC/ ELV Dimmer Control System

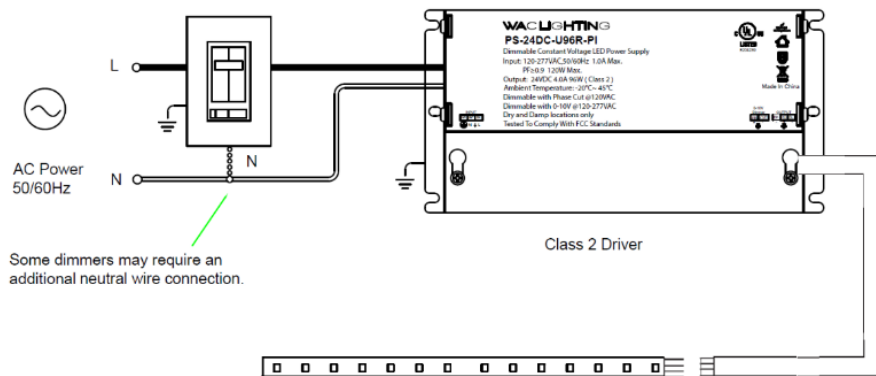

0-10V Dimmer Control System

