

# 2" INGROUND - CIRCLE STEP LIGHT

2041

# WAC

## LANDSCAPE LIGHTING

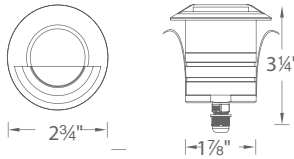

Fixture Type:

Catalog Number:

Project: \_\_\_\_\_

Location: \_\_\_\_\_

### PRODUCT DESCRIPTION

Landscape 2" recessed luminaire for step and wall light applications.

### FEATURES

- IP68 rated, Suitable for continuous immersion under water
- Factory sealed water tight fixtures
- Solid stainless steel construction
- Stainless steel spring clip allows wall or step light applications
- Spring clip, 6' lead wire and direct burial gel filled wire nuts included
- Maintains constant lumen output against voltage drop
- UL 1838 Listed

### SPECIFICATIONS

**Input:** 9 - 15VAC  
**Power:** 4.1W / 6.6VA  
**Brightness:** 50 lm  
**CRI:** 85  
**Rated Life:** 70,000 hours

### ORDERING NUMBER

	Color Temp	Finish
<b>2041</b> <i>Circle Step</i>	<b>30</b> 3000K	<b>BS</b> <i>Bronzed Stainless Steel</i> <b>SS</b> <i>Stainless Steel</i>

**2041-30** \_\_\_\_\_

Example: **2041-30SS**

waclighting.com  
Phone (800) 526.2588  
Fax (800) 526.2585

Headquarters/Eastern Distribution Center  
44 Harbor Park Drive  
Port Washington, NY 11050

Central Distribution Center  
1600 Distribution Ct  
Lithia Springs, GA 30122

Western Distribution Center  
1750 Archibald Avenue  
Ontario, CA 91760

# 2" INGROUND - SQUARE STEP LIGHT

2061

# WAC

## LANDSCAPE LIGHTING

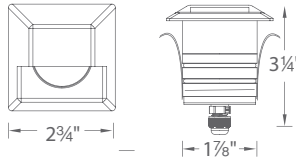
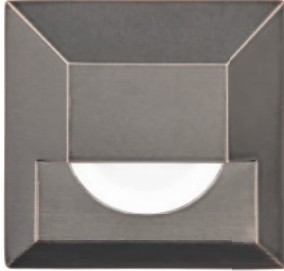

Fixture Type:

Catalog Number:

Project: \_\_\_\_\_

Location: \_\_\_\_\_

### PRODUCT DESCRIPTION

Landscape 2" recessed luminaire for step and wall light applications.

### FEATURES

- IP68 rated, Suitable for continuous immersion under water
- Factory sealed water tight fixtures
- Solid stainless steel construction
- Stainless steel spring clip allows wall or step light applications
- Spring clip, 6' lead wire and direct burial gel filled wire nuts included
- Maintains constant lumen output against voltage drop
- UL 1838 Listed

### SPECIFICATIONS

**Input:** 9 - 15VAC  
**Power:** 4.1W / 6.6VA  
**Brightness:** 50 lm  
**CRI:** 85  
**Rated Life:** 70,000 hours

### ORDERING NUMBER

		Color Temp	Finish
<b>2061</b>	<i>Square Step</i>	<b>30</b> 3000K	<b>BS</b> <i>Bronzed Stainless Steel</i> <b>SS</b> <i>Stainless Steel</i>

**2061-30** \_\_\_\_\_

Example: **2061-30SS**

waclighting.com  
Phone (800) 526.2588  
Fax (800) 526.2585

Headquarters/Eastern Distribution Center  
44 Harbor Park Drive  
Port Washington, NY 11050

Central Distribution Center  
1600 Distribution Ct  
Lithia Springs, GA 30122

Western Distribution Center  
1750 Archibald Avenue  
Ontario, CA 91760

# RECTANGLE STEP LIGHTS 12V

4011

# WAC

## LANDSCAPE LIGHTING

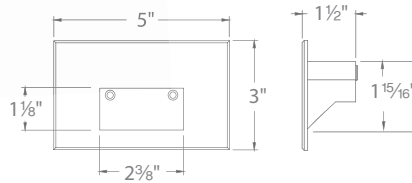
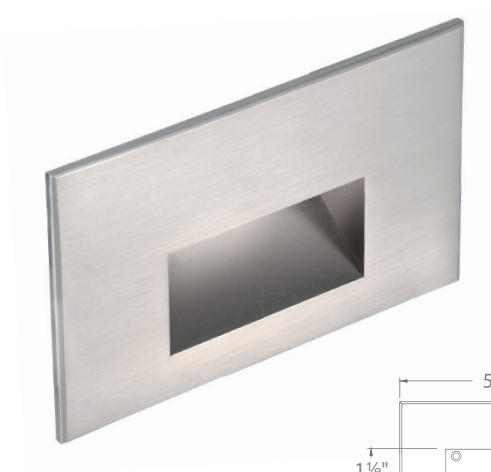

Fixture Type:

Catalog Number:

Project: \_\_\_\_\_

Location: \_\_\_\_\_

### PRODUCT DESCRIPTION

Flexible tape light with UV stabilized silicone seals that protect against water and dusts.

### FEATURES

- Solid diecast brass, corrosion resistant aluminum alloy, or cast stainless steel construction
- IP66 rated, Protected against high-pressure water jets
- Conveniently adapts into existing 12V system
- Invisible hardware
- Maintains constant lumen output against voltage drop
- UL 1838 Listed

### SPECIFICATIONS

**Input:** 9-15VAC constant output  
**Power:** 2W / 3.1VA  
**Brightness:** Up to 58 lm  
**CRI:** 90  
**Rated Life:** 60,000 hours

### FEATURES

- IP66 rated, Protected against powerful water jets
- Translucent lens provides for uniform diffused light output
- Solid diecast brass or corrosion resistant aluminum alloy
- ADA compliant
- Maintains constant lumen output against voltage drop
- UL 1838 Listed

### ORDERING NUMBER

		Color Temp	Finish
4011	12V	27 2700K	<b>BBR</b> Bronze on Brass
			<b>BZ</b> Bronze on Aluminum
			<b>WT</b> White on Aluminum
	30 AM	3000K Amber	<b>BBR</b> Bronze on Brass
			<b>BZ</b> Bronze on Aluminum
			<b>WT</b> White on Aluminum
			<b>SS</b> Cast Stainless Steel

4011-\_\_\_\_\_

Example: 4011-30BK

wacighting.com  
 Phone (800) 526.2588  
 Fax (800) 526.2585

Headquarters/Eastern Distribution Center  
 44 Harbor Park Drive  
 Port Washington, NY 11050

Central Distribution Center  
 1600 Distribution Ct  
 Lithia Springs, GA 30122

Western Distribution Center  
 1750 Archibald Avenue  
 Ontario, CA 91760