

# VON DUPRIN®

## INSTALLATION INSTRUCTIONS

1. Prepare door for exit device. See exit device instructions for locations of holes, backset (line X-X), and center lines.
2. Prepare door for control:
  - A. Transfer line X-X from inside (exit device side) of door to outside (control side) of door. Use extra care if edge of door is beveled. Be sure line X-X is parallel to edge of door.
  - B. Locate and prepare holes (see other side).
3. Prepare control:
  - A. If necessary, change handing. For E360-T, **move mounting studs only** to change handing (see Step No. 4 of "TO CHANGE HANDING OF LEVER").
  - B. If necessary, adjust tailpiece length.
4. Wire control (see "ELECTRICAL WIRING" below).
 

**Note:** Fail Secure (FSE) control should be unlocked when electrified and locked when non-electrified. Fail Safe (FS) control should be locked when electrified and unlocked when non-electrified.
5. Install exit device and control.

## ELECTRICAL WIRING

- Input is 24 VDC.
- Wires on trim are non-polarized.
- Use 18 AWG wire minimum.

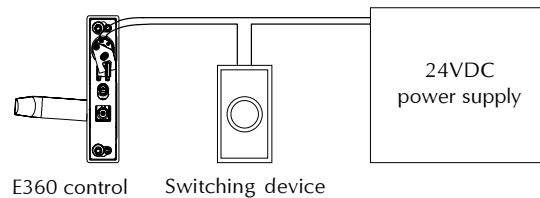

## TO CHANGE HANDING OF LEVER

1. Remove parts in this order:
  - solenoid actuator
  - mounting studs
  - back plate
  - slider
  - retaining ring (use retaining ring pliers)
  - wave spring washer
  - cam

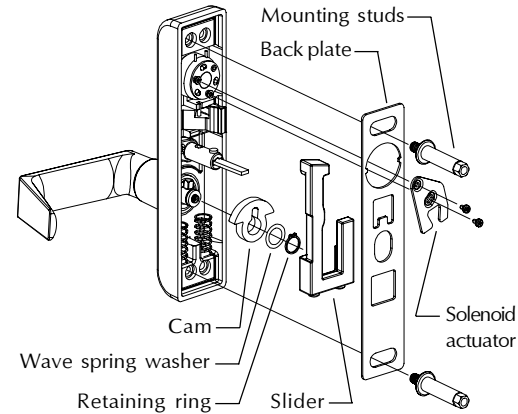

2. Loosen set screw, remove shear pin, rotate lever for desired handing, install shear pin, tighten set screw.

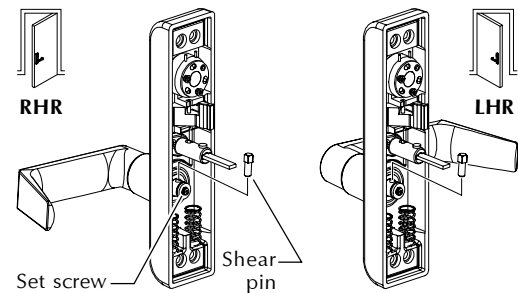

3. Install cam with R facing out for RHR or L facing out for LHR.

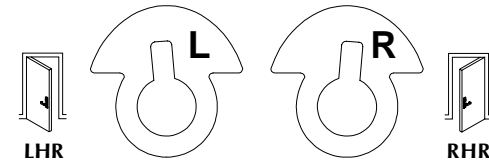

4. Install remaining parts in this order:
  - wave spring washer
  - retaining ring (use retaining ring pliers)
  - slider
  - back plate
  - mounting studs
  - solenoid actuator

Mounting studs go in holes that are on same side of control that lever points to.

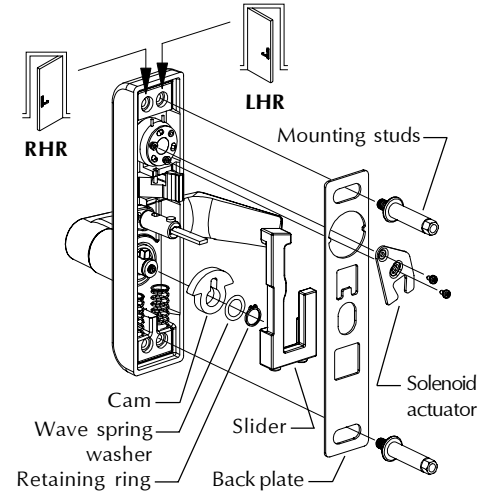

## TO INSTALL SOLENOID KIT

Use solenoid kit to replace solenoid or change fail safe (FS) or fail secure (FSE) function of trim. Remove solenoid as shown and replace with new solenoid.

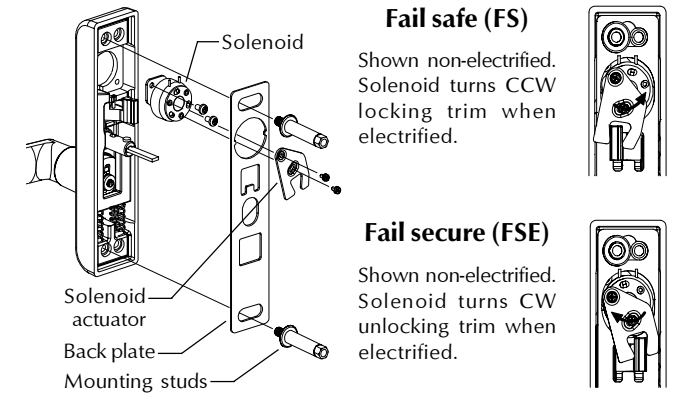

### Fail safe (FS)

Shown non-electrified. Solenoid turns CCW locking trim when electrified.

### Fail secure (FSE)

Shown non-electrified. Solenoid turns CW unlocking trim when electrified.

**Note:** Check locking and unlocking function after installing solenoid. Adjust solenoid actuator position as needed.

## TO ADJUST TAILPIECE LENGTH

Make sure tailpiece is installed at correct length for 1-3/4" thick or 2-1/4" thick door. If necessary, remove pine tree clip, adjust tailpiece, install pine tree clip.

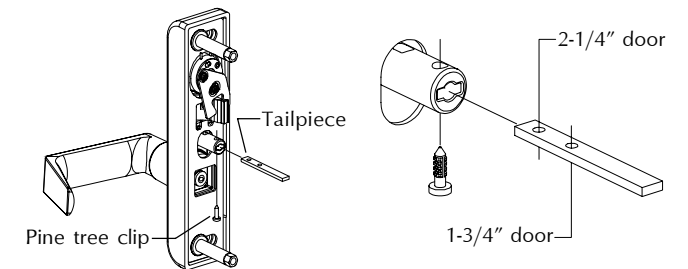

**IR Security & Safety**  
Proven Source. Proven Solutions.™

**E360-L/T CONTROLS FS/FSE**

Copyright © 2004 Ingersoll-Rand.  
All rights reserved.

PAGE NO.  
**1 of 2**

REVISION  
**0**

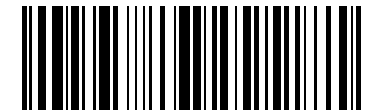

**941133-00**

# VON DUPRIN®

## DOOR PREPARATION, METAL DOOR APPLICATION

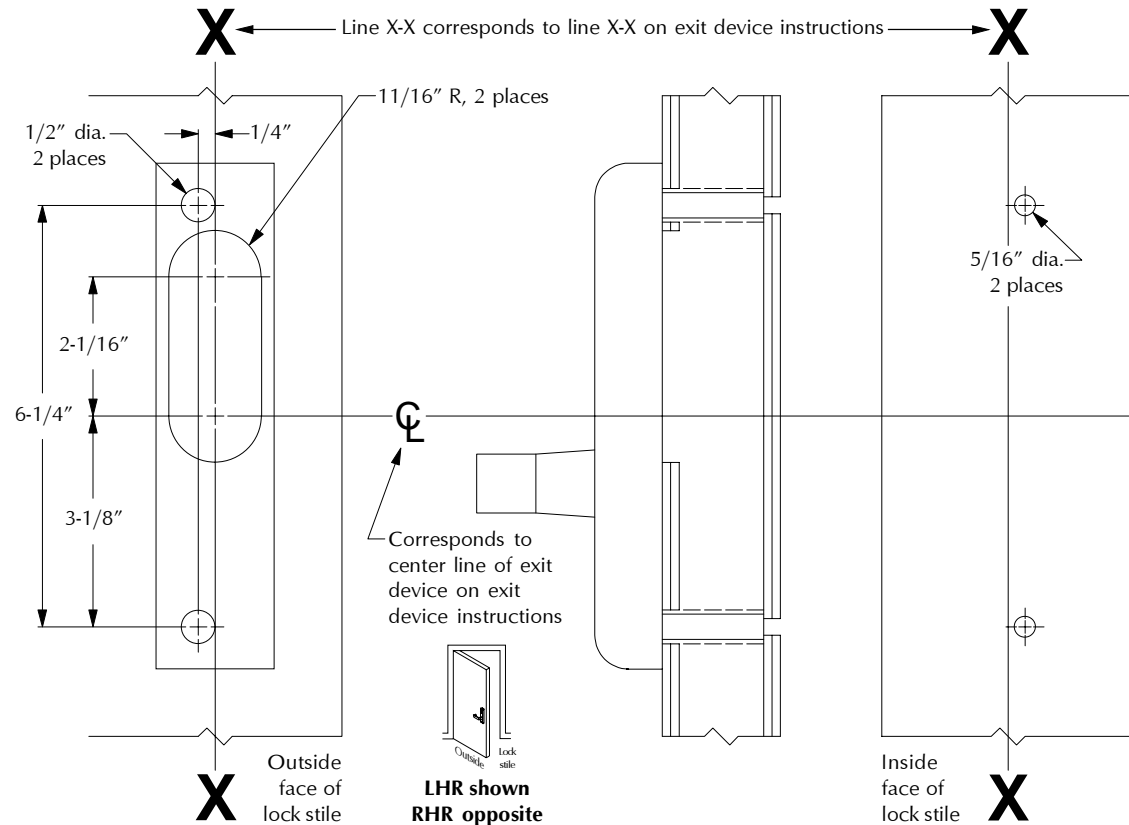

## DOOR PREPARATION, WOOD DOOR APPLICATION

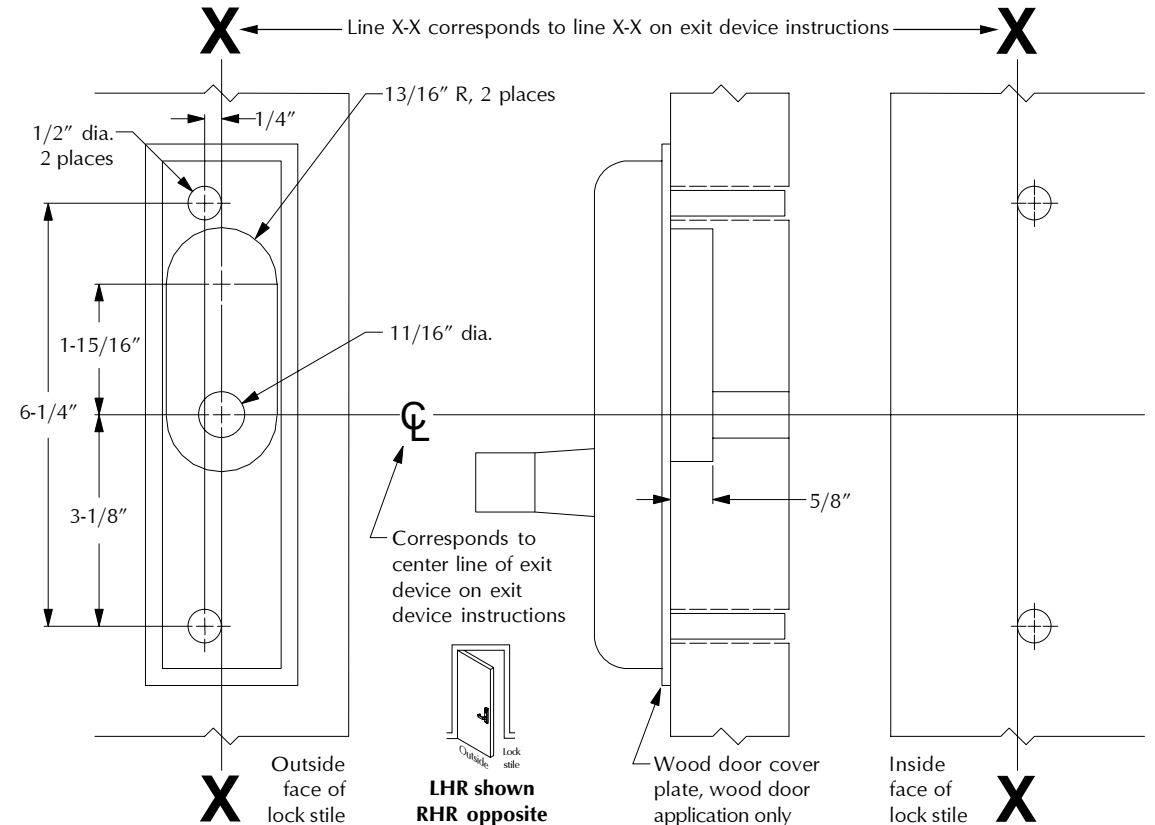

For cutouts on inside face of door, see device instructions

Device Application Schedule
33A/35A Rim Device
3327A/3527A Vertical Rod Device
3347A/3547A Vertical Rod Device
3348A/3548A Vertical Rod Device
3327A-F/3527A-F Vertical Rod Device
3347A-F/3547A-F Vertical Rod Device
3348A-F/3548A-F Vertical Rod Device

**IR** Security & Safety  
Proven Source. Proven Solutions.™

**E360-L/T CONTROLS FS/FSE**

Copyright © 2004 Ingersoll-Rand.  
All rights reserved.

PAGE NO.  
**2 of 2**

REVISION  
**0**

**941133-00**