

VON DUPRIN®

Installation Instructions

22 Series ALK Alarm Kit

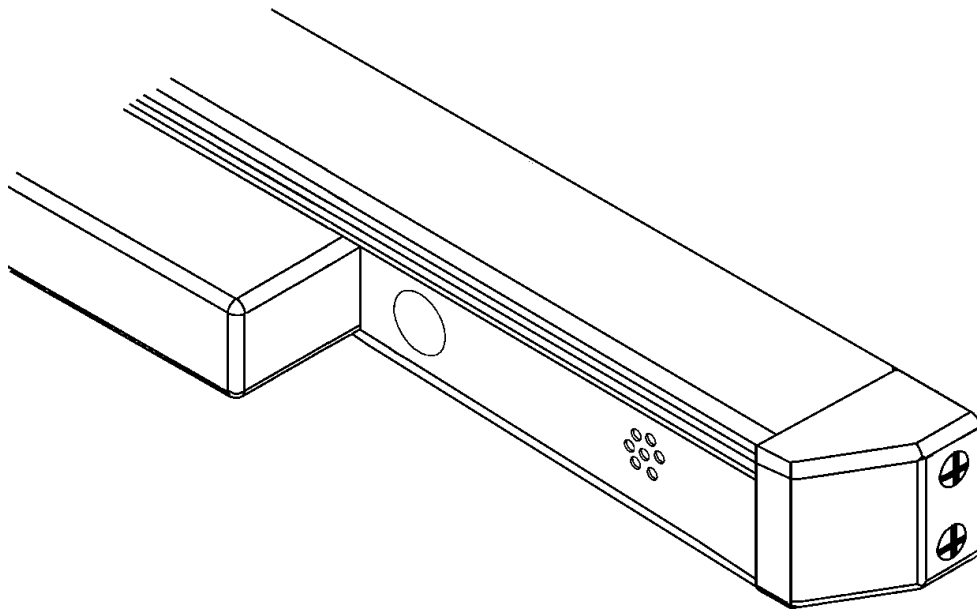

Index:

• General Information	2
• Parts List	2
• Installation	3
• Operating Instructions	6
• Changing the Battery	7
• EI (External Inhibit) Wiring	8

GENERAL INFORMATION

These instructions are presented in step-by-step sequence.

Review this page carefully. It will help identify the hardware and define the terminology used throughout.

PARTS LIST

Note: The ALK Alarm Kit requires an RX or LX switch mounted in the exit device.

This kit includes the following parts (shown below):

- ALK Unit
- Emergency Exit Sign
- Cylinder Collar
- Bearing Strip
- 9 Volt Battery

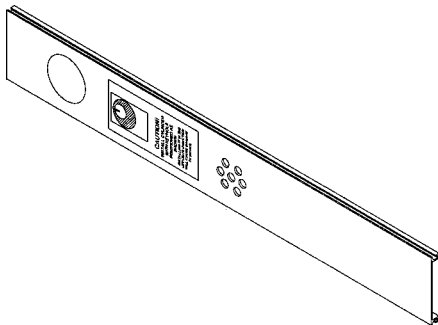

ALK Unit
(faceplate shown)

A rectangular sign with a black border and white background. The text "EMERGENCY EXIT ONLY" is on the top line and "ALARM WILL SOUND" is on the bottom line, both in bold, black, uppercase letters.

EMERGENCY EXIT ONLY
ALARM WILL SOUND

Emergency Exit Sign
(packed in cardboard tube)



Cylinder
Collar

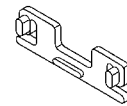

Bearing
Strip

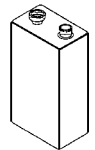

9 Volt
Battery

INSTALLATION

1 Assemble the ALK unit with the parts in order as shown below, **A** through **F**.

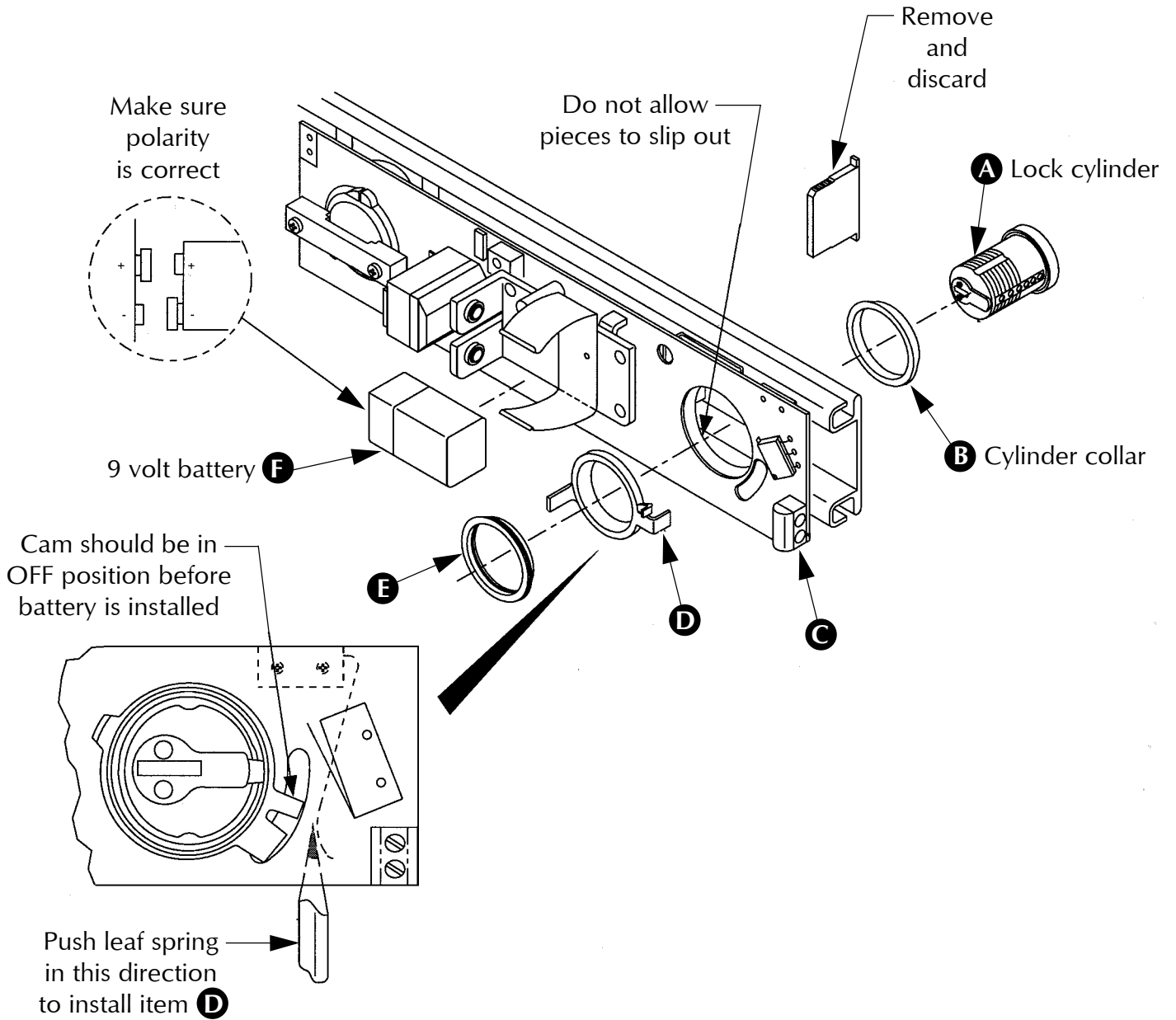

2 Cut the device and/or cover plate (end opposite cylinder hole) to proper length.

Note: See device installation instructions for additional information.

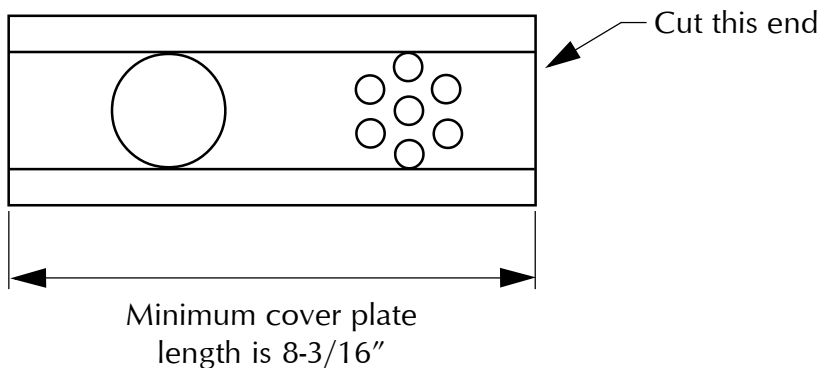

3 If exit device does not have LX or RX switch in it, install switch before proceeding.

Note: Refer to the appropriate RX or LX installation instructions.

4 Remove the exit device end cap and dogging cover.

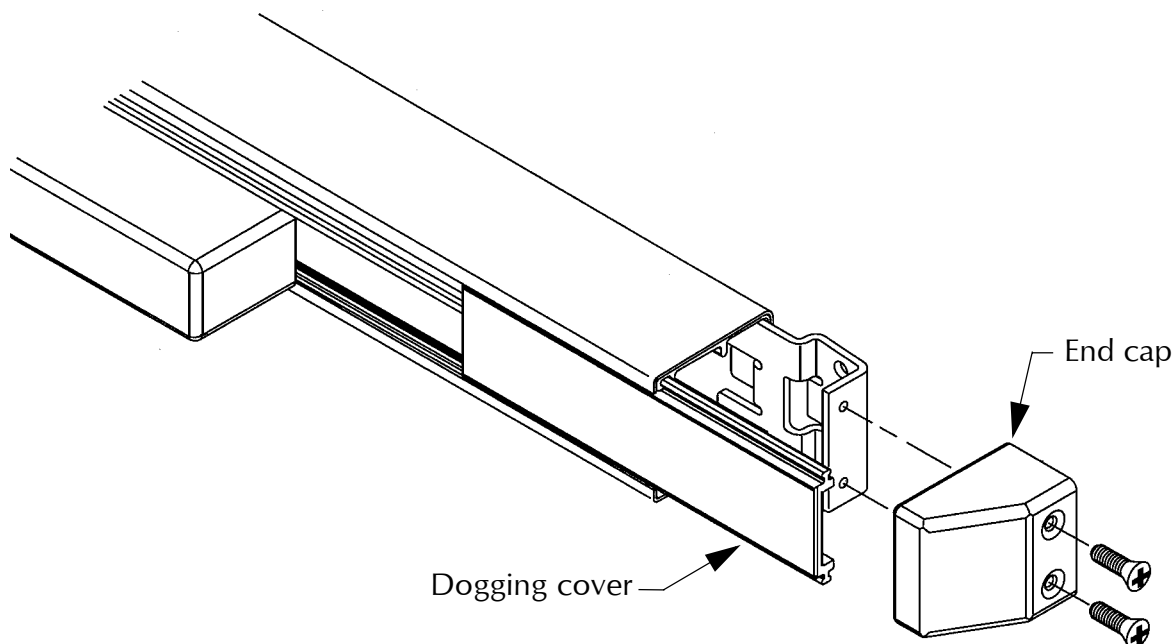

5 Attach switch wires to terminal block on ALK board as shown.

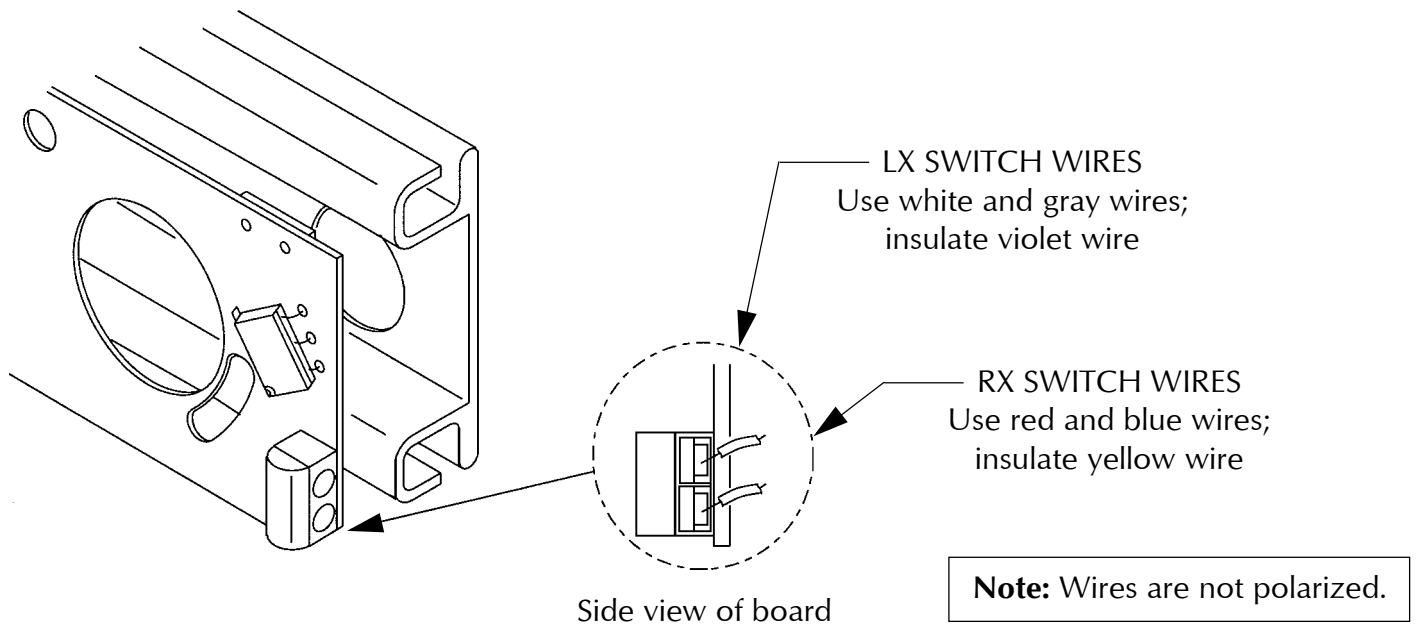

6 Remove dogging shaft if present, install bearing strip, and slide ALK unit into device.

Note: Make sure that the wires do not tangle with moving parts by carefully pulling them toward the dogging end of device while sliding in the ALK unit.

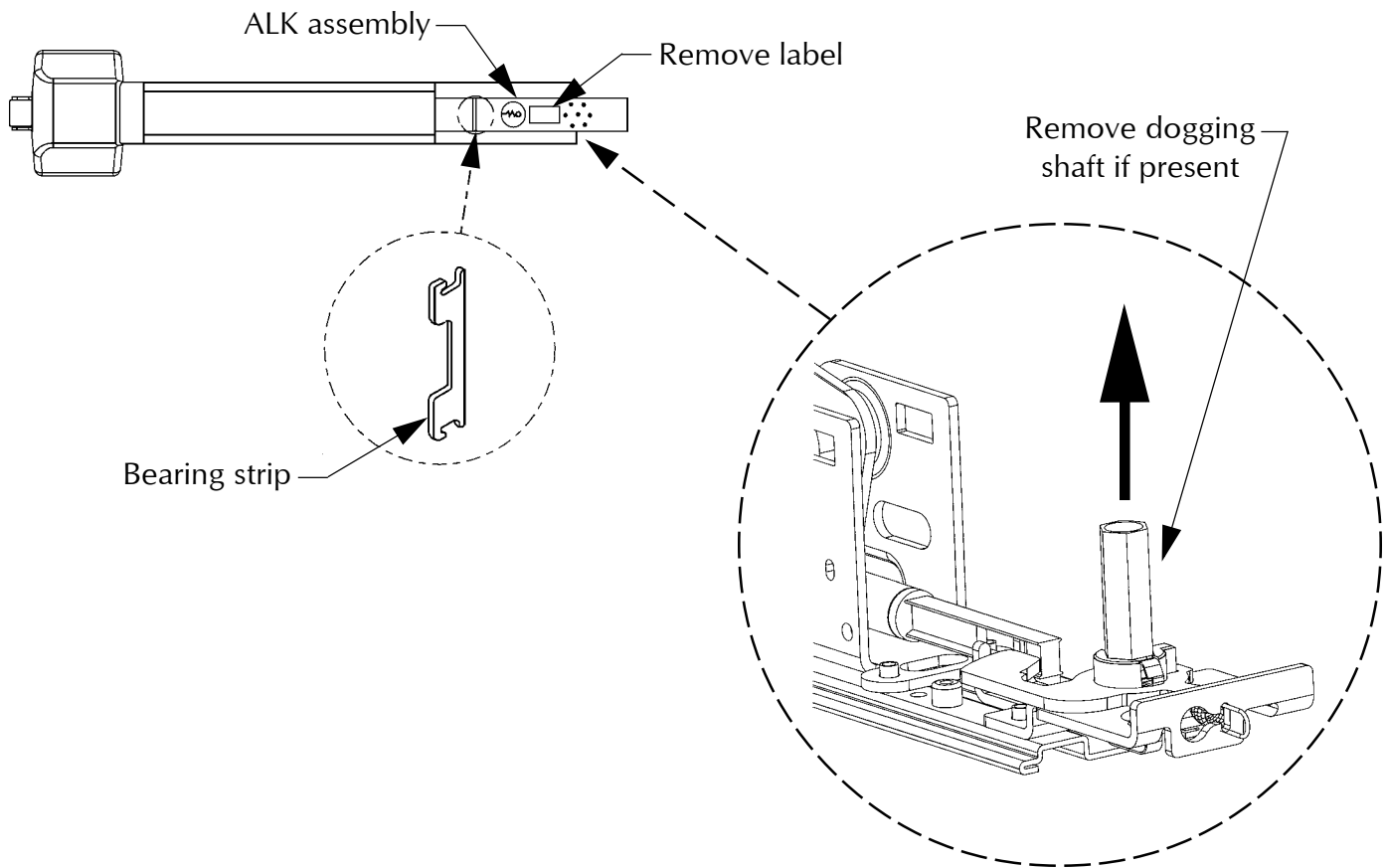

7 Install device to door.

8 Mount sign by peeling off protective backing and sticking sign into place.

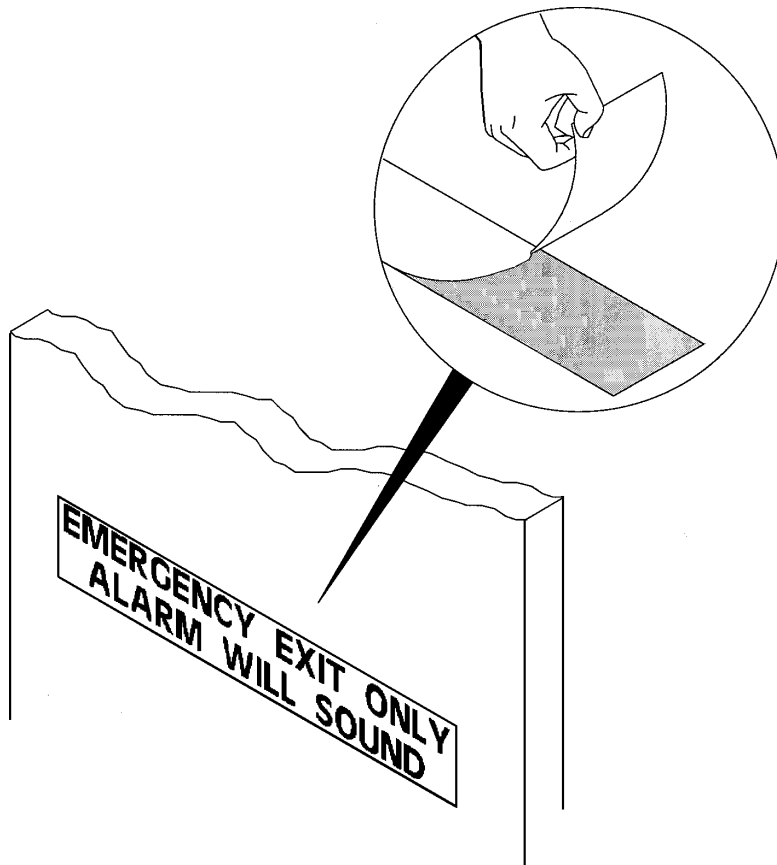

OPERATING INSTRUCTIONS

1. Insert the key into the cylinder and arm the unit by turning the key clockwise to position **B** until it stops. Return key to position **A** to remove. **The unit will arm in 15 to 20 seconds.**
2. Depress the pushbar after 20 seconds; the alarm should sound immediately.
3. Turn the key counterclockwise to position **C** to disarm.

Note: After the ALK alarm is on for approximately 6 minutes, it will begin to turn itself off and on every 10 seconds to conserve battery life.

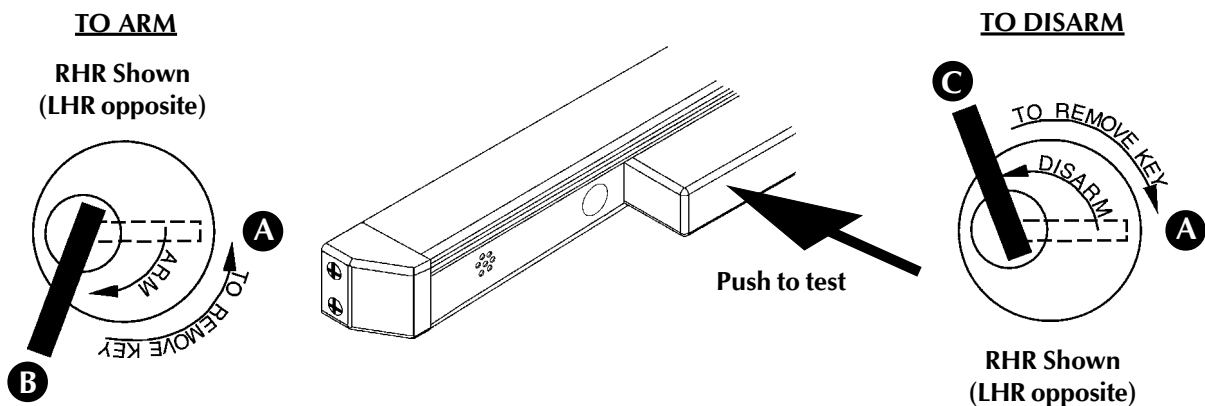

CHANGING THE BATTERY

If the battery is low, a beep will sound every 35 to 40 seconds until the battery is changed. This beeping cannot be stopped by disarming the unit.

To change the battery, follow steps **A** through **C** below, then reassemble.

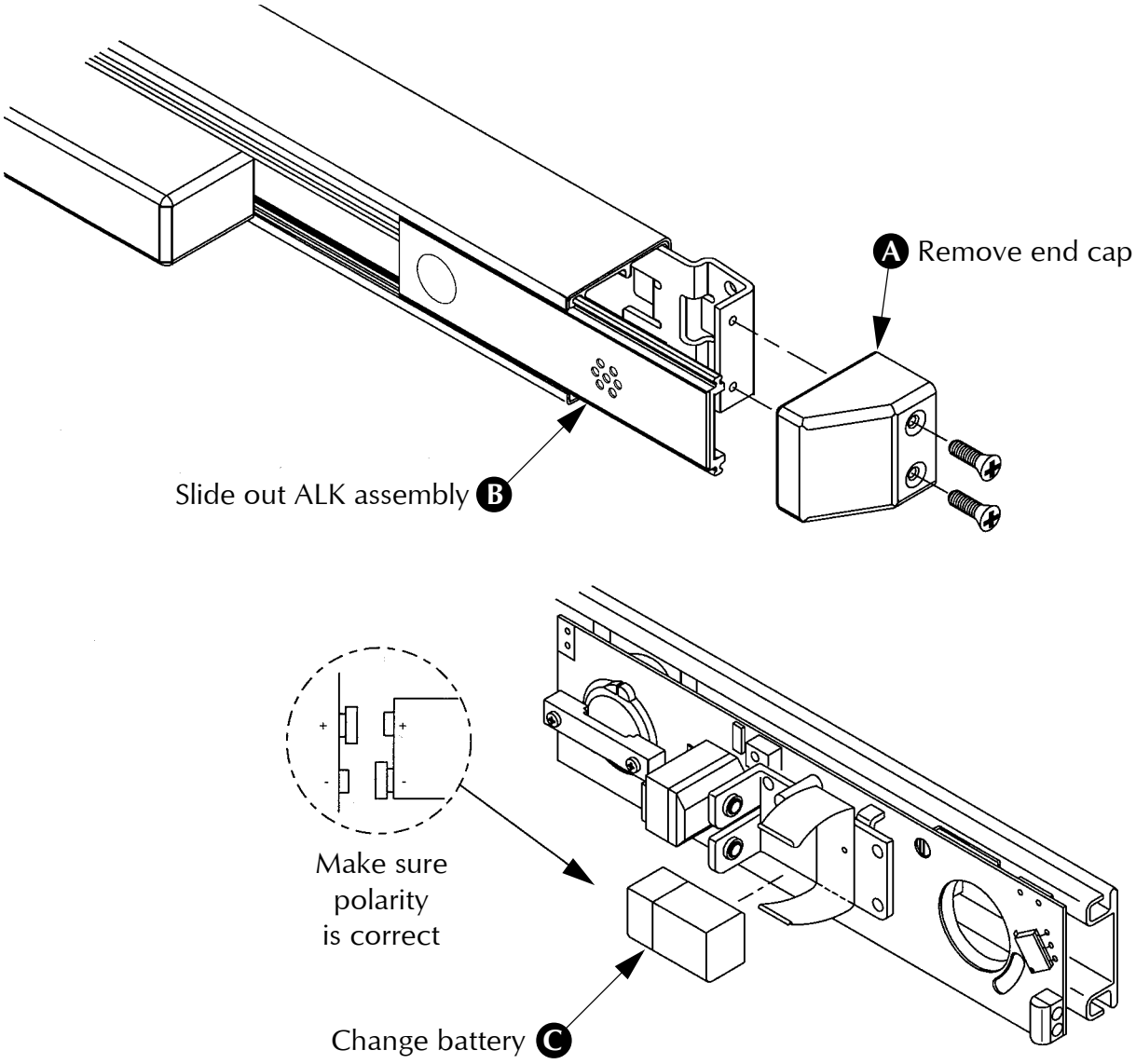

EI (EXTERNAL INHIBIT) WIRING



NOTE

The EI feature is optional and will not function unless the ALK was ordered with this option.

The EI (external inhibit) option uses NO (normally open) dry access control contacts to inhibit the ALK.

Closing the access control contacts inhibits the ALK. When the access control contacts are re-opened, the ALK re-arms after its 20-second rearm delay.

