

ANDERS X-LARGE PENDANT

GLP1064

General Product Information

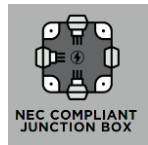
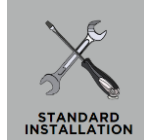

Product Warranty



FCC Statement

Suggested/Required Tools



ELECTRIC DRILL

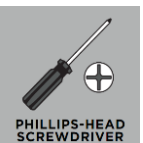

PHILLIPS-HEAD SCREWDRIVER



WIRE CUTTER



PENCIL/MARKER

Safety Information

CAUTION-RISK OF FIRE

This product must be installed in accordance with the applicable installation code by a person familiar with the construction and operation of the product and the hazards involved.

USE MINIMUM 90°C SUPPLY CONDUCTORS.



Turn off electrical current at the source before working with any lighting fixture or portable lamp.

Install and use this product in adherence with local electrical codes and regulations.

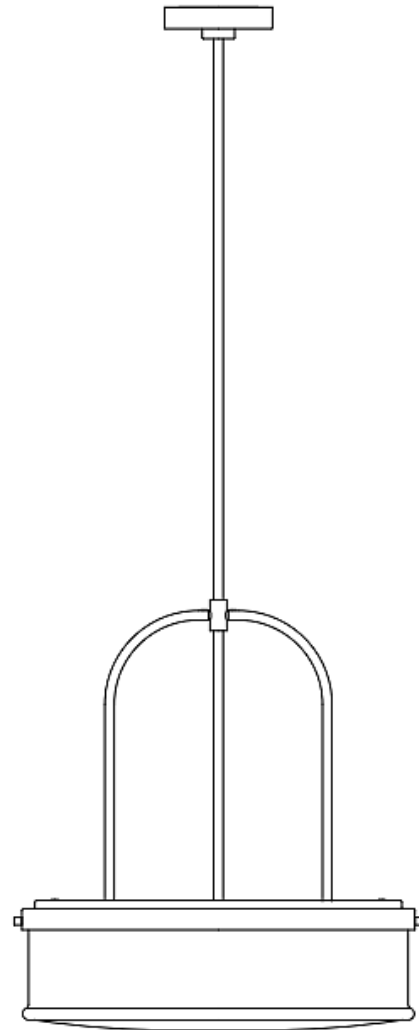

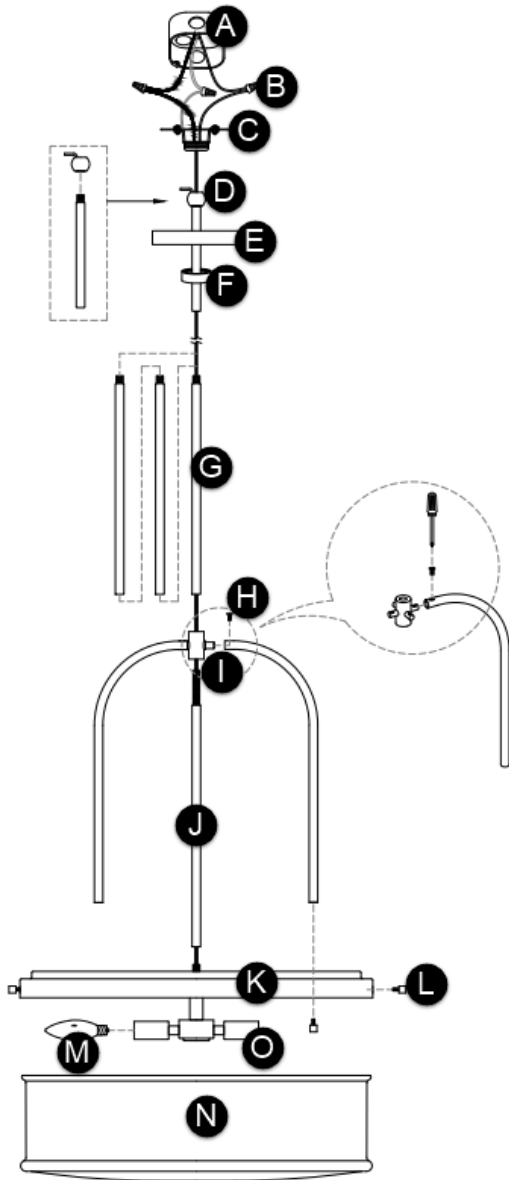

FIXTURE PARTS

- A. Junction Box
- B. Wire Nut Connections
- C. Mounting Plate with Screw Collar & Mounting Screws (Not Illustrated)
- D. Half Ball
- E. Canopy
- F. Collar Nut
- G. Stem Assembly
- H. Fixture Screws
- I. Fixture Arms & Hub
- J. Bottom Stem
- K. Fixture
- L. Cap Screws
- M. Bulb(s)
- N. Shade
- O. Socket(s)

INSTRUCTIONS

I. Preparing the Fixture

1. Separate the mounting plate from the canopy and install it over the junction box using the mounting screws.
2. Feed the fixture wires through the bottom stem and the fixture hub. Install the bottom stem on the fixture body and then install the hub on the bottom stem.
3. Install the fixture arms to the hub and the fixture body with fixture screws and cap screws as shown in the illustration.
4. Determine the desired height of the fixture and complete the stem assembly by screwing the stems together.
5. Feed the fixture wires through the stem assembly, collar nut, canopy, and half ball.
6. Screw the stem assembly on top of the hub. Then screw the half ball onto the stem assembly.
7. Slide the half ball of the assembled fixture onto the mounting plate.

II. Wiring the Fixture

1. Safety first! Locate the circuit breaker and switch it off to cut off the power supply to the relevant circuits to ensure there's no electricity running through the wiring.
2. In accordance with local electrical codes, connect the fixture ground wire (bare copper or silver wire) to suitable ground. This may be a green ground screw on the mounting plate or a house wire (green or bare copper wire without insulation).
3. Twist the bare ends of the following pairs of wires together using a wire nut to secure a connection:
 - a) Hot fixture wire (black/smooth) and hot power line wire from the junction box (hot to hot)
 - b) Neutral fixture wire (white/textured) and neutral power line wire from the junction box (neutral to neutral)
4. Carefully tuck all the wires behind the mounting plate into the junction box.

III. Installing the Fixture

1. Mount the canopy onto the mounting plate and secure it in place by screwing the collar nut tightly onto it.
2. Install the bulbs into the sockets. Refer to the socket label for max wattage information.
3. To complete the installation, install the shade onto the fixture body and secure it in place with the cap screws.