

# Kenway Pendant

700KEN

1.1



PENDANTS

### GENERAL PRODUCT INFORMATION:



This product is suitable for indoor locations.

This product can be dimmed with a standard electronic dimmer.

This instruction shows a typical installation.

**SAVE THESE INSTRUCTIONS!**

**CAUTION - RISK OF FIRE**  
 This product must be installed in accordance with the applicable installation code by a person familiar with the construction and operation of the product and the hazards involved.  
**Use minimum 90°C supply conductors.**

**WARNING - LUMINAIRE SUPPORT**  
 The luminaire must be supported independent of the outlet box unless the outlet box is listed for the weight to be supported. Please see below for complete luminaire weight:

700TDKNW18\*-LED930 - 15 lbs.  
 700TDKNW25\*-LED930 - 20 lbs.  
 700TDKNW42\*-LED930 - 20 lbs.

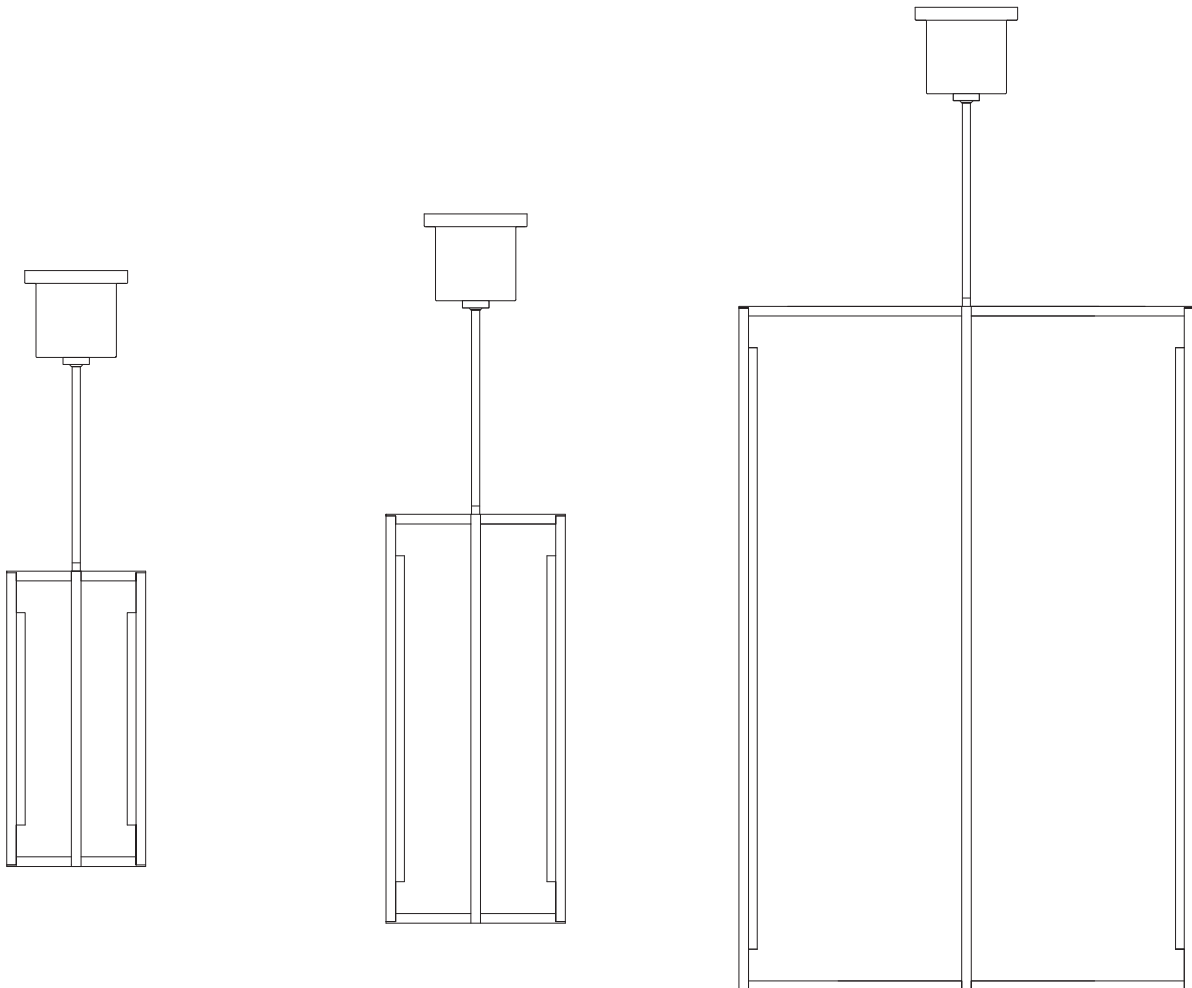

# Install the Fixture

1A

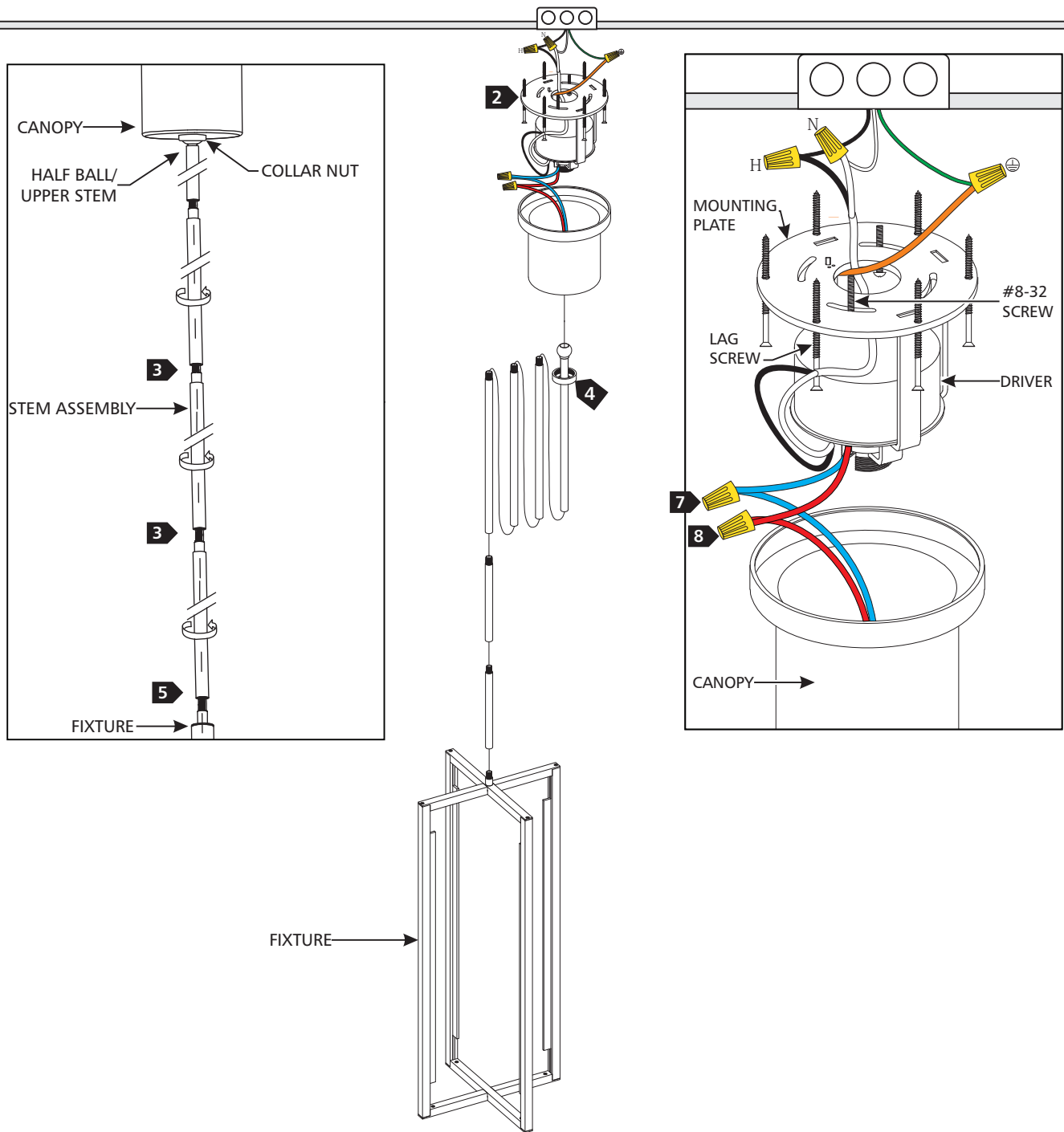

- 1 Remove the mounting plate and driver from the canopy.
- 2 Secure the mounting plate to the junction box with the provided #8-32 screws. **Warning: if the outlet box is not listed to support the luminaire's weight, it must be supported by an independent structure. See cover page for luminaire weight.**
- 3 Determine the desired height of the fixture using the provided stems and half ball/upper stem and assemble them by screwing them together.
- 4 Slide the collar nut over the half ball/stem assembly.
- 5 Feed the fixture wires through the stem assembly, then screw the stem assembly to the top of the fixture.
- 6 Feed the fixture wires and half ball/stem assembly through the canopy, then seat the half ball into the mounting plate. **(Make sure to avoid pinching the wires.)**
- 7 Connect the blue driver wire to the blue fixture wire with a wire nut.
- 8 Connect the red driver wire to the red fixture wire with a wire nut.
- 9 Connect the fixture to a suitable ground in accordance with local electrical codes.
- 10 Connect the white driver wires to the neutral power line wire with a wire nut.
- 11 Connect the black driver wires to the hot power line wire with a wire nut.
- 12 Neatly place the drivers, all wires, and wire nut connections inside the canopy, slide the canopy up to over the mounting bracket and secure in place with the collar nut.