

The uniquely modern Revel outdoor bollard features a sleek metal surface that is laser-cut with horizontal slots which allow the LED light to shine through an inner white diffuser. The subtle, ambient glow enhances way-finding on paths or in landscape applications.

High quality LM80-tested LEDs

for consistent long-life performance and color

Outstanding protection against the elements:

- Marine-grade powder coat finishes
- Stainless Steel mounting hardware
- Impact-resistant, UV stabilized frosted acrylic lensing

SPECIFICATIONS

DELIVERED LUMENS	125.2
WATTS	18.9
VOLTAGE	Universal 120V, 277V, with integral transient 2.5kV surge protection
SECONDARY SURGE PROTECTOR	10kA
DIMMING	0-10, ELV
LIGHT DISTRIBUTION	Symmetric
MOUNTING OPTIONS**	Bolt
PERFORMANCE OPTIONS	Photocontrol / In-Line Fuse
CCT	3000K or 4000K
CRI	80+
COLOR BINNING	3 Step
BUG RATING	B0-U2-G0
DARK SKY	Compliant
WET LISTED	IP65
GENERAL LISTING	ETL
CALIFORNIA TITLE 24	Can be used to comply with CEC 2016 Title 24 Part 6 for outdoor use. Registration with CEC Appliance Database not required.
START TEMP	-30°C
FIELD SERVICEABLE LED	Yes
CONSTRUCTION	Aluminum
HARDWARE	Stainless Steel
FINISH	Marine Grade Powder Coat
LED LIFETIME	L70; 70,000 Hours
WARRANTY*	5 Years

* Visit techlighting.com for specific warranty limitations and details.

**Bollard base not suitable for branch circuit through wiring.



REVEL BOLLARD
shown in bronze



REVEL BOLLARD
shown in charcoal

ORDERING INFORMATION

7000BRVL	CRI/CCT	LENGTH	LENS	FINISH	VOLTAGE	DISTRIBUTION	OPTIONS
830	80 CRI, 3000K	42 42"	D DIFFUSE	Z BRONZE	UNV 120V-277V	S SYMMETRIC	NONE
840	80 CRI, 4000K			H CHARCOAL			PC BUTTON PHOTOCONTROL
							LF IN-LINE FUSE
							PCLF BUTTON PHOTOCONTROL & IN-LINE FUSE

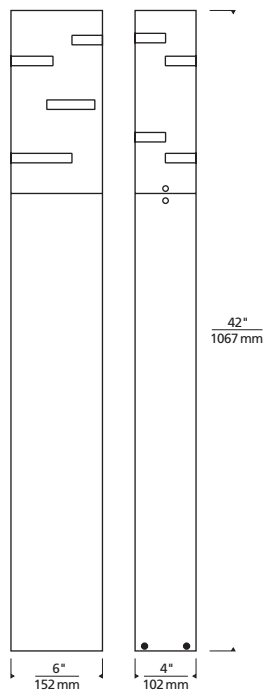

Revel Bollard

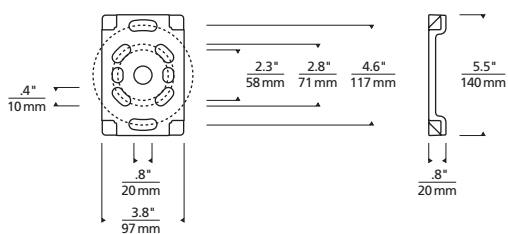

Anchor Plate Bolt Pattern

PHOTOMETRICS*

*For latest photometrics, please visit www.techlighting.com/OUTDOOR

REVEL BOLLARD

- Total Lumen Output: 125.2
- Total Power: 18.9
- Luminaire Efficacy: 6.6
- Color Temp: 4000K
- CRI: 80+
- BUG Rating: BO-U2-G0

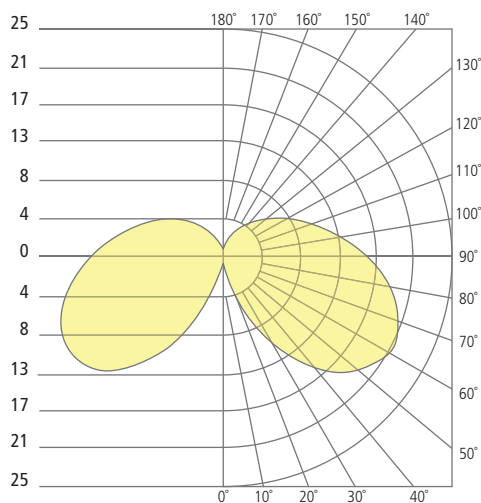

PROJECT INFO

FIXTURE TYPE & QUANTITY

JOB NAME & INFO

NOTES
