

Kitchen Faucet 88413B4

PACKING LIST

After you open this package, please check to ensure that all of the following items are included.

- A- Faucet B- Spray Head C- Flexible Hoses(2) D- Pull-out hose E- Mounting Nut + Washer
 F- Weight(1) + Screw (2) G- Brass Adaptor + Back Pressure Valve H- Allen Wrench I- support

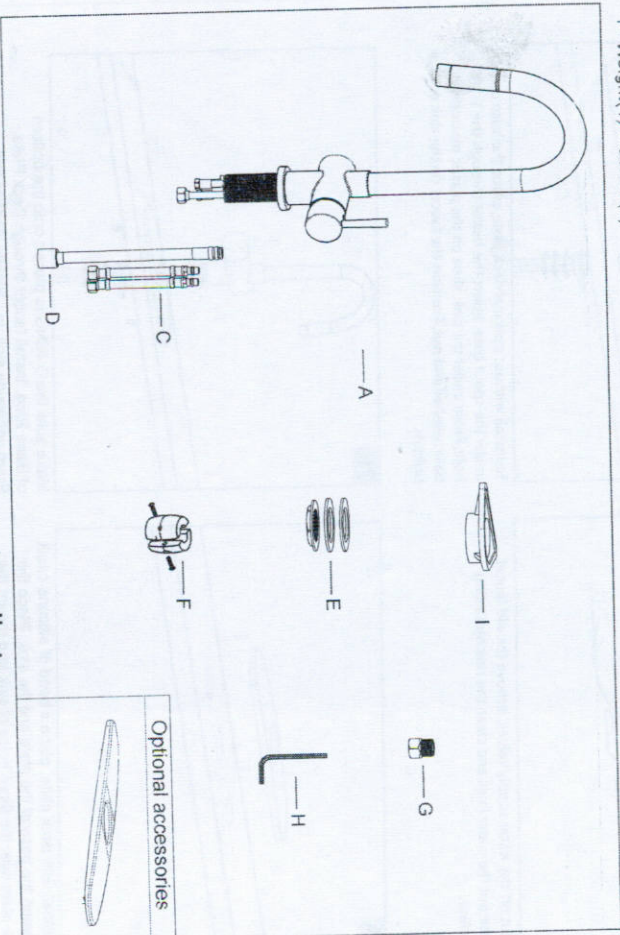

Please rinse water lines prior to installation

YOU MAY NEED

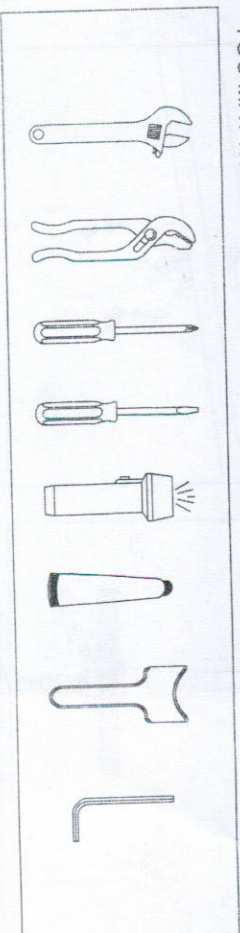

CAUTION: Maintenance

1. Replacement parts may be available at the store where you purchased your faucet.
2. Always turn off water and relieve pressure before working on your faucet.

NOTES: Cleaning Instructions

1. Clean the faucet with clearwater or mild liquid, rinse the faucet with clearwater and then dry the faucet with soft cotton cloths.
2. Do not use any abrasive cleansers, cloths, or paper towel.
3. Do not use any acid or strong detergent.

TROUBLE-SHOOTING

If you've followed the instruction carefully and your faucet still does not work properly, take these corrective steps.

Problem	Cause	Action
Leaks underneath handle.	Cartridge has come loose.	Tighten the cartridge.
Aerator leaks or has an inconsistent water flow pattern.	Aerator is dirty or misfitted.	Unscrew the aerator to clean or replace washer, or replace the aerator.
Water will not shut off completely.	Dirty or worn out washer in cartridge.	Remove handle and cartridge to check if the washer is damaged permanently or dirty. Re-install cartridge.

PSK-1002-BN

INSTALLATION PROCEDURES

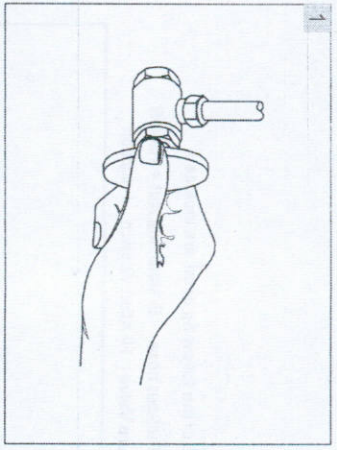

1 Shut off the water supply valves, remove the old faucet, rinse out the water lines and clean the sink mounting surface.

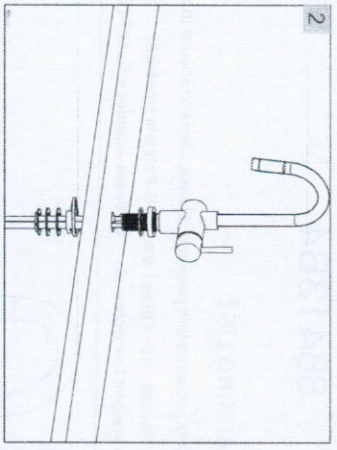

2 To install without optional deck plate, place the base o-ring under the spout base, insert the faucet through the 1-3/8" hole. From under the sink, slide on the plastic mounting base, washer and nut. Position the faucet on the sink and tighten.

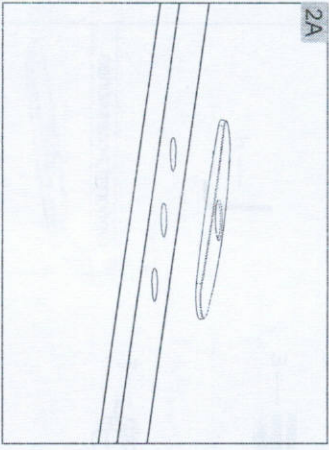

2A To install with deck plate, place a bead of silicone caulk between the base of the plate and the sink. Place the deck plate over the three holes of sink and mount the faucet.

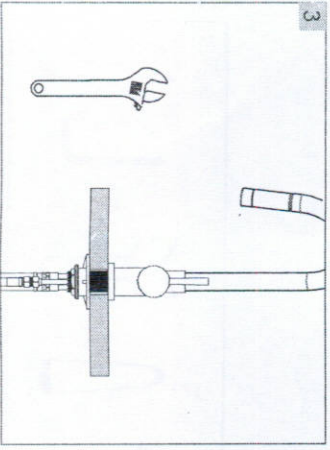

3 If necessary, tighten screws using an adjustable wrench until the faucet is firmly connected to the sink. Do not overtighten.

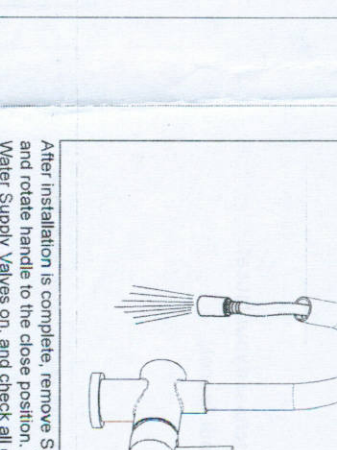

4 Connect hot and cold water supply lines to the Water Supply Valves.

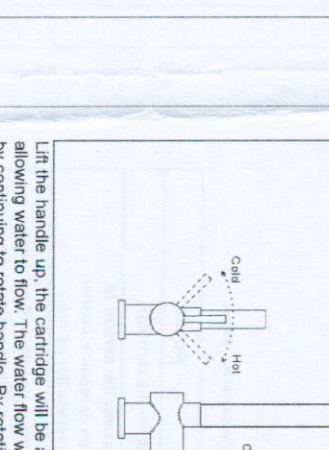

5 Make sure the O-RING is placed onto the bottom of Base Ring. Install faucet through Deck Plate. From underside sink, put Plastic Washer and Mounting Nut. Position faucet on sink properly and tighten Mounting Nut.

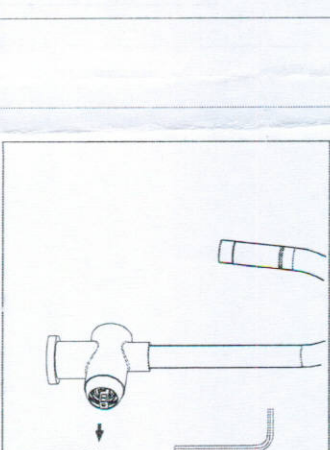

6 Connect hot and cold water supply lines to the Water Supply Valves.

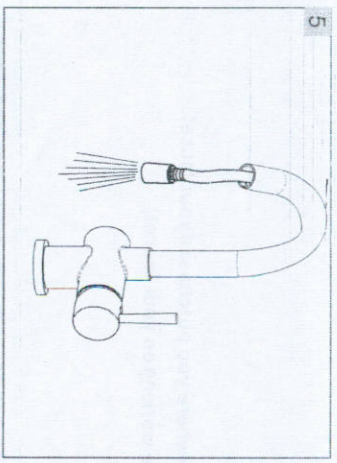

7 After installation is complete, remove Spray head and rotate handle to the close position. Turn Water Supply Valves on, and check all connections for leak. Flush faucet by running hot and cold water in full position for one minute.

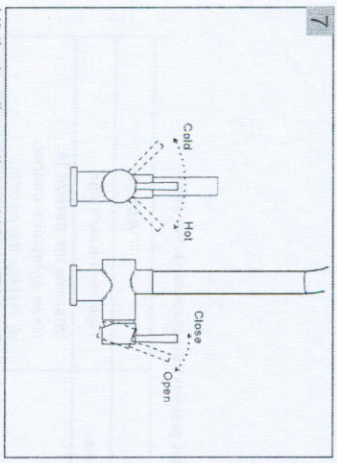

8 Lift the handle up, the cartridge will be activated allowing water to flow. The water flow will increase by continuing to rotate handle. By rotating the handle to the right, the water temperature will decrease to cold flow only. By rotating Handle to the left, the water temperature will increase to hot only.

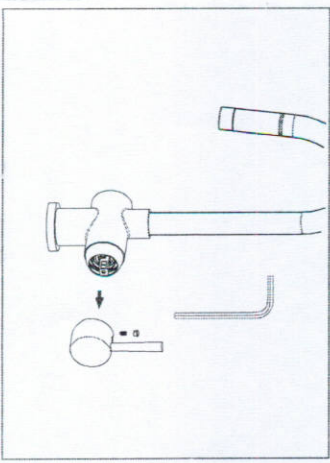

9 Turn off water and relieve pressure! Detach handle button using a small flathead screwdriver, unscrew set screw using Allen Wrench and take off handle.

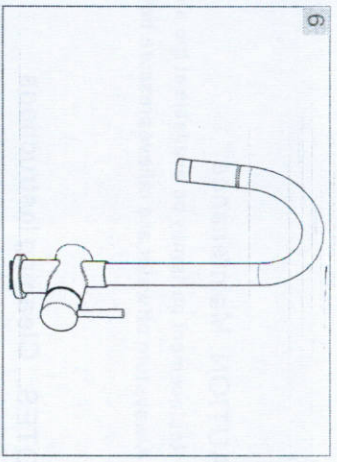

10 Replace Spray head.

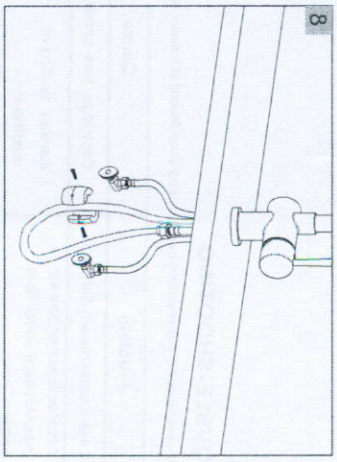

11 Attach the weight to the hose below the faucet by clamping it in place using the provided screws. Weight use is optional. Position the weight near the bottom of the hose bend to draw the spray head in place.

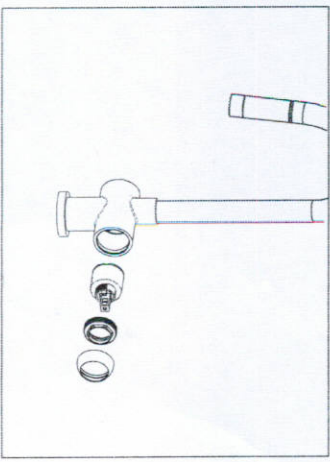

12 Remove handle. Unscrew Dome Cap counter clockwise by hand. Unscrew Retaining Nut using adjustable wrench, take out cartridge assembly and inspect. Replace parts as necessary. Reassemble parts by reversing steps.

Handle Removal Maintenance

Valve Cartridge Removal Maintenance