

# ASSEMBLY AND INSTALLATION INSTRUCTIONS

C0301

**WARNING:** TO AVOID RISK OF ELECTRICAL SHOCK, BE SURE TO SHUT OFF POWER BEFORE INSTALLING OR SERVICING THIS FIXTURE.

**NOTE:** 1. Before installing, consult local electrical codes for wiring and grounding requirements.  
2. Read and save these instructions.

## Hardware Package (included):

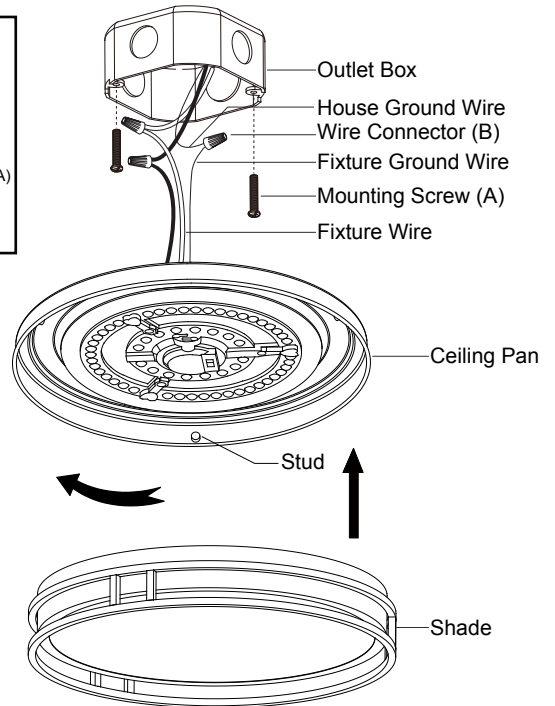
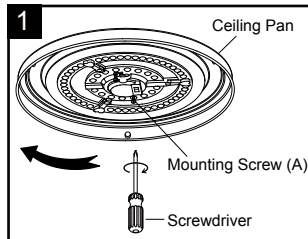
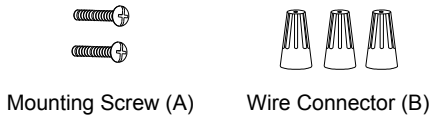

## Installation Steps

Turn off the power at fuse or circuit box

1. Attach the two mounting screws (A) to the holes on outlet box, thread them in part way: 2 to 3 turns only.
2. Connect the black wire to black (power) wire, white wire to white (neutral) wire and fixture ground wire to house ground wire with supplied wire connectors (B). Tuck all wires into outlet box.
3. Attach the ceiling pan to the outlet box by inserting two mounting screws (A) head into the keyholes, then rotate the ceiling pan until it is locked in place, finally secure the mounting screws (A) tightly with screwdriver (not included) (See Fig.1).
4. Attach the shade to the ceiling pan by aligning studs and slots, then turn it clockwise until it is locked in place.

Turn on the power at fuse or circuit box

## Adjusting the Correlated Color Temperature (CCT) of the Light

Customize the correlated color temperature (CCT) of the LED light by moving the toggle switch (For Reference).

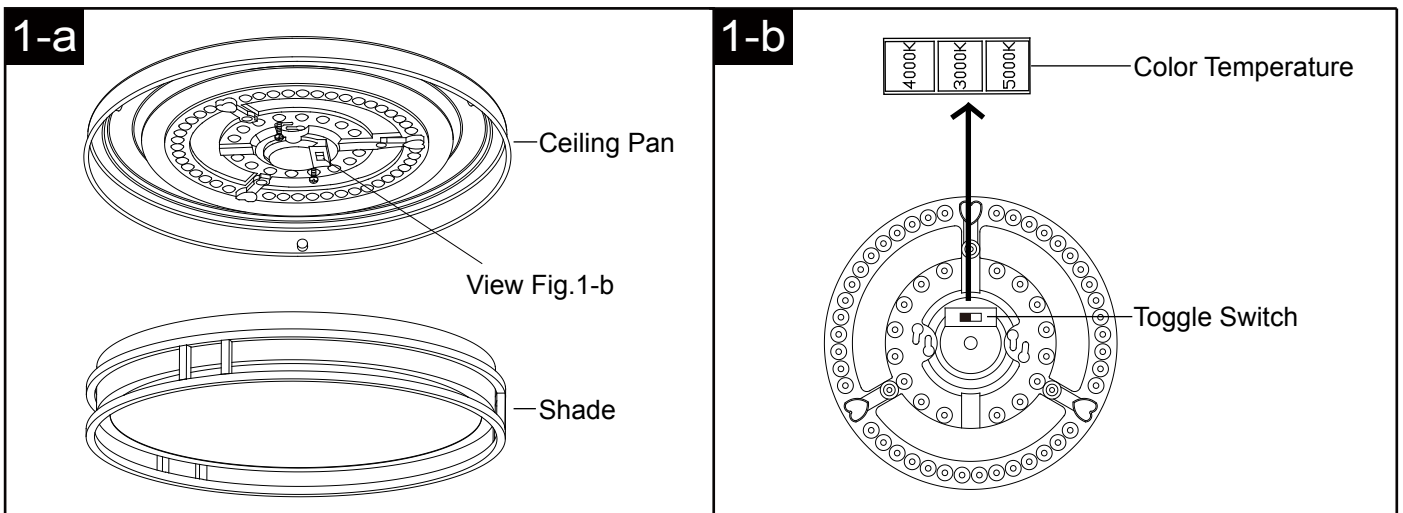

- a. Move the toggle switch to 4000K, the color temperature is set at Bright White.
- b. Move the toggle switch to 3000K, the color temperature is set at Soft White.
- c. Move the toggle switch to 5000K, the color temperature is set at Daylight.

**Notice: Please move the toggle switch to make your selection before attaching shade to the ceiling pan.**

The following parts are available for reorder if damaged or missing.

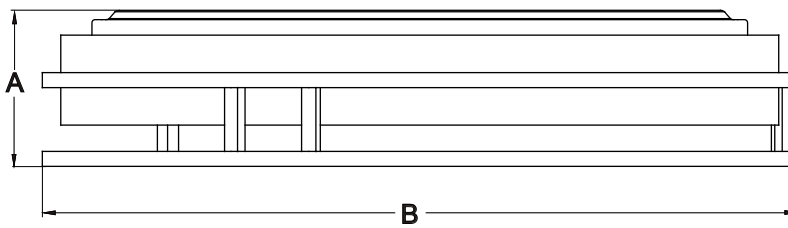
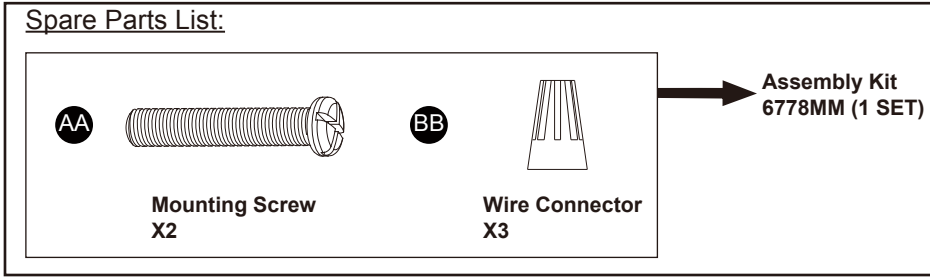

**A: 3-1/2"**

**B: 16"**

**5 Year Limited Warranty**

Vaxcel warrants all of our products against defects in workmanship and finishes for one year following the date of shipment.

In addition:

- Any product with an integrated motion sensor or dusk-to-dawn photocell is supported by a 5-year warranty for the functionality of the product.
- Any product with integrated LED modules is covered by a 5-year warranty on the LED functionality.

*Exclusions: This warranty does not include the failure of products from extreme acts of nature; environmental conditions not suited for the products intended use; operation in temperatures outside of the range specified in the instruction manual; usage with improper power supply, power surges or dips. For coastal locations, some corrosion is considered normal for the environment.*

*Vaxcel reserves the right to repair, replace or issue a credit for any properly installed product, provided it is returned per RMA instruction. This warranty is limited to the cost of the product only and does not extend to transportation, installation or replacement costs.*

How can warranty service be obtained?

info@vaxcel.com  
1-800-482-9235