

ASSEMBLY AND INSTALLATION INSTRUCTIONS

W0164 / W0165

WARNING: TO AVOID RISK OF ELECTRICAL SHOCK, BE SURE TO SHUT OFF POWER WHILE INSTALLING OR SERVICING THIS FIXTURE.

NOTES: 1. Before installing, consult local electrical codes for wiring and grounding requirements.
2. READ AND SAVE THESE INSTRUCTIONS.

Hardware Package (included):

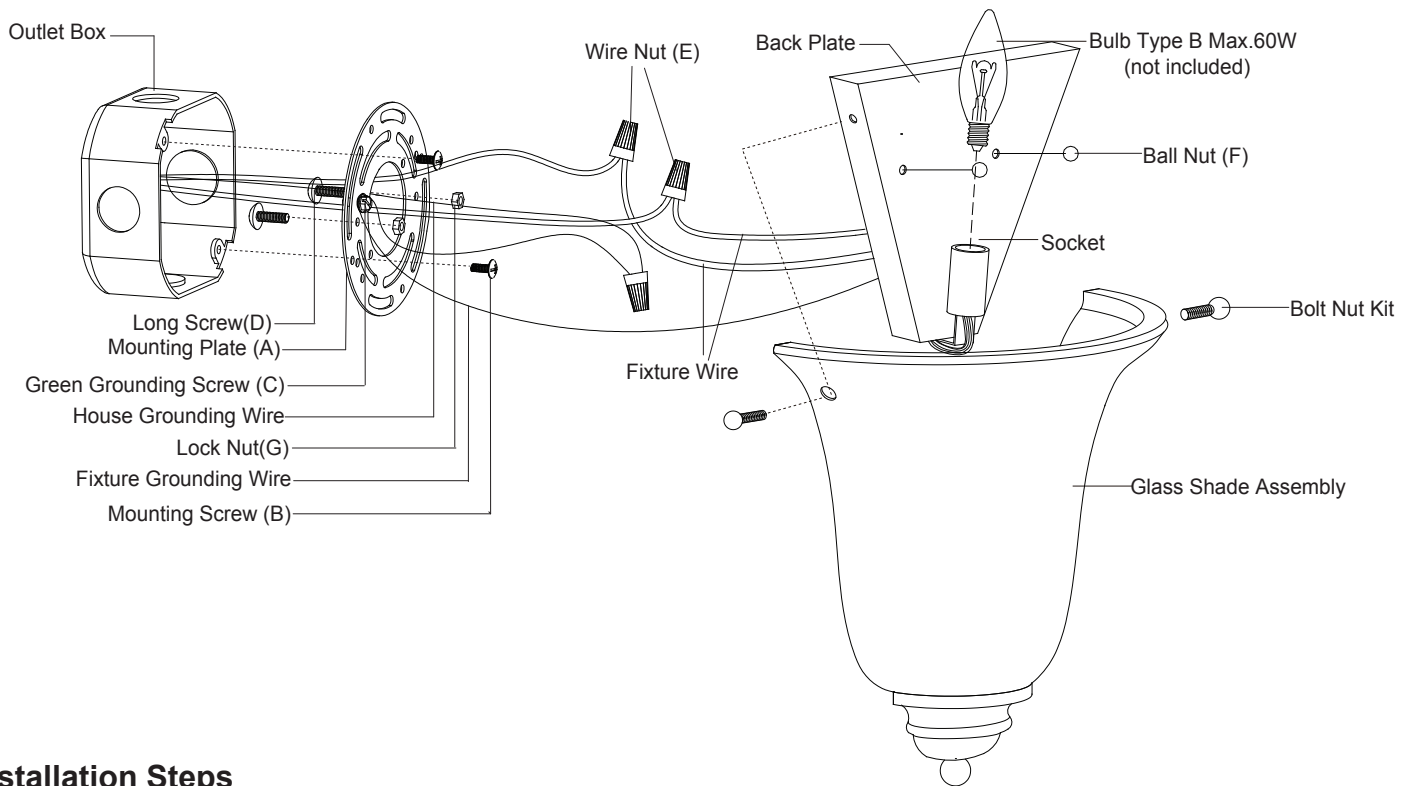

Installation Steps

Turn off the power at fuse or circuit box.

1. Thread two long screws through the mounting plate, then secure them with two lock nuts. Adjust the length of the long screws if necessary.
Note: Make sure that the long screws are lined up horizontally, in order to ensure that the fixture will be level.
2. Attach the mounting plate to the outlet box by using two mounting screws.
3. Pull out the source wires from the outlet box. Make wire connections using wire nuts as follows:
 - Connect the hot wire (usually black insulation) from the fixture to the black wire from the power source.
 - Connect the neutral wire (usually white insulation) from the fixture to the white wire from the power source.
 - Attach the fixture grounding wire (usually green insulation or bare wire) to the mounting plate with the green grounding screw. Then connect it to the house grounding wire with the wire nut.Carefully put the wires back into the outlet box.
4. Attach the back plate to the mounting plate by inserting two long screws, then secure it with two ball nuts.

 **VAXCEL**

141212

5. Install bulb(not included). See relamping label at socket area or packaging for maximum allowed wattage.

6. Attach the glass shade assembly to back plate, secure it with the bolt nut kits.

Turn on the power at fuse or circuit box.

The following parts are available for re-order if damaged or missing.

Spare Parts List:

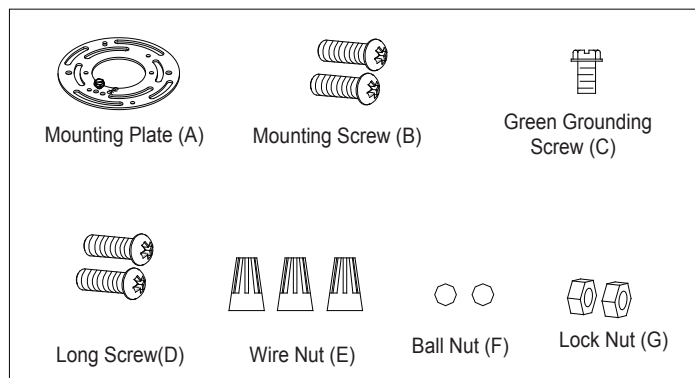

Assembly Kit
5288MM (1 SET) for W0164
5289MM (1 SET) for W0165

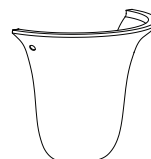

Glass Shade
9698EW(1 PC)

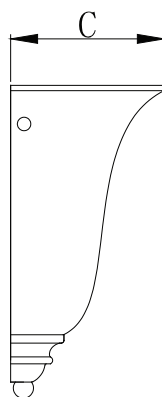
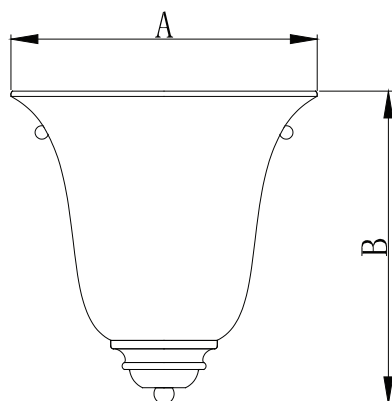

A: 9"

B: 9-1/4"

C: 4-1/2"