



Stainless Solid



Integrated Solid



### Key Features

- Daily ice production of up to 39 lb of ice
- Up to 23 lb in ice storage capacity
- Clear ice cube dimensions: ¾" W x ¾" H x ¾" L
- Silent setting temporarily suspends ice making for 3 hours
- Digital Touch Pad Control
- Indicator alert notifies user when cleaning is needed
- Black interior
- Bright white LED lighting
- Clear heavy duty ice scoop included
- Drain required
- Factory installed drain pump
- Stainless steel handle (7/8" diameter)
- Field reversible door is shipped right-hand hinged
- Built-in or freestanding
- Four adjustable leveling legs

### Model Details

Model	Voltage/Hz	Door Swing	Pump	Finish	Shipping Weight
UACP115-SS01A	115 / 60	Field Reversible	Pump Included	Stainless Solid	125 lb
UACP115-IS01A	115 / 60	Field Reversible	Pump Included	Integrated Solid	125 lb

### Accessories

Model	Description	Finish	Shipping Weight
80-55667-00	Clear Ice Machine Cleaner	N/A	1 lb
ULAWATERHOOKUP	Braided Water Supply Line Kit	N/A	2 lb

**Front**

Dimensions shown apply to all finishes, including Integrated (INT) models with 3/4" integrated panel/frame installed.

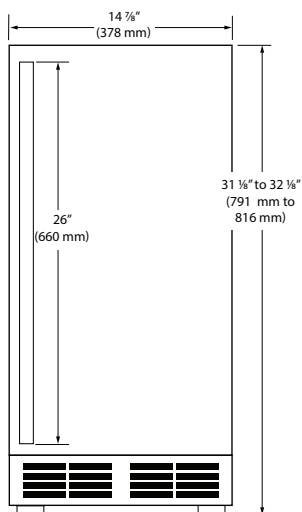

**Side**

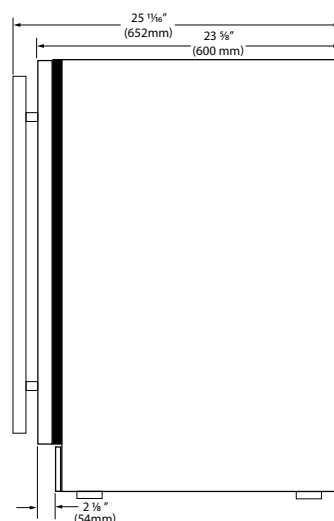

**Top**

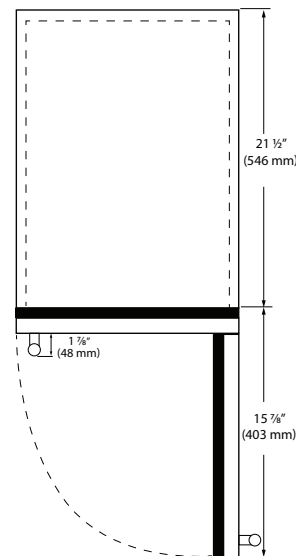

**Back**

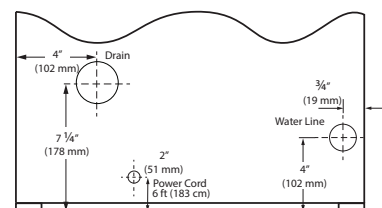

**Specifications**

Model	ACP115
Amps: Running	3.0
Amps: Ice Harvest	3.5
Control Type	Digital Touch Pad
Defrost Type	N/A
Dimensions: Product Depth	23 5/8"
Dimensions: Product Height	31 1/8"
Dimensions: Product Width	14 7/8"
ENERGY STAR	N/A
Ice Production Per Day	39 lb
Ice Storage	23 lb
Panel Height	27 1/32" / 687mm
Panel Thickness	3/4" / 20 mm
Panel Type	Solid Panel
Panel Width	14 5/8" / 371mm
Product Weight: Max	125 lb
Refrigerant Type	R600a (1.94 oz)
Sabbath (Star K Certified)	Yes

**Cabinet Cut-Out**

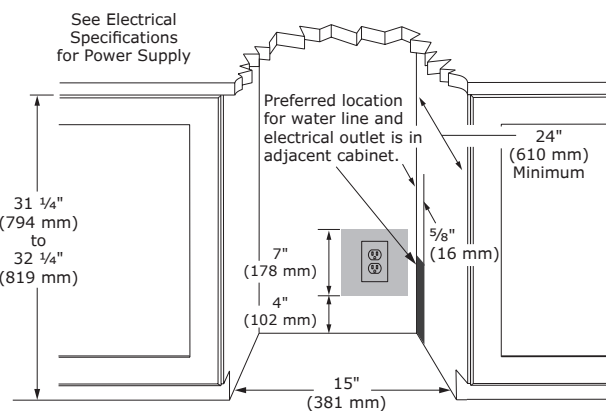

**Installation Notes**

- No additional clearance is needed for ventilation
- Do not obstruct front grille air flow

**Warranty**

- 1 Year (parts & labor) / 5 year sealed system (parts)
- + **Additional 1 Year (parts & labor) warranty at no cost with product registration**

See complete warranty for details

