

# POST MOUNT

## Assembly Instructions

MODEL#: 100



### CAUTION

•Inspect the wire insulation for any cuts, abrasions, or exposed copper that may have resulted during shipping. If there is a defect in the wire, do not attempt installation.

•Before starting installation of this fixture or removal of a previous fixture, disconnect the power by turning off the circuit breaker or by removing the fuse at the fuse box.

#### TOOLS REQUIRED



Ladder



Safety  
glasses



Electrical  
tape



Phillips  
screwdriver

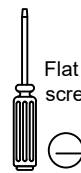

Flat blade  
screwdriver



Pliers

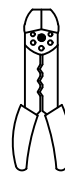

Wire  
strippers

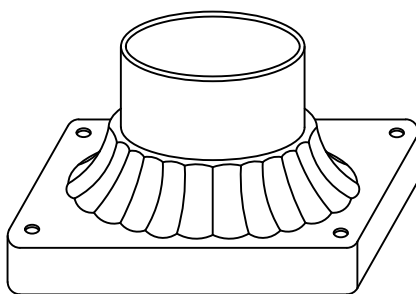

Fixture

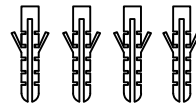

Plastic Anchors

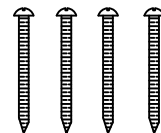

Tapping Screw

\*PARTS SHOWN MAY DIFFER SLIGHTLY PER LIGHT FIXTURE

POST MOUNT  
Assembly Instructions  
MODEL#:100

---

STEP 1

Drill 4 holes in the ground according to the Fixture hole position, and stuff the Plastic Anchors into the drilled hole position

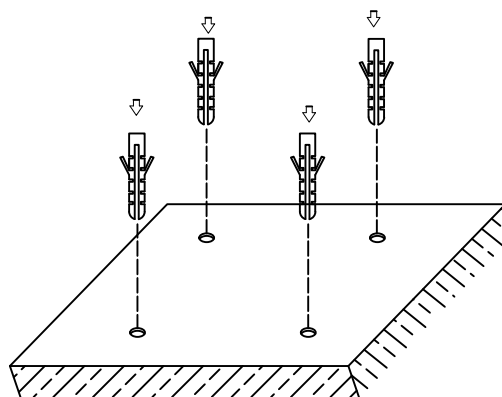

STEP 2

Align the hole location with the bolt and tighten the screws

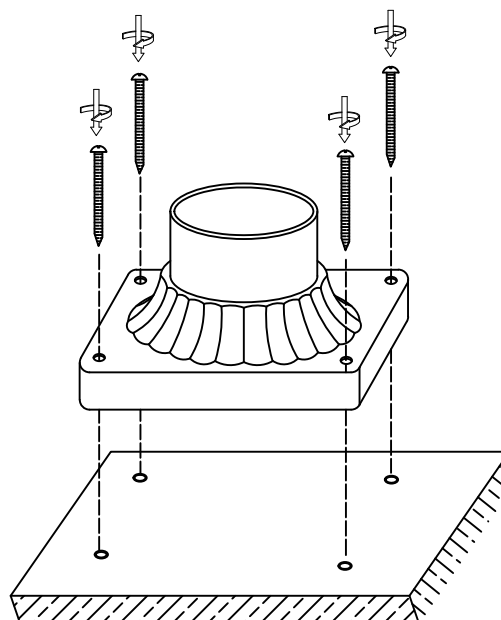

STEP 3

The installation is complete

