

Amenities

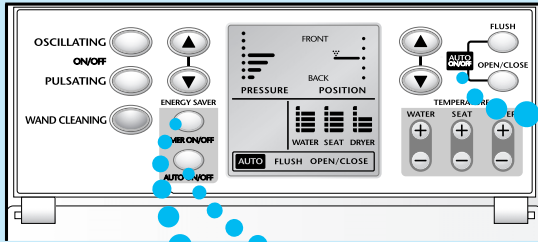

See Pages 16 - 23 of the Instruction Manual for details.

Automatic Functions

- FLUSH** When you leave the seat, the toilet is flushed automatically.
 - OPEN/CLOSE** The sensor detects a person and the lid opens and closes itself.
- For troubleshooting, see page 35 - 41 of the Instruction Manual.

Timer Energy Saver

Once set, the seat heater shuts off at the preset time every day to save power.

(The power saving durations are 3, 6 and 9 hours.)

Example To save power for 6 hours.
(From 1:00 ~ 7:00 a.m.)

Press the **Timer On/Off** button at the desired start time (1:00 a.m.)

Press the **Timer On/Off** button until the correct duration (6) appears.

Finish

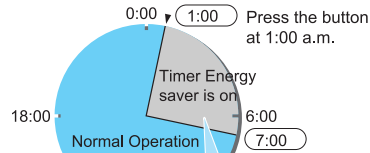

Main unit display

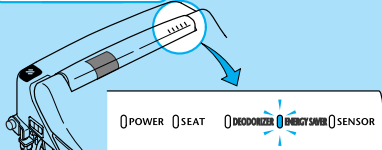

During timer energy saving, the "ENERGY SAVER" LED will be green.

Auto Energy Saver

Hours in which the unit is infrequently used are memorized. During these times, the toilet seat temperature is lowered to save power.

Press the **AUTO ON/OFF** button

Finish

Auto energy saving will begin

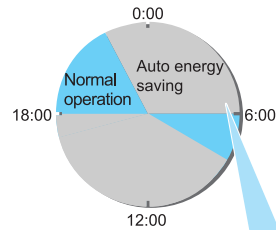

Main unit display

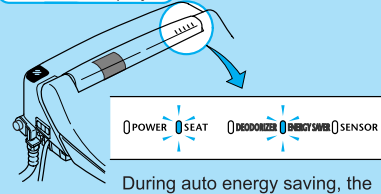

During auto energy saving, the "ENERGY SAVER" LED will be orange.

The timer energy saver and the auto energy saver can be used simultaneously.

TOTO®

Washlet® S400

SW563/SW564

How To Use

For details, see page 14 - 15 in the instruction manual.

Cleansing

- REAR CLEANSING** To wash the bottom.
- REAR CLEANSING (SOFT)** To wash the bottom with mild spray.
- FRONT CLEANSING** To wash the front.

Comfort Washes

- OSCILLATING** The wand moves back and forth.
- PULSATING** Varies the water pressure.

Adjusting the water pressure and cleaning position.

Flushing

The toilet can be flushed by remote control

Opening and closing the toilet seat and lid

- Closes the lid and seat
- Opens the lid, closes the seat.
- Opens the lid and seat

Dryer

Blows warm air to aid drying.

Stop

Stops the washing or drying.

Temperature Adjustment

Open the cover to operate

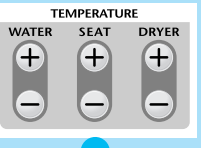
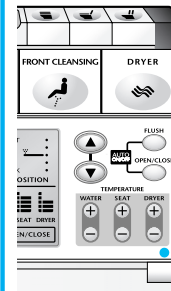

See page 16 of the Instruction Manual for details.

Main unit controls

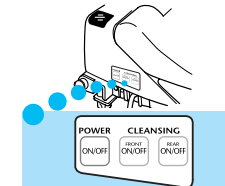

Use in case of necessity.

For your safety, be sure to inspect your S400 occasionally.

- Is the power plug abnormally hot?
- Is the power plug covered with dust?
- Is the outlet loose?
- Is your S400 operating differently than usual?

* In case anything is abnormal, contact TOTO USA to prevent a fire or an electrical shock.

Caring for your Washlet®

Toilet Seat and Lid

Removal

- 1 Open the seat and lid and then open the seat lock (grey) until you hear a "click".

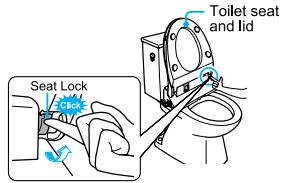

- 2 Align the lid with the top of the seat sensor window (black)

Pull straight up on both seat and lid

The toilet seat cord can only be pulled out about 2" (5 cm). (Pulling with excess force may damage the Washlet).

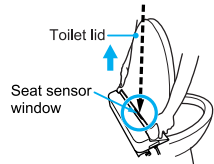

Attachment

- 1 Confirm that the toilet seat pins are facing up and down. If they are not, press the button on the remote. Then, press the button.

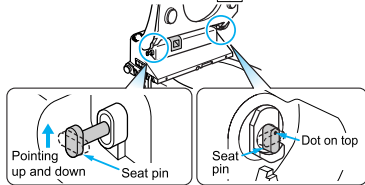

- 2 Confirm that the seat locks (Grey) are up.

If the seat lock is not up, the seat and lid can not be attached.

- 3 Align the seat and lid with the top of the seat sensor window (black) and push firmly onto the toilet seat pins.

Attach so that the blue toilet seat cord is not twisted.

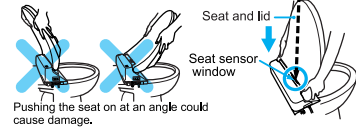

- 4 Lower the seat locks (grey) until a click is heard.

If the seat locks will not go down, the seat is not properly attached. Remove the seat and reattach it.

See Page 26 - 27 of the Instruction manual for more details.

When Removing the Main Unit

Warning

When removing the main unit for care or maintenance, unplug the power cord. (Otherwise, an electrical shock may occur)

Before removing the main unit, be sure to unplug the auto flushing cord.

After care and maintenance, reattach the auto flush cord after the unit is reattached to the toilet.

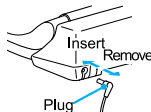
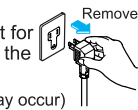

Main Unit

Removal

Hold in the main unit removal button and pull forward.

Reattach

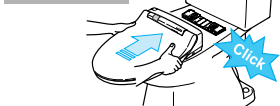

See page 28 of Instruction Manual.

Before Maintenance

Before care or maintenance, turn off the auto open/close and auto flush buttons.



Otherwise, the auto open or auto flush could activate during cleaning.

Important Notes

Each component can be disassembled for thorough cleaning.

Wet and wring out a soft cloth for wiping the lid, seat and wand.

Use a small brush, such as a toothbrush, to clean the filters.

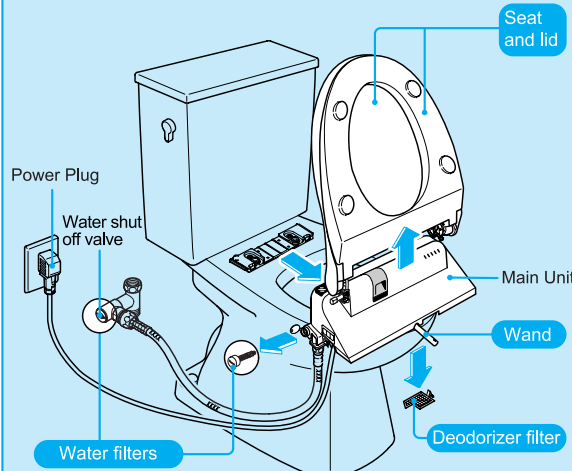

Wand

Extend the wand

Press the button.

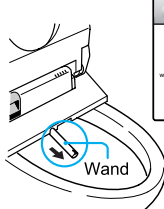

Retract the wand

Press the button again.

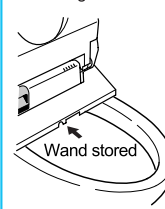

See page 29 of the instruction manual.

Water Filter

Removal

- 1 Close the shut off valve and the junction valve.

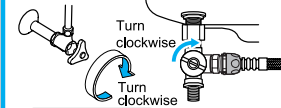

Caution

Do not remove the drain valve and filter with the water shut off valve open. (Water will spray out.)

- 2 Open the cover with a flat head screwdriver and remove the drain valve with filter.

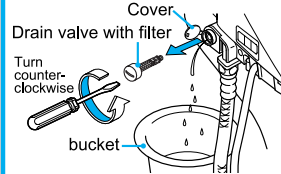

- 3 To access the junction valve filter, the junction valve cover must be removed. Use a large flathead screwdriver or coin and turn the valve cover counter-clockwise. Place a container underneath the junction valve. After removing the junction valve cover, gently pull the strainer out.

Junction Valve

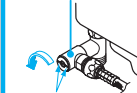

Junction Valve Cover (turn counter-clockwise) to remove



Filter Junction Valve Cover

Installation

- 1 Install the water drain valve and filter.

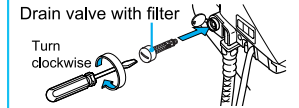

Caution

Tighten the drain valve securely. (if not properly installed and tightened, it may leak.)

- 2 Insert the junction valve cover with filter.

Push the junction valve cover with filter into the junction valve and turn it clockwise. Be sure to tighten it securely.



Junction Valve Cover (turn clockwise) to reset

- 3 Open the water shut off valve and junction valve. Check for leaks and replace cover.

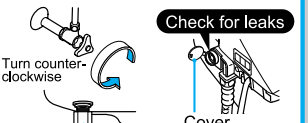

Check for leaks

See page 30 and 31 of the instruction manual for details.

Deodorizer Filter

Removal

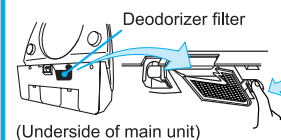

(Underside of main unit)

Installation

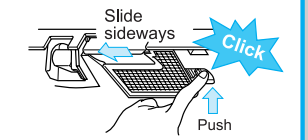

Push

See page 29 in the installation manual for details.