



## FEATURES & BENEFITS

- + **Precise Temperature Control** - Electronic temperature control with LED digital display - set temperature anywhere between 41-65°F and the wine cooler will hold it precisely
- + **Maximum Storage Capacity** - Holds up to 42 bottles for maximum storage
- + **Dual Temperature Zones** - Store red, white, and sparkling beverages at the appropriate temperature for proper preservation and maximum taste
- + **Pull-out Racks** - Pull-out wine racks allow for easy access to your prized vintage collection
- + **Interior Lights** - LED interior light so you can easily see what's inside.
- + **Door Alarm** - Door alarm notifies you if the door is left ajar for too long
- + **Charcoal Filtration System** - An active charcoal filtration system to ensure air purity, cooling efficiency and helps to maintain an odor free cabinet for the storage of your wine.

**Product:** 24 Inch French Door Wine Cooler

**Model Number:** TWC2402

## PRODUCT DIMENSIONS

Cooler Width (in.)	23 1/2"
Depth (Excluding Handles) (in.)	23
Depth (Including Handles) (in.)	26 1/8"
Depth (Less Door) (in.)	21 1/2"
Depth With Door Open 90 Degrees (in.)	34
Height to Top of Door Hinge (in.)	34 1/4"
Product Depth (in.)	23
Product Height (in.)	34 1/4"
Product Width (in.)	23 1/2"

## TECHNICAL DETAILS

Bottle Storage Capacity	42
Color/Finish	Stainless Steel
Voltage (Volts)	120
Minimum Temperature (F)	41
Number of Doors	2 Door
Number of Refrigerator Shelves	10 Shelves
Number of Temperature Zones	Double Zone
Operational Features	LED Controls
Product Weight (lb.)	99 lb

**LIMITED WARRANTY: 24 MONTHS ON PARTS ONLY**



### TWC2402 Installation

This unit is designed for both built-in or free-standing installation. If you plan to use this unit in a built-in application, please follow the requirements shown below.

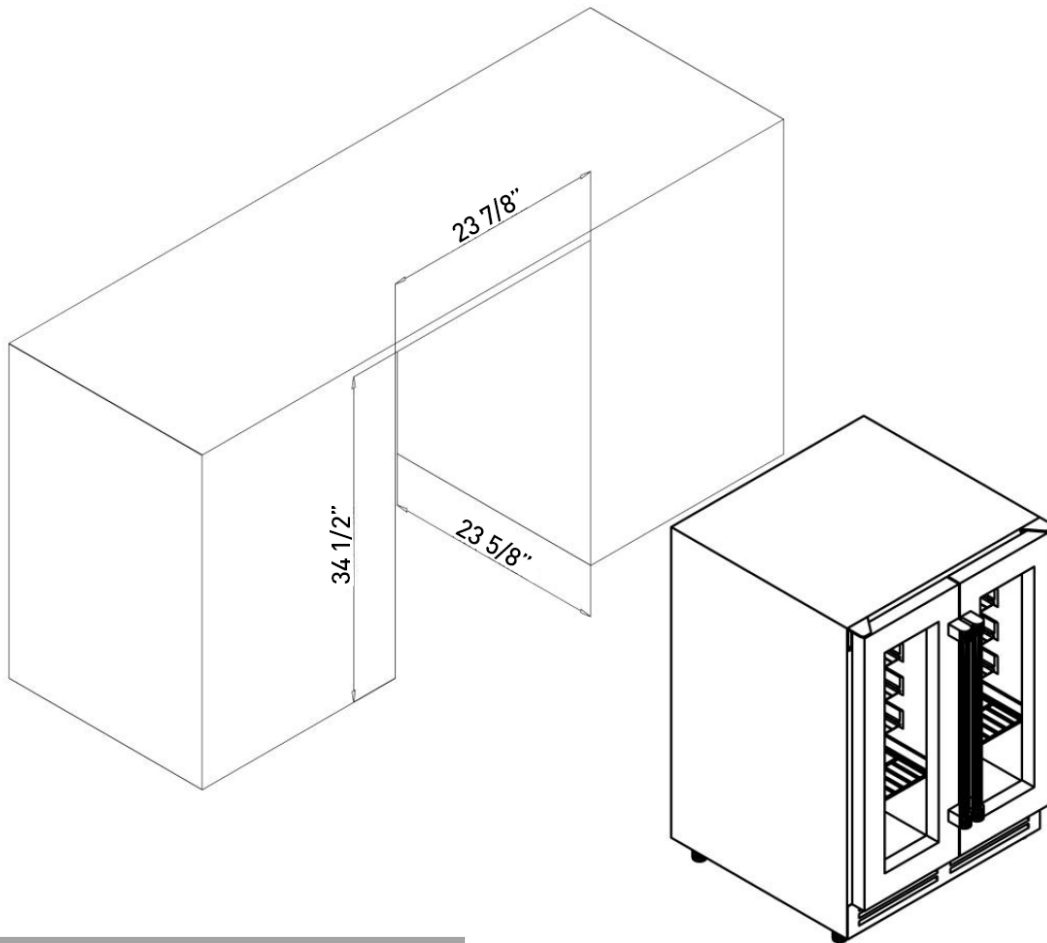

Cut-out Dimension	
Width	$\geq 23 \frac{7}{8}$ "
Depth	$\geq 23 \frac{5}{8}$ "
Height	$\geq 34 \frac{1}{2}$ "