

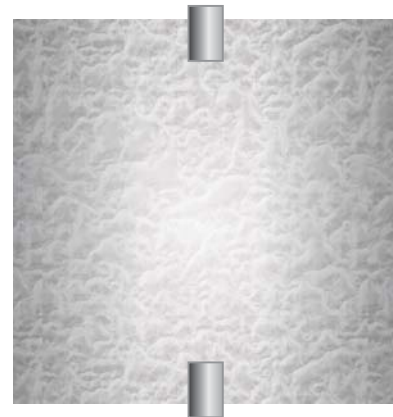

**WALL COLLECTION**

**GENERAL PRODUCT INFORMATION:**

This product can mount to either a 4" square electrical box with round plaster ring or an octagon electrical box.



**CAUTION—RISK OF FIRE**

This product requires installation by a qualified electrician. Before installing be sure to read all instructions and **DISCONNECT POWER TO THE ELECTRICAL BOX.**

**Mount the Sconce**

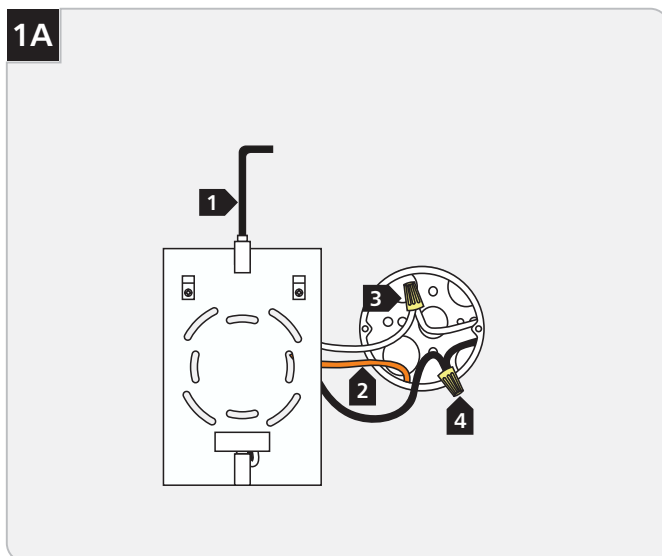

- 1** Loosen the Allen-head screw and remove the upper arm.
- 2** Connect the braided copper wire to a suitable ground in accordance with local electrical codes.
- 3** Connect the white fixture wire to the neutral 120 volt power line wire with a wire nut.
- 4** Connect the black fixture wire to the hot 120 volt power line wire with a wire nut.

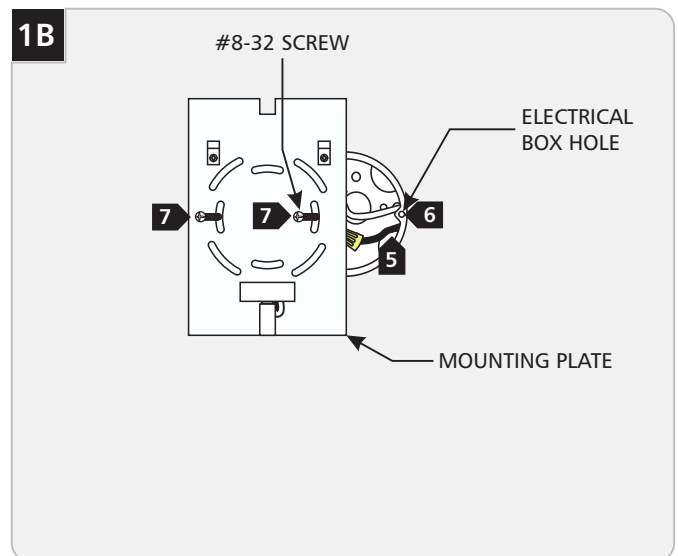

- 5** Properly place all wires and wire nut connections into the electrical box.
- 6** Line up two mounting plate slots with the two electrical box holes.
- 7** Level the mounting plate vertically and secure it to the electrical box with the two #8-32 screws.

## Install the Lamp

2A

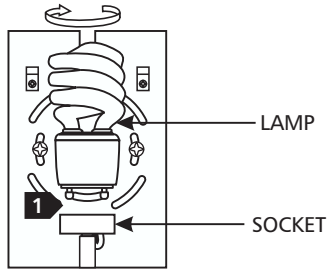

**CAUTION:** To reduce the risk of a burn or electric shock during relamping, disconnect power to the fixture.

Use **MAX 18 Watt**  
Type Self-Ballasted GU24 Base  
Spiral Compact Fluorescent Lamp.



- 1 Push the lamp pins into the large portion of the socket slots and rotate it clockwise to lock it in place securely.

To install a fabric shade, continue to section 2B.  
To install a glass shade, continue to section 2C.

### Statement of Warranty

Tech Lighting warrants all products manufactured to be free from defects in material and workmanship under normal use for 3 years after the date of original purchase. This warranty only applies when components, including power supplies, have been provided by Tech Lighting.

Upon confirmation of a defect or failure, at our discretion we will repair or replace the item or will refund your purchase price if repair or replacement is not possible or practical. Our warranty covers only the product itself; we will assume no liability for labor costs, installation costs, or other losses.

**SAVE THESE INSTRUCTIONS!**



**TECH LIGHTING®**

7400 Linder Ave, Skokie, IL 60077  
847.410.4400

[www.techlighting.com](http://www.techlighting.com)

© 2008 Tech Lighting, L.L.C. All rights reserved. The "Tech Lighting" graphic is a registered trademark of Tech Lighting, L.L.C. Tech Lighting reserves the right to change specifications for product improvements without notification.

A Generation Brands Company

## Install the Fabric Shade

2B

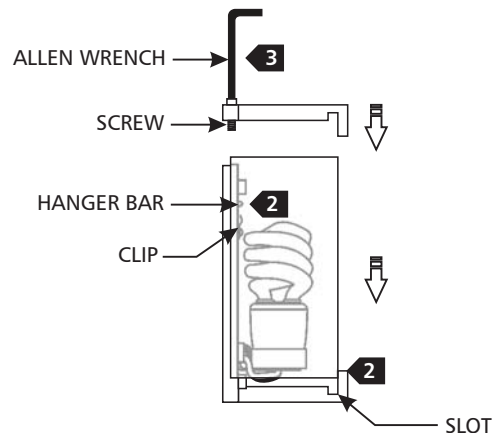

- 2 Carefully slide the shade into the slot on the lower arm while sliding the hanger bar onto the clips.
- 3 To secure the shade, attach the upper arm by tightening the Allen-head screw.

## Install the Glass Shade

2C

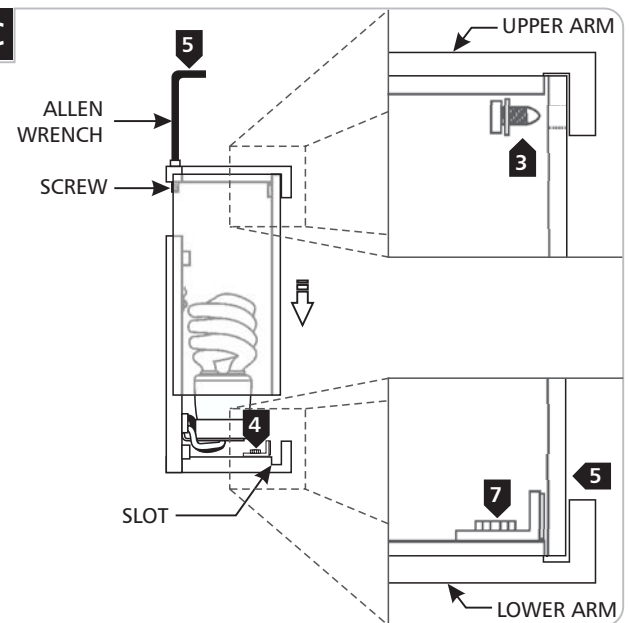

- 2 Remove the screw and washer from the upper arm.
- 3 Slide the screw with washer through the hole in the shade and screw it back into the upper arm.
- 4 Slightly loosen the thumbscrew in the lower arm.
- 5 Carefully slide the shade into the slot on the lower arm.
- 6 Tighten the Allen-head screw.
- 7 Reaching in from the bottom, push the shade support plate against the shade and tighten the thumbscrew.