







Location:



3522-B  
Tub/Shower System  
**Specification Submittal**

Model Numbers	Specification
<input type="checkbox"/> <b>3521-B</b> <i>Dia Tub/Shower System</i>	<p>Tub/shower system powered by the Temptrol® pressure-balancing valve. Features adjustable stop screw to limit handle turn, diverter tub spout, 1 mode showerhead with easy to clean rubber nozzles and standard 2.5 gpm (9.5 L/min) flow restrictor. Components made from metal and nonmetallic materials, plated in standard polished chrome finish.</p> <div style="text-align: right;">   </div>
<p><b>Modifications</b></p> <ul style="list-style-type: none"> <li><input type="checkbox"/> <b>-1.5</b>  <i>1.5 gpm (5.7 L/min) flow restrictor</i></li> <li><input type="checkbox"/> <b>-Delete Suffix B</b> <i>Nonmetallic chrome plated escutcheon in place of standard brass escutcheon</i></li> <li><input type="checkbox"/> <b>-SH2</b> <i>Round, 3 mode showerhead</i></li> <li><input type="checkbox"/> <b>-SH3</b> <i>Round, 1 mode showerhead</i></li> <li><input type="checkbox"/> <b>-SH4</b> <i>Square, 1 mode showerhead</i></li> <li><input type="checkbox"/> <b>-T2</b> <i>Square, diverter tub spout</i></li> <li><input type="checkbox"/> <b>-TRM</b> <i>Trim only, valve not included</i></li> </ul>	
	<p><b>Compliance</b></p>
	<p>-ASME A112.18.1/CSA B125.1</p> <div style="text-align: right;">  </div>
	<p><b>Warranty</b></p>
	<p><b>Limited Lifetime</b> - to the original end purchaser in consumer/residential installations.  <b>5 Years</b> - for industrial/commercial installations.  Refer to <a href="http://www.symmons.com/warranty">www.symmons.com/warranty</a> for complete warranty information.</p>

**Note:** Append appropriate -suffix to model number.

## Dimensions

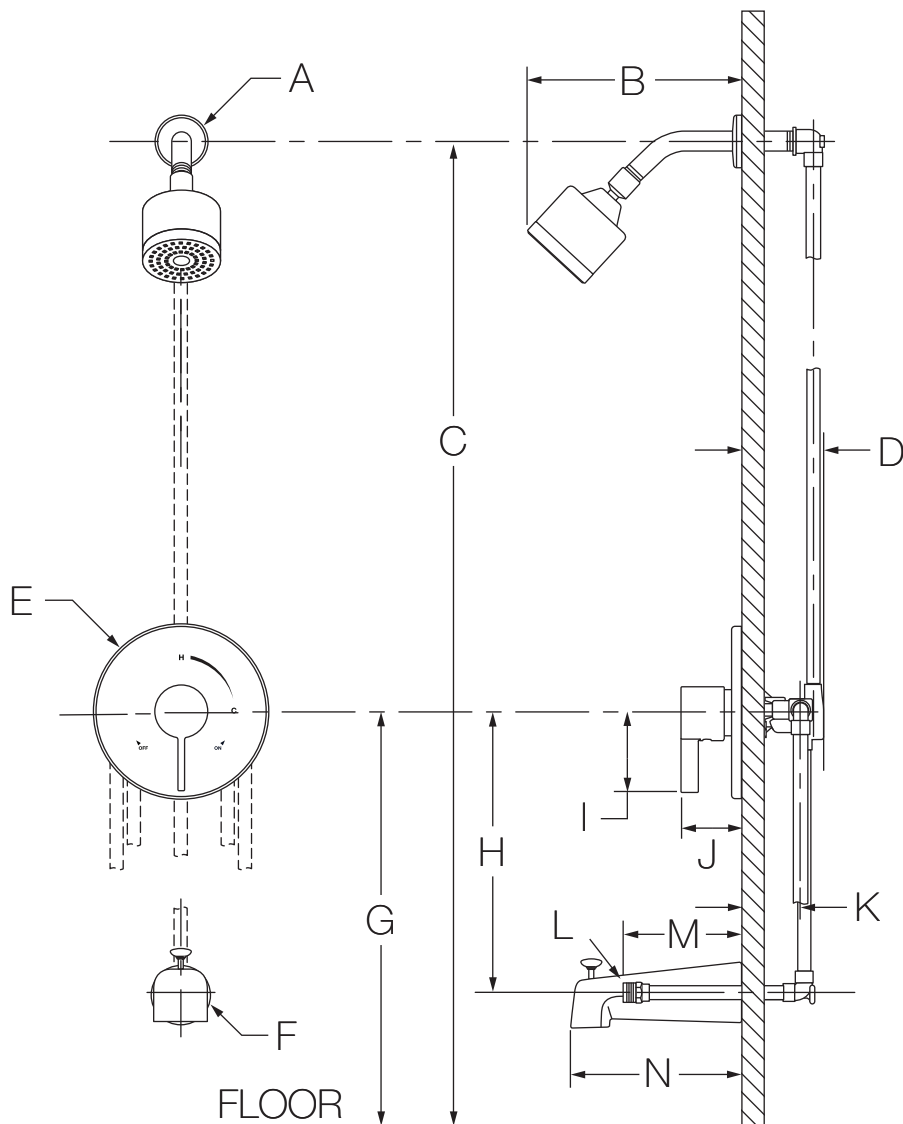

Measurements	
A	Ø 2-1/2", 64 mm
B	6-3/4", 171 mm
C	77", 1956 mm
D	3-1/2", 89 mm
E	Ø 7-1/2", 191 mm
F	Ø 2-1/2", 64 mm
G	32", 813 mm
H	12", 305 mm
I	3", 76 mm
J	2-7/8", 73 mm
K	Rough-in 2-3/8" ± 1/2", 60 mm ± 13 mm
L	Male 1/2-14 NPT fitting must protrude 5-1/2" (140 mm) from finished wall
M	5-1/2", 140 mm
N	7", 178 mm
O	6-3/4", 171 mm
P	6", 152 mm
Q	5-5/8", 143 mm
R	2-1/4", 57 mm
S	2-3/4", 70 mm
T	3/8", 10 mm
U	6-1/2", 165 mm
V	Female 1/2-14 NPSM fitting must be recessed 3/8" (10mm) from finished wall

**-SH2**

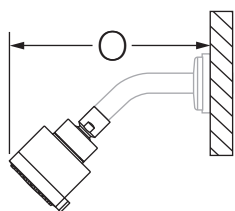

**-SH3**

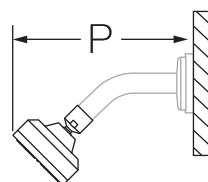

**-SH4**

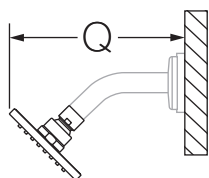
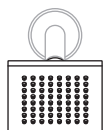

**-T2**

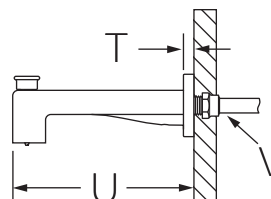
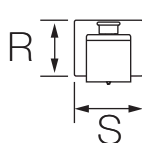

### Notes:

- 1) All dimensions measured from nominal rough-in (see K as reference).
- 2) Dimensions are subject to change without notice.