



## Single Chaise Assembly Instructions

**IMPORTANT : PLEASE READ COMPLETE INSTRUCTION SHEET PRIOR TO ASSEMBLY!**  
 Identify all parts packed in carton against the parts list. Remove all protective materials, place parts on a nonabrasive surface to avoid scratching. If any parts are missing or damaged, DO NOT attempt to assemble.

**Step 1: Place chaise on a flat, soft surface. Insert the plastic plate into the holes on the legs.**

**Step 2: Attach wheels with supplied bolts and metal washers and guaid bearing**  
 Put the plastic cap on the wheels.

**Step 3: Attach the chaise back to the chaise seat with supplied bolts and lock washers and metal washers and nuts.**

**Step 4: Cover all bolts with plastic bolt caps. Your chaise is now ready for use.**

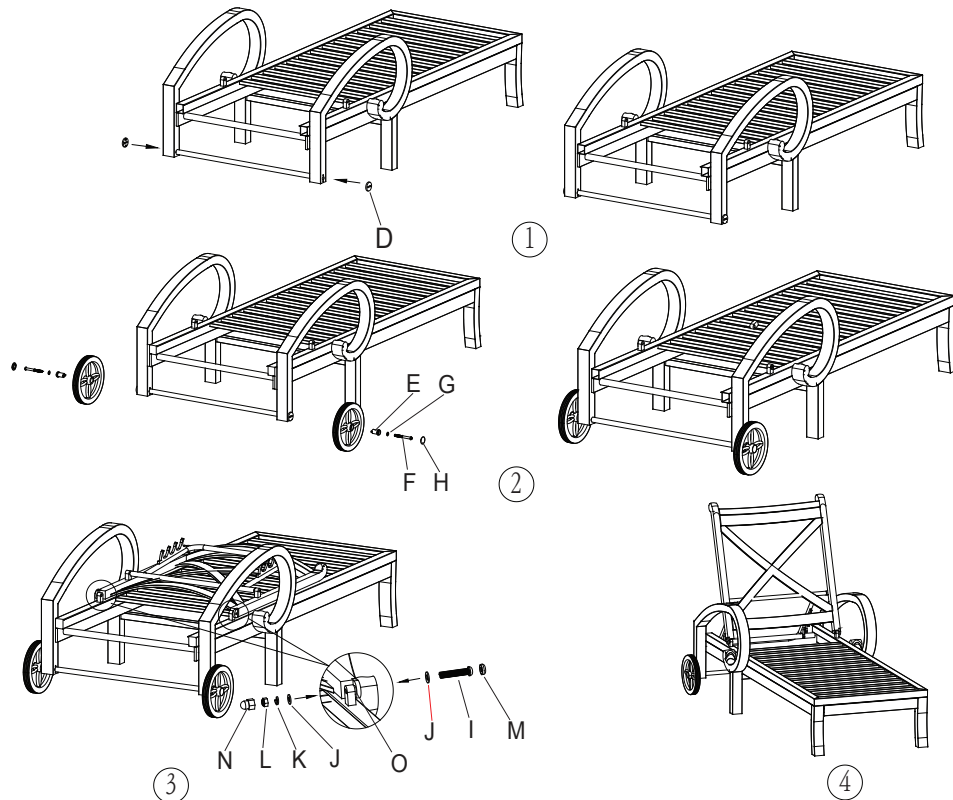

## PARTS LIST

A	CHAISE SEAT		1
B	CHAISE BACK		1
C	WHEEL		2
D	PLASTIC PLATE		2
E	GUAID BEARING		2
F	BOLT(M8*60)		2
G	METAL WAHSER(M8)		2
H	PLASTIC CAP		2
I	BOLT		2
J	METAL WASHER(M6)		4
K	LOCK WASHER(M6)		2
L	NUT(M6)		2
M	PLASTIC BOLT CAP		2
N	PLASTIC NUT CAP		2
O	PLASTIC WASHER		2
P	HEX WRENCH		1
Q	ALLEN WRENCH		1