

MOUNTING PLATE J95-P6T

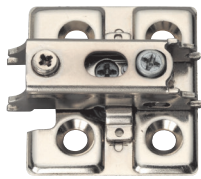

J95-P6T



Nickel (NI)

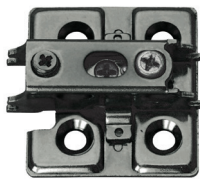

Black Nickel (BN)

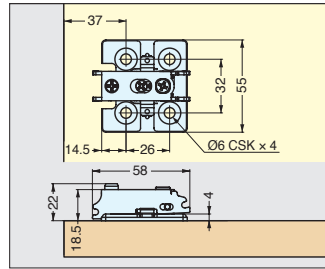

- Vertical adjustment: ± 3 mm ($\pm 1/8$ ").
- Overlay adjustment: $+0/-4$ mm ($\pm 5/32$ ").
- Depth adjustment: $+1.5/-2.5$ mm ($\pm 5/32$ ").
- Specify finish when ordering.

Item No.	Weight (g)	Box (pcs)	Carton (pcs)
J95-P6T-NI	94	10	100
J95-P6T-BN			

Material	Finish
Steel/Zinc Alloy	Nickel (NI), Black Nickel (BN)

MOUNTING PLATE COVER



J95ZC



Grey (GR)



Nickel (NI)



Black Chrome (BC)

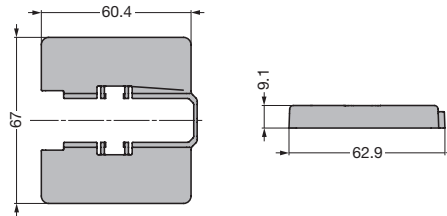

- Mounting plate cover for J95 series.
- Specify finish when ordering.



Nickel cover cap shown

Item No.	Weight (g)	Box (pcs)	Carton (pcs)
J95ZC-GR	9	100	1000
J95ZC-NI			
J95ZC-BC			

Material	Finish/Color
Plastic (ABS)	Grey (GR), Nickel (NI), Black Chrome (BC)

SAFETY COVER



J95SC

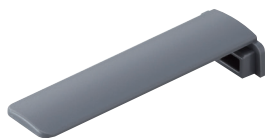

Grey (GR)



Nickel (NI)



Black Chrome (BC)

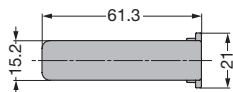

J95SC-25

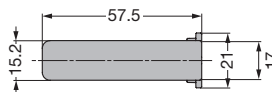

J95SC-16

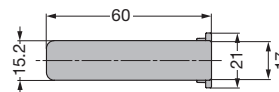

J95SC-0

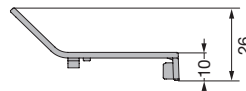
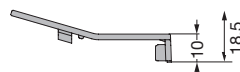
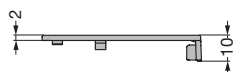

- Hinge safety cover for J95 series.
- Specify finish when ordering.

■ The cover locks the release lever of J95 hinge for drop out prevention

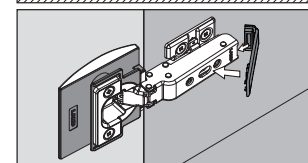
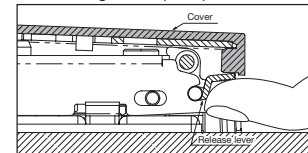

Item No.	Weight (g)	Box (pcs)	Carton (pcs)
J95SC-25GR	3	100	1000
J95SC-25NI			
J95SC-25BC			
J95SC-16GR	3	100	1000
J95SC-16NI			
J95SC-16BC			
J95SC-0GR	3	100	1000
J95SC-0NI			
J95SC-0BC			

Material	Finish/Color
Plastic (ABS)	Grey (GR), Nickel (NI), Black Chrome (BC)