

# HEAVY DUTY CONCEALED HINGE (25mm OVERLAY) J95-24/25T, J95-C24/25T

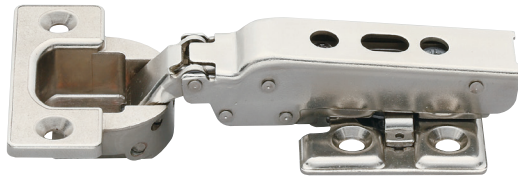

- Load capacity: 25 kg (55lbs) / 2pcs, 40kg (88lbs) / 3pcs.
- Maximum door width: 800mm (31-1/2") / 2pcs, 900mm (35-7/16") / 3pcs.
- Clip on type for easy installation.
- 3-way adjustment with door installed.
- Requires 6 M5 or equivalent (US#10) screws: 2 pcs for each hinge, and 4 pcs for each mounting plate.
- Optional: hinge cover (J95SC-25GR), and mounting plate cover (J95ZC-GR) available.
- Glass face plate (GH-J95FP) also available.

[Wood]

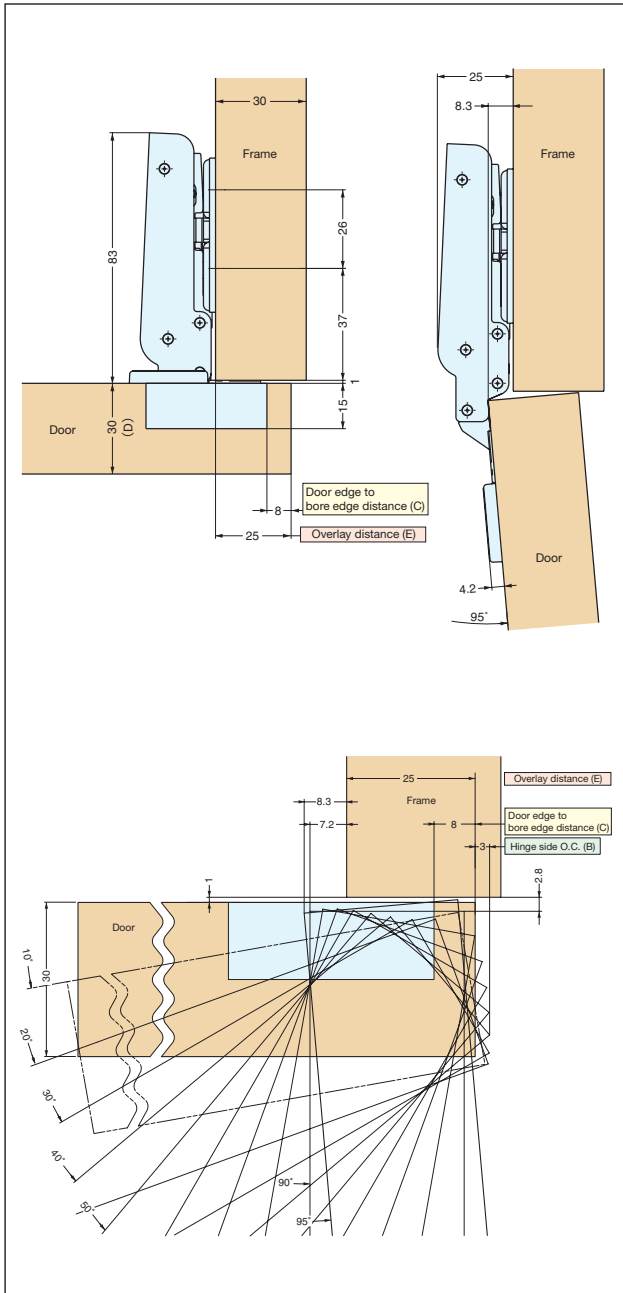

J95ZC-GR  
Mounting Plate Cover  
Sold Separately

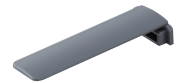

J95SC-25GR  
Safety Cover  
Sold Separately

■ Door edge to bore edge distance (C) and Overlay distance (E) Table 1.

Door edge to bore edge distance (C)	3	4	5	6	7	8
Overlay distance (E)	20	21	22	23	24	25

■ Hinge side opening clearance chart Table 2.

Door thickness (D)	Door edge to bore edge distance (C)					
	3	4	5	6	7	8
18	0.3	0.3	0.3	0.3	0.3	0.3
20	0.5	0.5	0.5	0.5	0.5	0.5
22	0.8	0.8	0.8	0.7	0.7	0.7
24	1.1	1.1	1.1	1.1	1.1	1.1
26	1.7	1.6	1.6	1.5	1.5	1.5
28	3.2	2.8	2.5	2.2	2.1	2.0
30	5.0	4.5	4.0	3.6	3.3	3.0
32	6.8	6.2	5.7	5.2	4.8	4.4
34	8.6	8.0	7.5	6.9	6.5	6.0
Hinge side O.C. (B)						

\*Mounting Plate sold separately.

\*If the door thickness is over 30mm (1-3/16") the door will need to be chamfered.

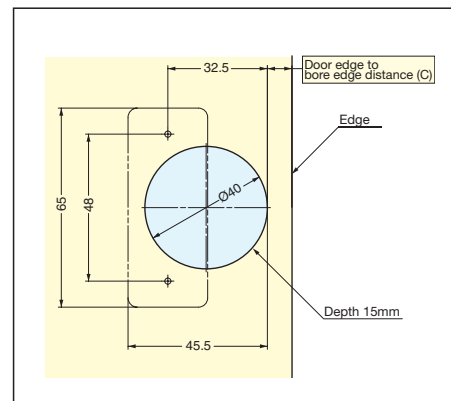

Bore Dimensions

Item No.	Type	Weight (g)	Carton (pcs)
J95-24/25T	Free Swing	131	100
J95-C24/25T	Self-Closing	143	

Material	Finish
Steel	Nickel

\*Requires J95-P6T Mounting plate sold separately

# HEAVY DUTY CONCEALED HINGE (25mm OVERLAY)



# J95-24/25T, J95-C24/25T

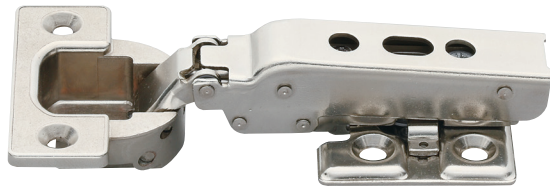

- Load capacity: 25 kg (55lbs) / 2pcs, 35kg (77lbs) / 3pcs.
- Maximum door width: 800mm (31-1/2") / 2pcs.
- Clip on type for easy installation.
- 3-way adjustment with door installed.
- Requires 6 M5 or equivalent (US#10) screws: 2 pcs for each hinge, and 4 pcs for each mounting plate.
- Optional: hinge cover (J95SC-25GR) and mounting plate cover (J95ZC-GR) available.
- Glass faceplate (GH-J95FP) required for glass door application.

[Glass]

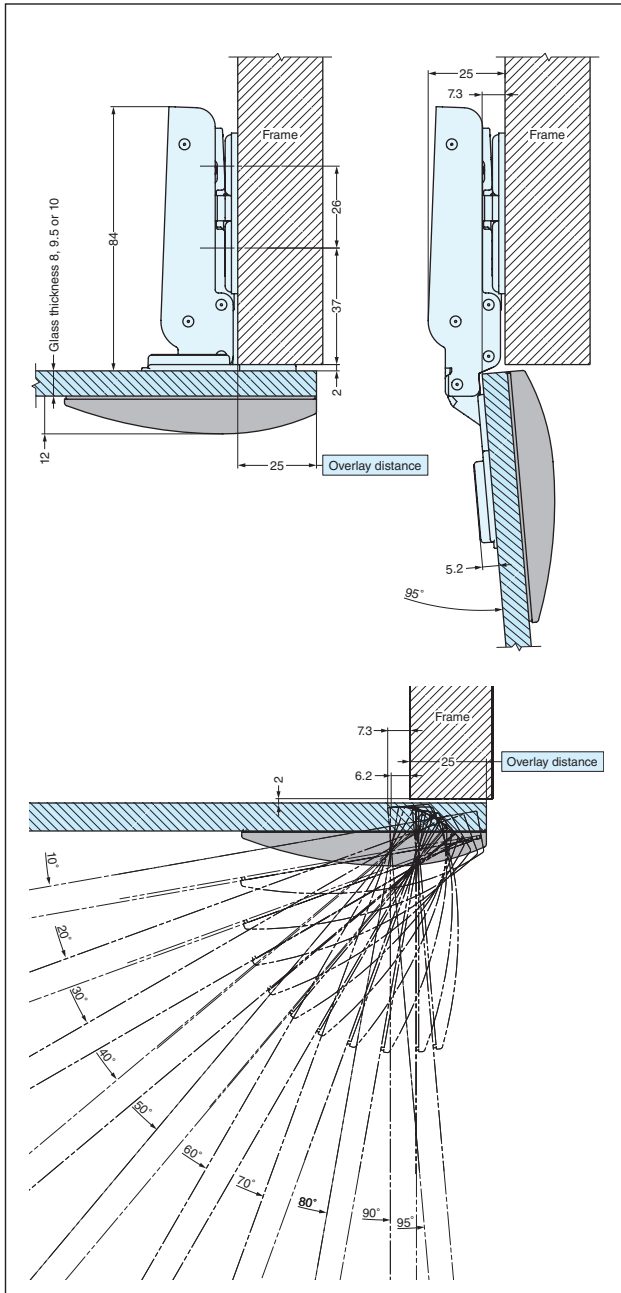

GH-J95FP  
Glass Face Plate  
Sold Separately



J95ZC-GR  
Mounting Plate Cover  
Sold Separately

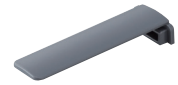

J95SC-25GR  
Safety Cover  
Sold Separately

■ Hinge side opening clearance chart

Glass thickness (D)	Hinge side O.C.
8	0
9.5 (3/8")	0
10	0

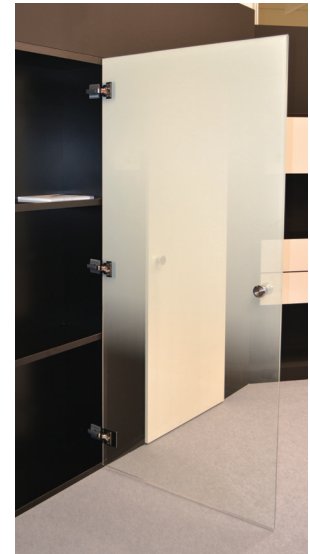

Bore Dimensions

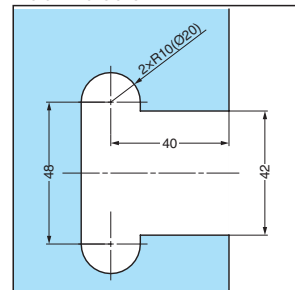

■ Glass thickness 8mm

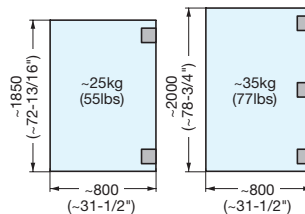

■ Glass thickness 10mm

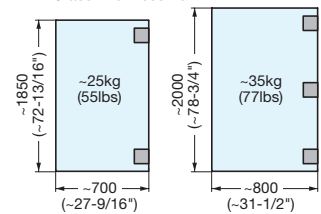

Item No.	Type	Weight (g)	Carton (pcs)
J95-24/25T	Free Swing	131	100
J95-C24/25T	Self-Closing	143	

Material	Finish
Steel	Nickel

\*For a complete glass hinge set, you must order: J95 hinge + J95-P6T mounting plate + GH-J95FP faceplate.

# HEAVY DUTY CONCEALED HINGE (16mm OVERLAY)



# J95-24/16T, J95-C24/16T



- Load capacity: 25 kg (55lbs) / 2pcs, 40kg (88lbs) / 3pcs.
- Maximum door width: 800mm (31-1/2") / 2pcs, 900mm (35-7/16") / 3pcs.
- Clip on type for easy installation.
- 3-way adjustment with door installed.
- Requires 6 M5 or equivalent (US#10) screws: 2 pcs for each hinge, and 4 pcs for each mounting plate.
- Optional hinge cover (J95SC-16GR) and mounting plate cover (J95ZC-GR) available.
- Glass face plate (GH-J95FP) also available.

[Wood]

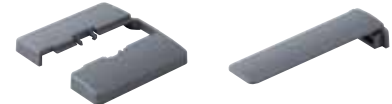
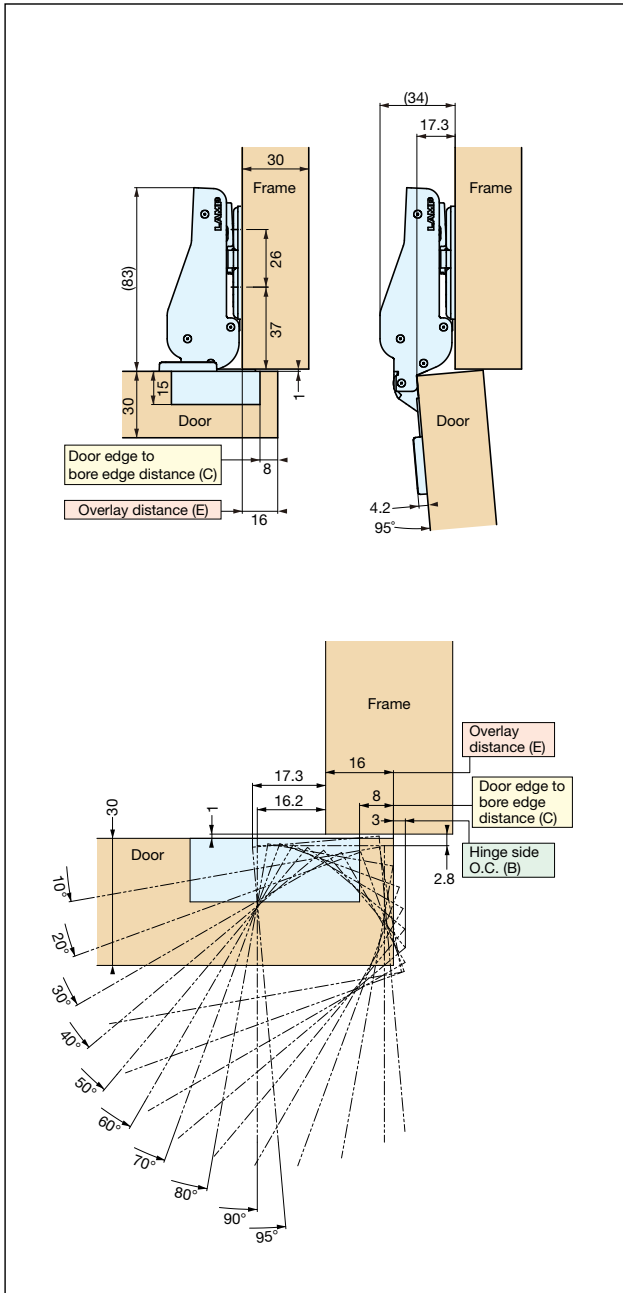

J95ZC-GR  
Mounting Plate Cover  
Sold Separately

☆J95SC-25GR  
Pictured above  
J95SC-16GR  
Safety Cover  
Sold Separately

■ Door edge to bore edge distance (C) and Overlay distance (E) Table 1.

Door edge to bore edge distance (C)	3	4	5	6	7	8
Overlay distance (E)	11	12	13	14	15	16

■ Hinge side opening clearance chart Table 2.

Door thickness (D)	Door edge to bore edge distance (C)					
	3	4	5	6	7	8
18	0.3	0.3	0.3	0.3	0.3	0.3
20	0.5	0.5	0.5	0.5	0.5	0.5
22	0.8	0.8	0.8	0.7	0.7	0.7
24	1.1	1.1	1.1	1.1	1.1	1.1
26	1.7	1.6	1.6	1.5	1.5	1.5
28	3.2	2.8	2.5	2.2	2.1	2.0
30	5.0	4.5	4.0	3.6	3.3	3.0
32	6.8	6.2	5.7	5.2	4.8	4.4
34	8.6	8.0	7.5	6.9	6.5	6.0
Hinge side O.C. (B)						

\*Mounting Plate sold separately.

\*If the door thickness is over 30mm (1-3/16") the door will need to be chamfered.

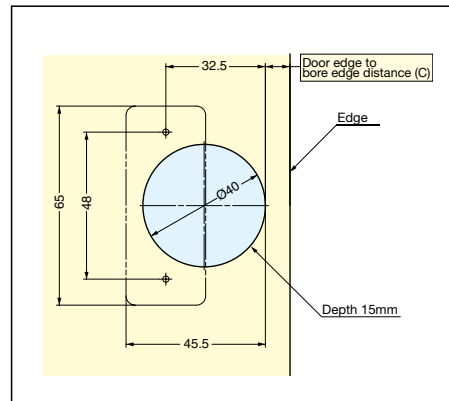

Bore Dimensions

Item No.	Type	Weight (g)	Carton (pcs)
J95-24/16T	Free Swing	131	50
J95-C24/16T	Self-Closing	143	

Material	Finish
Steel	Nickel

\*Requires J95-P6T Mounting plate sold separately

HEAVY DUTY CONCEALED HINGE (16mm OVERLAY)



J95-24/16T, J95-C24/16T



- Load capacity: 25 kg (55lbs) / 2pcs, 35kg (77lbs) / 3pcs.
- Maximum door width: 800mm (31-1/2") / 2pcs.
- Clip on type for easy installation.
- 3-way adjustment with door installed.
- Requires 6 M5 or equivalent (US#10) screws: 2 pcs for each hinge, and 4 pcs for each mounting plate.
- Optional hinge cover (J95SC-16GR) and mounting plate cover (J95ZC-GR) available.
- Glass face plate (GH-J95FP) also available.

[Glass]

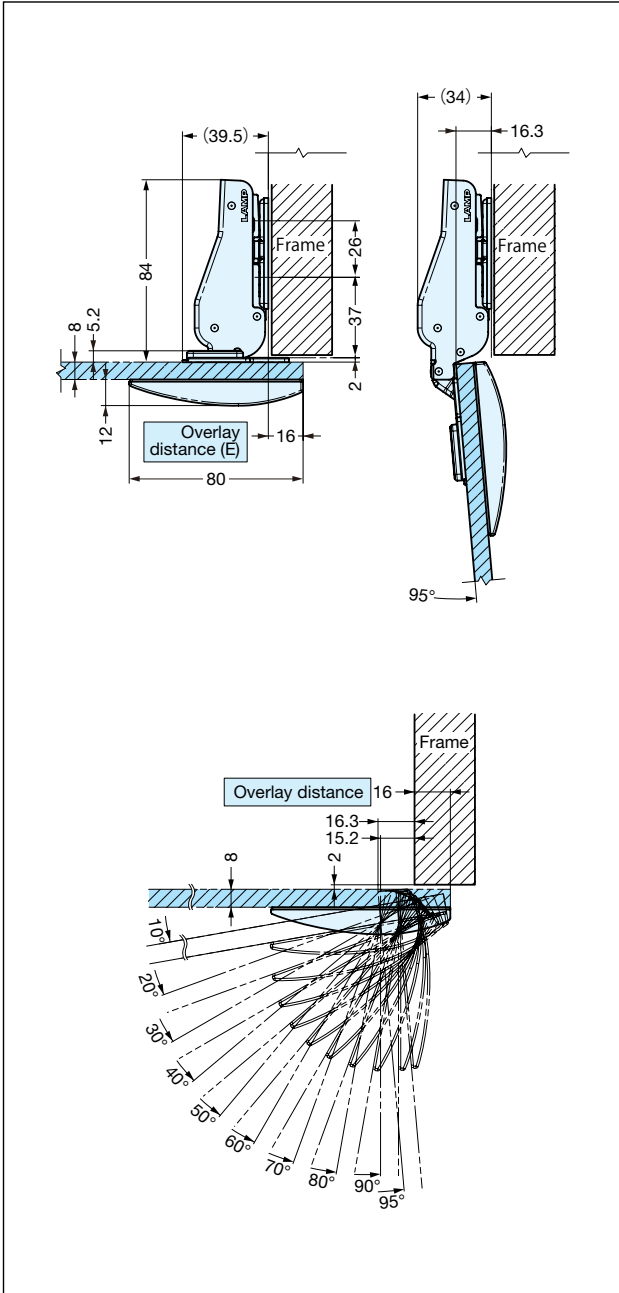

GH-J95FP  
Glass Face Plate  
Sold Separately



J95ZC-GR  
Mounting Plate Cover  
Sold Separately



☆J95SC-25GR  
Pictured above  
J95SC-16GR  
Safety Cover  
Sold Separately

■ Hinge side opening clearance chart

Glass thickness (D)	Hinge side O.C.
8	0
9.5 (3/8")	0
10	0

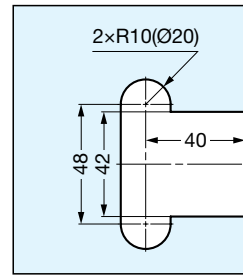

Bore Dimensions

■ Glass thickness 8mm

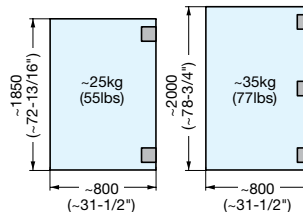

■ Glass thickness 10mm

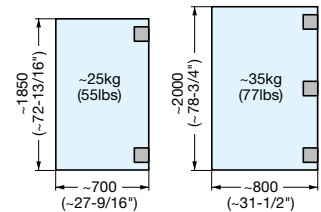

Item No.	Type	Weight (g)	Carton (pcs)
J95-24/16T	Free Swing	131	50
J95-C24/16T	Self-Closing	143	

Material	Finish
Steel	Nickel

\*Requires J95-P6T Mounting plate sold separately

# HEAVY DUTY CONCEALED HINGE (INSET)



## J95-24/0T, J95-C24/0T



- Load capacity: 25 kg (55lbs) / 2pcs, 40kg (88lbs) / 3pcs.
- Maximum door width: 800mm (31-1/2") / 2pcs, 900mm (35-7/16") / 3pcs.
- Clip on type for easy installation.
- 3-way adjustment with door installed.
- Requires 6 M5 or equivalent (US#10) screws: 2 pcs for each hinge, and 4 pcs for each mounting plate.
- Optional hinge cover (J95SC-0GR) and mounting plate cover (J95ZC-GR) available.
- Glass face plate (GH-J95FP) also available.

[Wood]

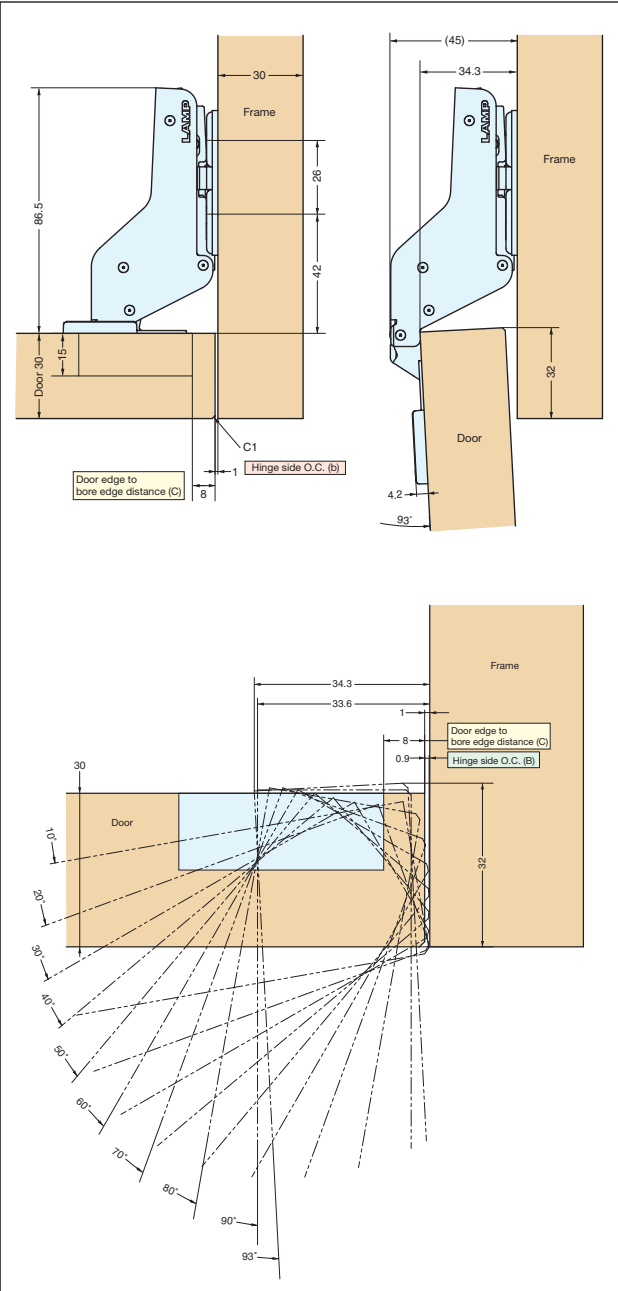

J95ZC-GR  
Mounting Plate Cover  
Sold Separately

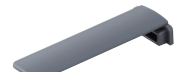

\*J95SC-25GR  
pictured above  
J95SC-0GR  
Safety Cover  
Sold Separately

■ Door edge to bore edge distance (C) and Hinge side O.C. (b) Table 1.

Door edge to bore edge distance (C)	3	4	5	6	7	8
Hinge side O.C. (b)	6	5	4	3	2	1

■ Hinge side opening clearance chart Table 2.

Door thickness (D)	Door edge to bore edge distance (C)					
	3	4	5	6	7	8
18	0	0	0	0	0	0
20	0	0	0	0	0	0
22	0.1	0.1	0.1	0.1	0.1	0.1
24	0.1	0.1	0.1	0.1	0.1	0.1
26	0.3	0.3	0.3	0.3	0.3	0.3
28	1.7	1.1	0.6	0.5	0.5	0.5
30	3.5	2.9	2.3	1.8	1.0	0.9
32	5.4	4.7	4.1	3.6	3.0	2.5
34	7.3	6.0	6.0	5.4	4.8	4.3
Hinge side O.C. (B)						

\*If the door thickness is over 30mm (1-3/16") the door will need to be chamfered.

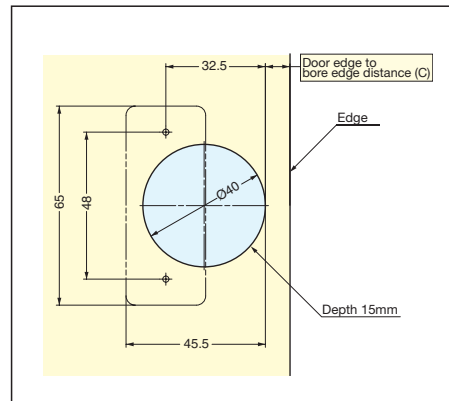

Bore Dimensions

Item No.	Type	Weight (g)	Carton (pcs)
J95-24/0T	Free Swing	143	50
J95-C24/0T	Self-Closing	160	

Material	Finish
Steel	Nickel

\*Requires J95-P6T Mounting plate sold separately

# HEAVY DUTY CONCEALED HINGE (INSET)



## J95-24/0T, J95-C24/0T



- Load capacity: 25 kg (55lbs) / 2pcs, 40kg (88lbs) / 3pcs.
- Maximum door width: 800mm (31-1/2") / 2pcs.
- Clip on type for easy installation.
- 3-way adjustment with door installed.
- Requires 6 M5 or equivalent (US#10) screws: 2 pcs for each hinge, and 4 pcs for each mounting plate.
- Optional hinge cover (J95SC-0GR) and mounting plate cover (J95ZC-GR) available.
- Glass face plate (GH-J95FP) required for glass door application.

[Glass]

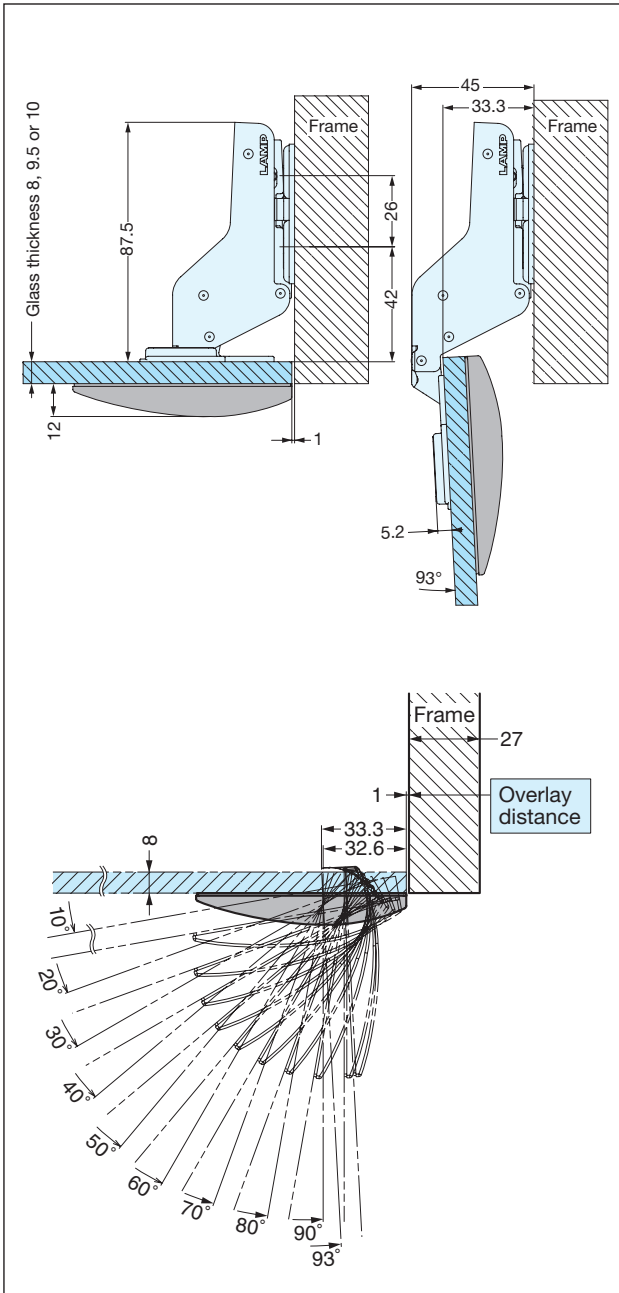

GH-J95FP  
Glass Face Plate  
Sold Separately



J95ZC-GR  
Mounting Plate Cover  
Sold Separately



\*J95SC-25GR  
pictured above  
J95SC-0GR  
Safety Cover  
Sold Separately

■ Hinge side opening clearance chart

Glass thickness (D)	Hinge side O.C.
8	0
9.5 (3/8")	0
10	0

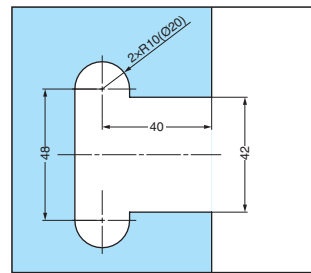
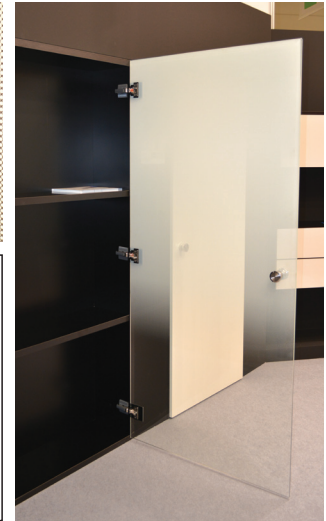
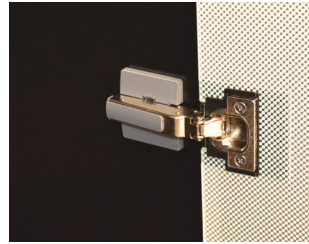

Bore Dimensions

■ Glass thickness 8mm

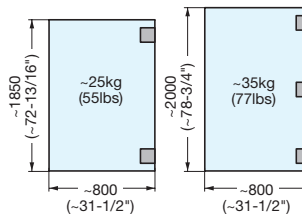

■ Glass thickness 10mm

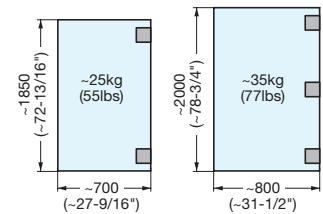

Item No.	Type	Weight (g)	Carton (pcs)
J95-24/0T	Free Swing	148	50
J95-C24/0T	Self-Closing	160	

Material	Finish
Steel	Nickel

\*For a complete glass set, you must order: J95 hinge + J95-P6T mounting plate + GH-J95FP faceplate.

## MOUNTING PLATE J95-P6T



## J95-P6T

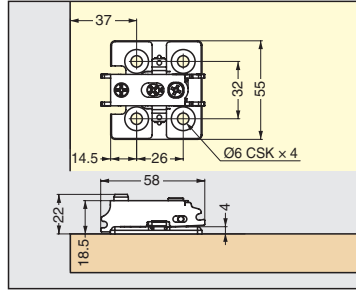
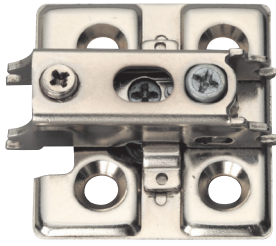

- Vertical adjustment:  $\pm 3\text{mm}$  ( $\pm 1/8''$ )
- Overlay adjustment:  $+0/-4\text{mm}$  ( $\pm 5/32''$ )
- Depth adjustment:  $+1.5/-2.5\text{mm}$  ( $\pm 5/32''$ )

Item No.	Weight (g)	Carton (pcs)	Material	Finish
J95-P6T	94	100	Steel / Zinc Alloy	Nickel

## MOUNTING PLATE COVER



## J95ZC-GR

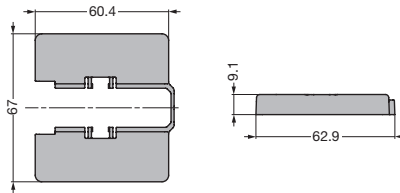

Item Name	Material	Color	Weight (g)	Box (pcs)	Carton (pcs)
J95ZC-GR	ABS	Gray	9	100	1000

## SAFETY COVER



## J95SC-GR

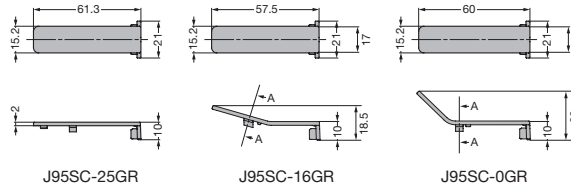

- The cover locks the release lever of J95 hinge for drop out prevention

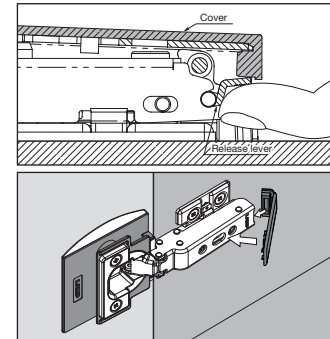

Item Name	Material	Color	Weight (g)	Box (pcs)	Carton (pcs)
J95SC-25GR	ABS	Gray	3	100	1000
J95SC-16GR					
J95SC-0GR					

## GLASS FACEPLATE FOR J95 SERIES



## GH-J95FP

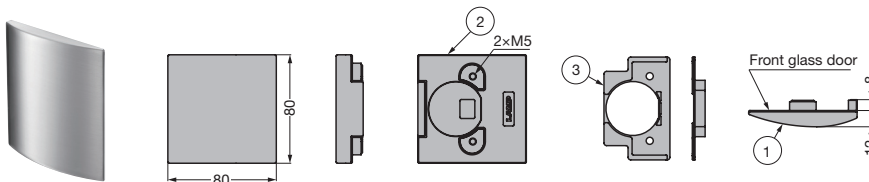

GH-J95FP-CR



Item Name	Weight (g)	Box (pcs)	Carton (pcs)	No.	Part Name	Material	Finish
GH-J95FP/CR	320	1	20	①	Face plate	ZDC	Chrome
				②	Face plate spacer	POM	
				③	Socket spacer		Black