

Homeowners Guide

Bypass Shower Doors

SP5100 Series

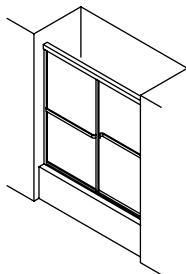

Thank You For Choosing Sterling

We appreciate your commitment to Sterling value. Please take a few minutes to review this manual before using your new shower door. If you encounter any performance problems, please don't hesitate to contact us. Our phone numbers are listed on the back cover. Thanks again for choosing Sterling.

Your Sterling Shower Door

Your new Sterling shower door is designed to withstand the rigors of daily use. The combination of durability, long-lasting performance and simple, timeless elegance will provide you with years of stylish service.

Care and Cleaning Instructions

Glass Surfaces:

Use a squeegee to clean your glass door surfaces after showering. Do not use a bristle brush or abrasive sponges, as they will scratch some glass surfaces. Never use abrasive cleansers, and do not allow cleaners to sit or soak on surfaces. Please use only the following cleaning products on your shower door's glass surfaces: Formula 409®, Glass and Surface Citrus Scent, Glass Plus®, and Windex ® Original.

Finished, Metallic or Painted Surfaces:

Never use cleaners containing abrasive cleansers, ammonia, bleach, acids, waxes, alcohol, or solvents for cleaning, as they may damage the finish. By taking the time to dry your shower door after each use, you can prevent soap and water deposits from forming. Failure to comply with these cleaning instructions may void Sterling's warranty obligations.

Limited Warranty

Bath Exclusives™ — 5 Years Limited

Based on the classification specified above, Sterling Plumbing, a division of Kohler Co., (Sterling) bath and shower doors are warranted to be free of manufacturing defects within the time of the specified model's limited warranty from date of sale.

Sterling will, at its election, repair, rectify or replace a fixture when Sterling's inspection discloses any such defects occurring in normal usage within the time period of coverage stated above. Sterling is not responsible for removal or installation costs where replacement is indicated. Damages due to improper handling, installation or maintenance are not considered manufacturing defects and are not covered by this warranty. This warranty is valid for the original consumer purchaser only.

To obtain warranty service, contact Sterling, either through your plumbing contractor, home center, wholesaler or dealer, or by calling or writing Sterling Plumbing, Consumer Services, 444 Highland Drive, Kohler, Wisconsin 53044, 1-888-783-7546.

To the extent permitted by law, all implied warranties including those of merchantability and fitness for a particular purpose are hereby disclaimed. Sterling disclaims any liability for special, incidental, or consequential damages. Some states/provinces do not allow limitations on how long an implied warranty lasts, or the exclusion or limitation of special, incidental or consequential damages, so these limitations and exclusions may not apply to you. This warranty gives you specific legal rights. You may have other rights which vary from state/province to state/province.

This is our exclusive written warranty.

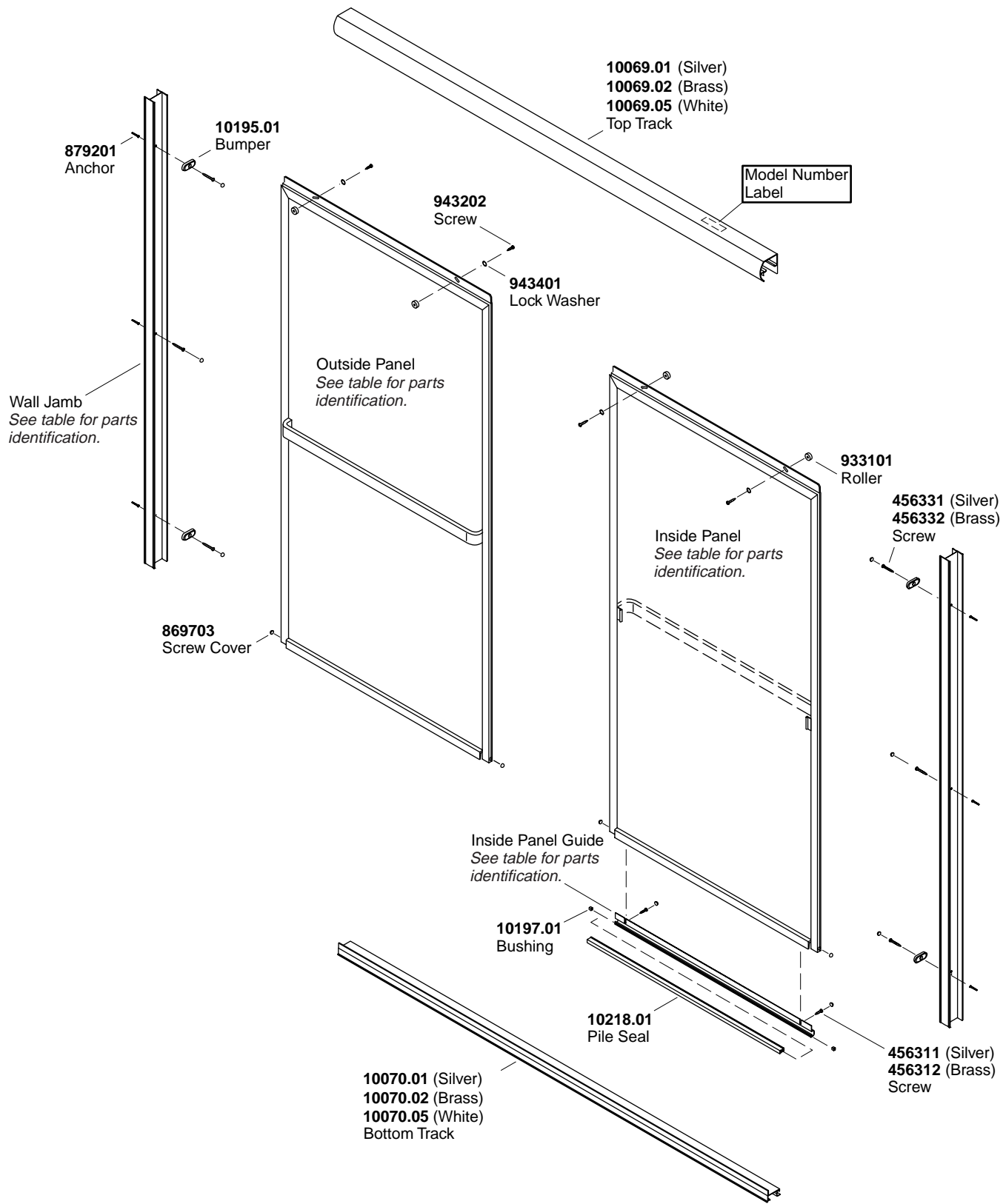

****Finish/color code must be specified when ordering.**

Service Parts

Service Parts Table

Part Number For Model	Outside Panel	Inside Panel	Wall Jamb	Inside Panel Guide
SP5126-55PB	10207.34	10208.34	10409.02	10075.12
SP5126-55S	10207.33	10208.33	10409.01	10075.11
SP5126-55W	10207.35	10208.35	10409.03	10075.13
SP5165-45W	10207.38	10208.38	10366.03	10075.17
SP5166-45PB	10207.26	10208.26	10366.02	10075.10
SP5166-45S	10207.25	10208.25	10366.01	10075.09
SP5166-45W	10207.41	10208.41	10366.03	10075.17
SP5175-57PB	10207.43	10208.43	10366.05	10075.15
SP5175-57S	10207.42	10208.42	10366.04	10075.14
SP5176-57PB	10207.46	10208.46	10366.05	10075.15
SP5176-57S	10207.45	10208.45	10366.04	10075.14
SP5176-57W	10207.47	10208.47	10366.06	10075.16

USA: 1-888-STERLING

SterlingPlumbing.com



©2004 Sterling Plumbing

1034036-5-B