

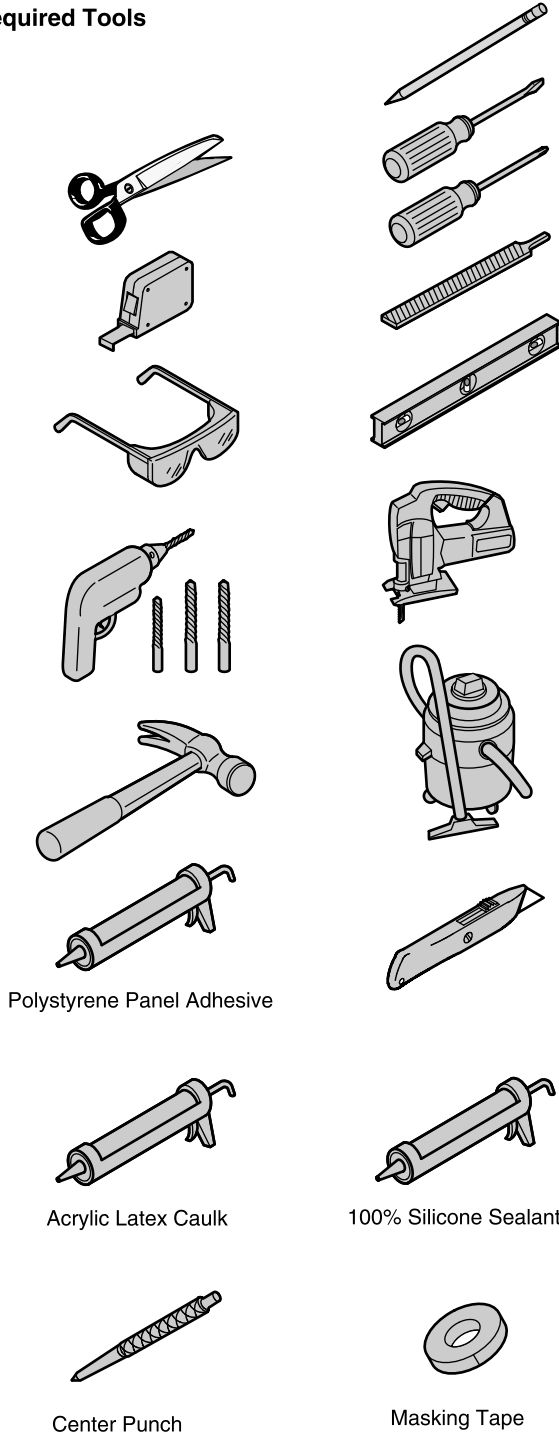

⚠ WARNING: Risk of serious injury.
Always wear safety glasses while cutting and drilling.

Read these instructions before installing or using this product.

Required Tools



Parts Identification

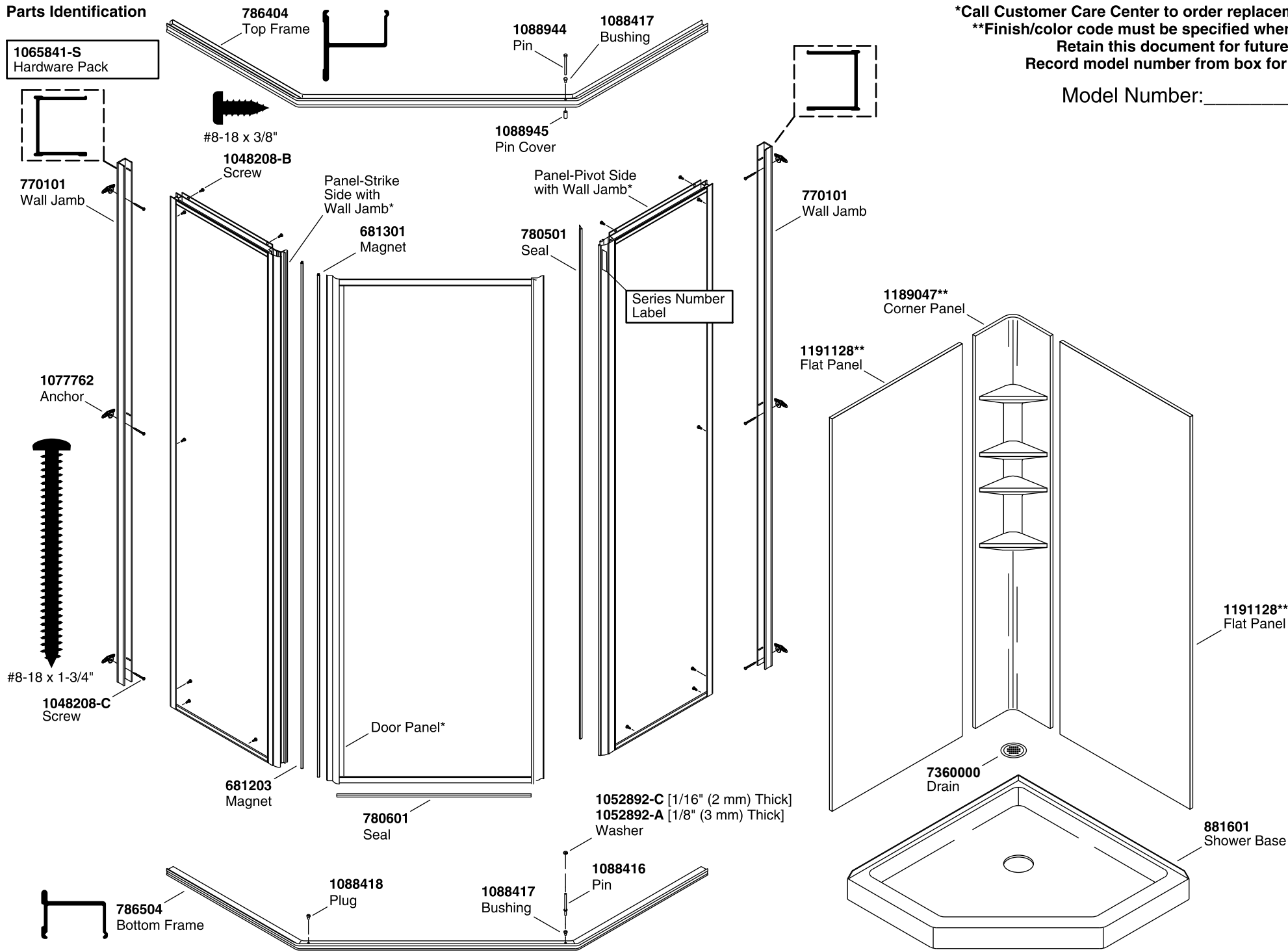

Model Number: _____

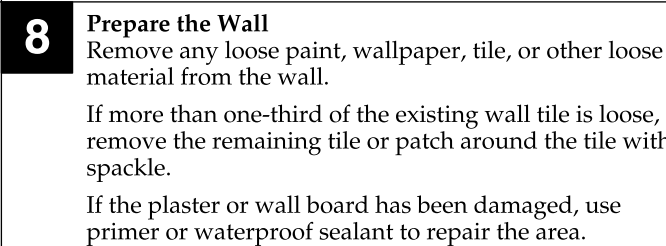
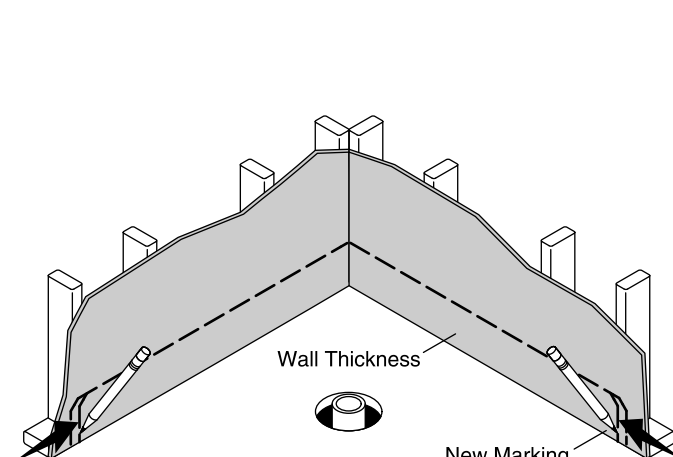

IMPORTANT: Do not apply panel adhesive to the glossy side. Adhesive must be applied to the dull side. If adhesive is applied to the wrong side, remove with mineral spirits or paint thinner.

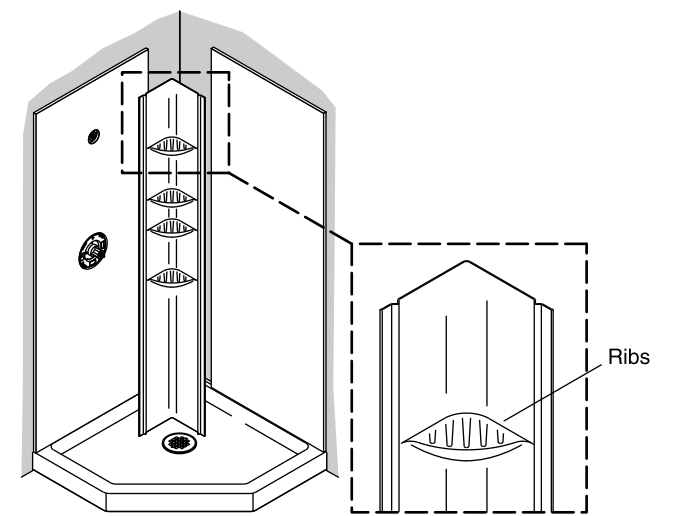
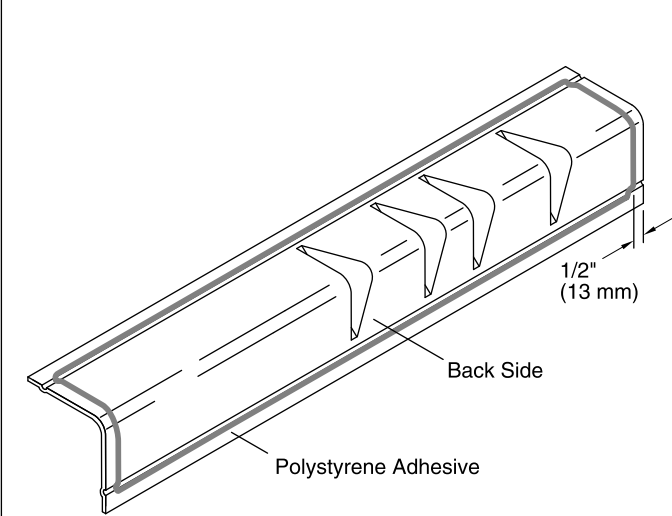
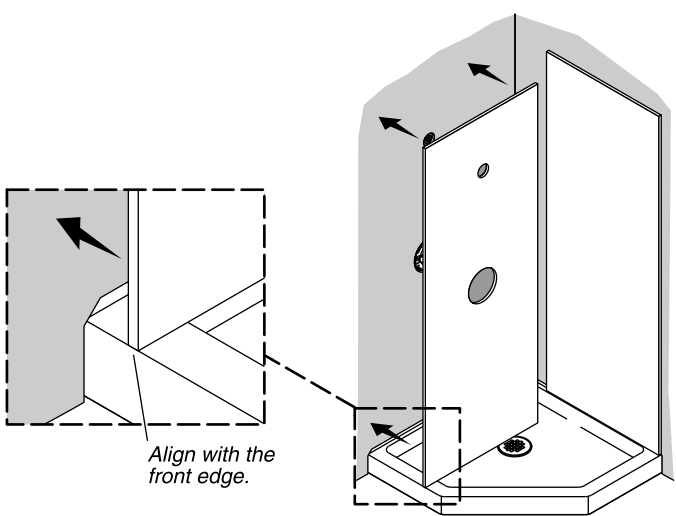
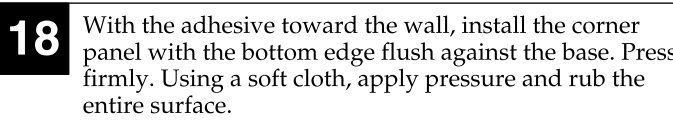
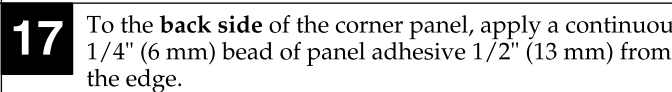
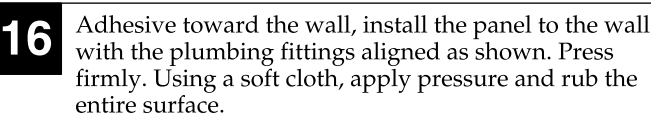
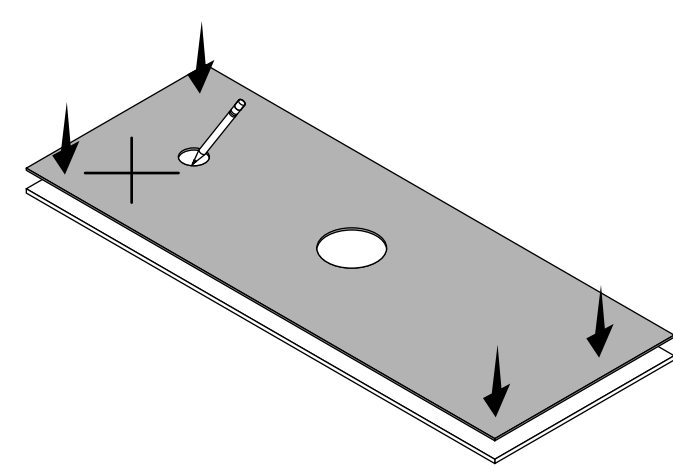
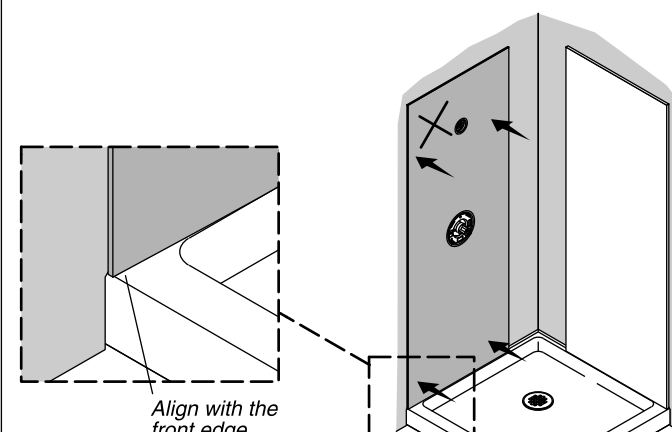
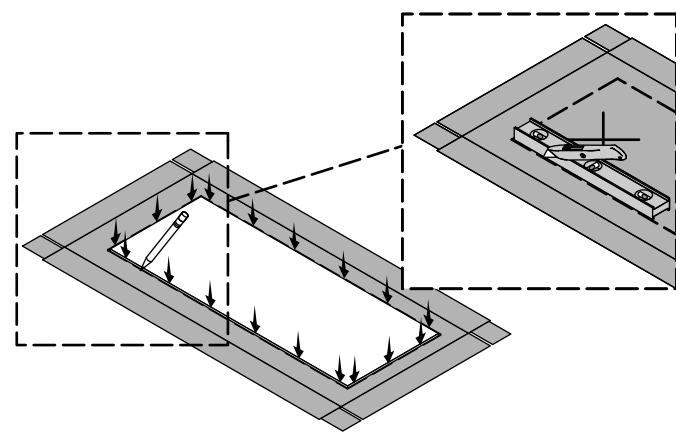
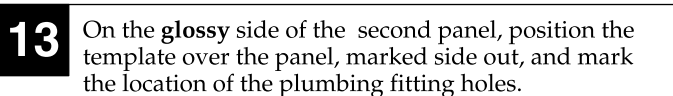
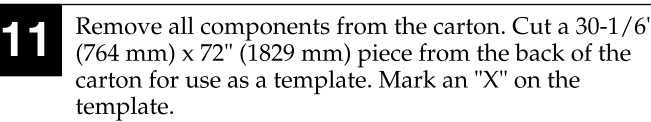
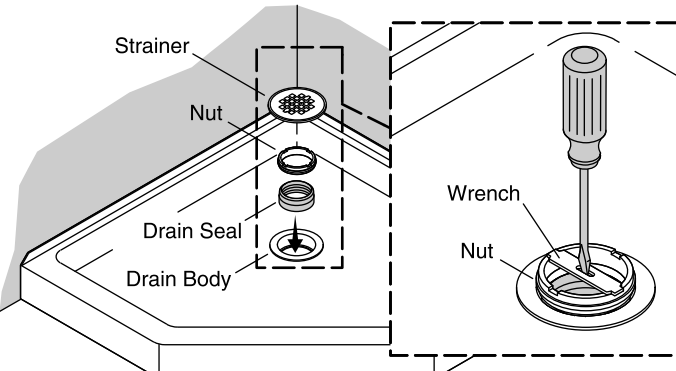

19 Apply a 3/16" (5 mm) bead of acrylic latex caulk at the locations shown.

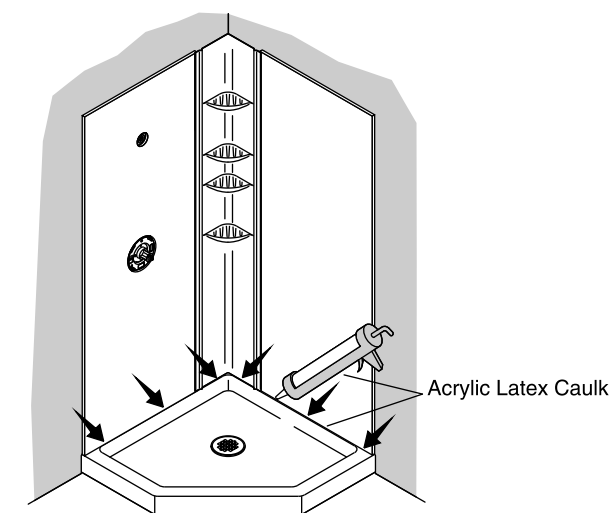

A schematic diagram of a pressure chamber. Arrows indicate air pressure being applied from the outside to the chamber walls. Inside the chamber, a sample is shown being compressed by a central piston and four side pistons. A label 'Silicone Sealant' points to the seal between the chamber wall and the internal components.

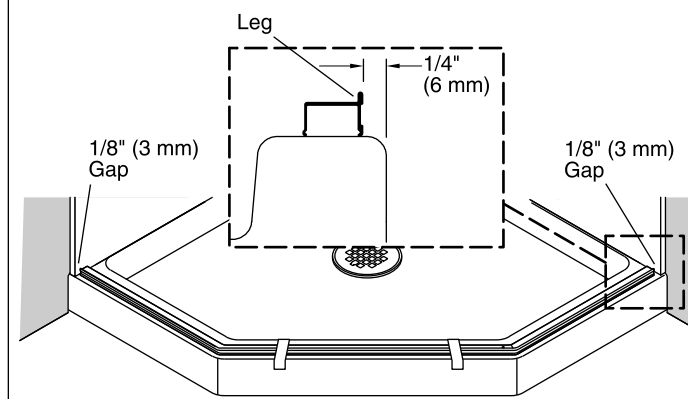

x2

Silicone Sealant

Front Edge

Slot

Left Pivot **Right Pivot**

Showerhead Showerhead

Pivot Side Pivot Side

120° 23-1/4" (591 mm) 120°

Diagram illustrating the installation of the Pivot Side Fixed Panel. The panel is shown being secured to the Wall Jamb using Screws. The screws are specified as #8-18 x 3/8". A Top View inset shows the panel's profile and the location of the screws. The panel is labeled as the Pivot Side Fixed Panel.

Side View

Leg

Screws

#8-18 x 3/8"

Bushing

Pivot Side

Diagram illustrating the installation of the pivot pin and bushing into the door frame. The components shown are the 1/8" Nylon Washer, Pivot Pin, Bushing, and Plug. The diagram shows the pivot pin being inserted into the door frame, with the bushing and washer positioned above it. The plug is shown being inserted into the door frame to secure the pivot pin.

Diagram illustrating the correct installation of the vinyl seal on the shower door frame. The seal is shown seated in the groove, preventing water from leaking into the shower area. Labels include: Groove, Vinyl Seal, and Inside of the Shower.

The diagram illustrates the installation of a pivot pin and bushing into the shower door frame. The main view shows a corner of a shower enclosure with a door panel. A dashed box highlights the area where the pivot pin is installed. An inset diagram provides a detailed view of the installation process, showing a 'Top Pivot Pin' being inserted into a 'Bushings' hole in the frame. The 'Pivot Pin Cover' is also shown, which is a small cap that fits over the top of the pin.

The diagram illustrates the installation of a top pivot pin and pivot hole. It shows a cross-section of a window blind with a top pivot pin being inserted into a pivot hole. Labels include 'Top Pivot Pin' and 'Pivot Hole'.

A technical diagram showing a cross-section of a window frame and sash. The sash is shown in a partially open position, revealing the internal components. A dashed line indicates the closed position. A callout box provides a detailed view of the seal assembly, showing the 'Front' of the sash and the 'Vinyl Seal' that fits into the frame's channel.

Symptom: Installation	Recommended Action
-----------------------	--------------------

Recommended Action

- A. Loosen the nearest door panel screw. Pull the door panel frame away from the glass far enough to allow the pin to pass through. Retighten the screw.

- A. Remove the strike side header screw. Lift the header slightly. Insert the top pin.

- A. The bottom track is upside down. Remove the components as needed and return to step 21. Turn the bottom track over and repeat the required installation steps.

Recommended Action

- A. Adjust the door panel to increase the gap between the door panel and the bottom track. Add a washer to the bottom pivot pin as shown in step 35.

- Adjust the door panel to increase the gap between the door panel and the strike jamb.
- Adjust the strike jamb so the door panel makes contact with the strike jamb magnet.
- Trim the ends of the seal to be flush with the door.

Recommended Action

- A. From outside the shower, apply silicone sealant where the fixed glass panel meets the bottom frame.

- A. From outside the shower, apply silicone sealant where the fixed glass panel frame meets the wall jamb.

- A. Verify the seal is in place. See step 34.

- A. Adjust the door to decrease the gap between the door panel and the strike jamb.

- B. Adjust the strike jamb so the door panel makes contact with the strike jamb magnet.

5 YEARS LIMITED
5100 Series, 5300 Series, 5400 Series, 6300 Series, 6500 Series

3 YEARS LIMITED
1500 Series, 1900 Series, 2200 Series, 5900 Series

1 YEAR LIMITED
500 Series, 600 Series, 660 Series, 670 Series, 690 Series, 950 Series, 2300 Series, 3100 Series

Based on the classification specified above, STERLING bath and shower doors are warranted to be free of manufacturing defects within the time of the specified model's limited warranty from date of sale.

Kohler Co. will, at its election, repair, rectify or replace a fixture when inspection by Kohler Co. discloses any such defects occurring in normal usage within the time period of coverage stated above. Kohler Co. is not responsible for removal or installation costs where replacement is indicated. Damages due to improper handling, installation or maintenance are not considered manufacturing defects and are not covered by this warranty. This warranty is valid for the original, consumer purchaser only.

To obtain warranty service, contact Sterling, either through your plumbing contractor, home center, wholesaler or dealer, or by calling or writing Sterling, Consumer Services, 444 Highland Drive, Kohler, Wisconsin 53044, 1-800-783-7546.

TO THE EXTENT PERMITTED BY LAW, ALL IMPLIED WARRANTIES INCLUDING THOSE OF MERCHANTABILITY AND FITNESS FOR A PARTICULAR PURPOSE ARE HEREBY DISCLAIMED. KOHLER CO. AND SELLER HEREBY DISCLAIM ANY LIABILITY FOR SPECIAL, INCIDENTAL, OR CONSEQUENTIAL DAMAGES. Some states/provinces do not allow limitations on how long an implied warranty lasts, or the exclusion or limitation of special, incidental or consequential damages, so these limitations and exclusions may not apply to you. This warranty gives you specific legal rights. You may have other rights which vary from state/province to state/province.

This is the exclusive written warranty for Kohler Co.