

# Quick Consumer Manual



 **Speed Queen.**

# Welcome

Thank you for purchasing a Speed Queen® appliance. We value you as a customer. At Speed Queen, leading performance is our daily reality. We seek to deliver an outstanding experience in every aspect of laundry. Your machine was built to last 25 years in your home and Speed Queen support has been built to provide you with the best service in the industry.

## Installation - Washer

### Parts included:

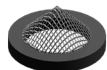

Two (2) filter  
screen washers



Two (2) plain  
rubber washers



Four (4) rubber  
feet



Beaded strap



Standpipe adapter

1. Remove shipping brace and shipping plug.
2. Wipe out inside of washtub.
3. Connect fill hoses – water pressure = 20-120 psi [138-827 kPa].
  - Two required, sold separately
  - Flush water supply lines
  - Use two filter screen washers with screen facing faucet
  - Use two rubber washers in end of hose connecting to the machine
4. Connect drain hose to drain receptacle – 36 in. [91 cm] recommended height.
  - Use beaded strap to secure drain hose to drain receptacle
  - Use standpipe adapter only if standpipe diameter is 2 in. [51mm] or less
5. Position and level washer – adjust front two legs. Tilt washer forward and back to set rear legs.
  - Place four rubber feet on leveling legs
6. Connect washer to electrical power – on individual branch circuit. Refer to serial plate for electrical ratings.
7. Run washer through one complete cycle to make sure it is operating properly.
8. Check for leaks.

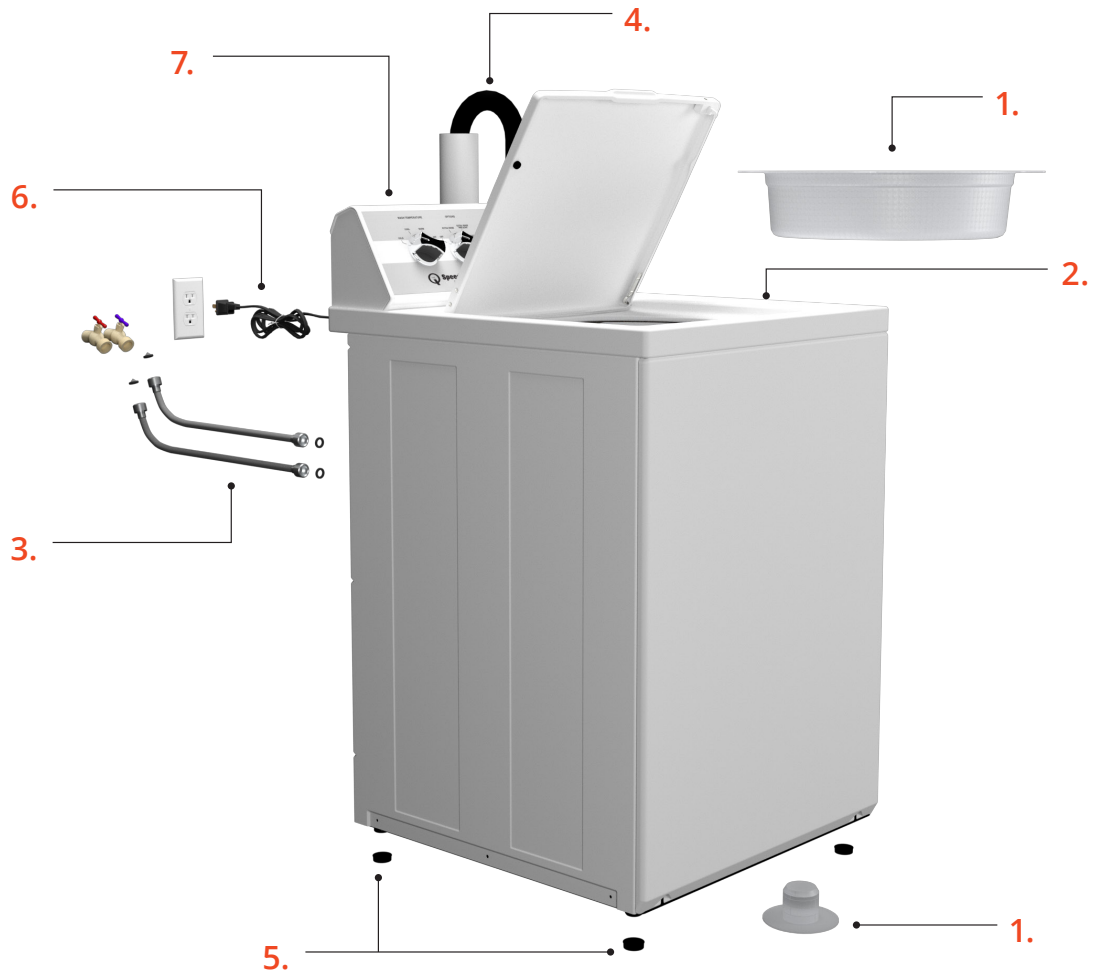

# Installation - Dryer

## Parts included:



Three (3) Screws  
(Electric Models)

1. Position and level the dryer.
  - Recommended rear clearance minimum is 2 in (51 mm) for utility connections and 6 in (152 mm) when venting through rear of unit
2. Connect exhaust system.
  - Dryer must be exhausted to the outdoors
  - Use 4 in (102 mm) rigid duct
  - Maximum straight duct length = 65 ft (19.8 m). Each elbow deduct 10 ft (3 m)
  - Sufficient make-up air must be supplied. The free area of any opening for outside air must be at least 40 in<sup>2</sup> (25806 mm<sup>2</sup>) per unit
3. Gas models – connect gas supply pipe. Gas service to a gas dryer must conform with the local codes and ordinances.  
*Refer to installation instructions, which can be found at [speedqueendoc.net](http://speedqueendoc.net)*
  - Tighten all connections securely but do not overtighten to avoid breaking or bending the gas valve bracket.  
Turn on gas and check all pipe connections (internal and external) for gas leaks by applying a non-corrosive leak detection fluid to the fittings. If bubbles are present then a leak is likely.  
Retighten connections and recheck for leaks.
4. Electric models – connect electrical cord with three-wire or four-wire plug.  
*Refer to installation instructions, which can be found at [speedqueendoc.net](http://speedqueendoc.net)*
5. Wipe out inside of dryer.
6. Plug in the dryer.
7. Start dryer and check that dryer is heating.

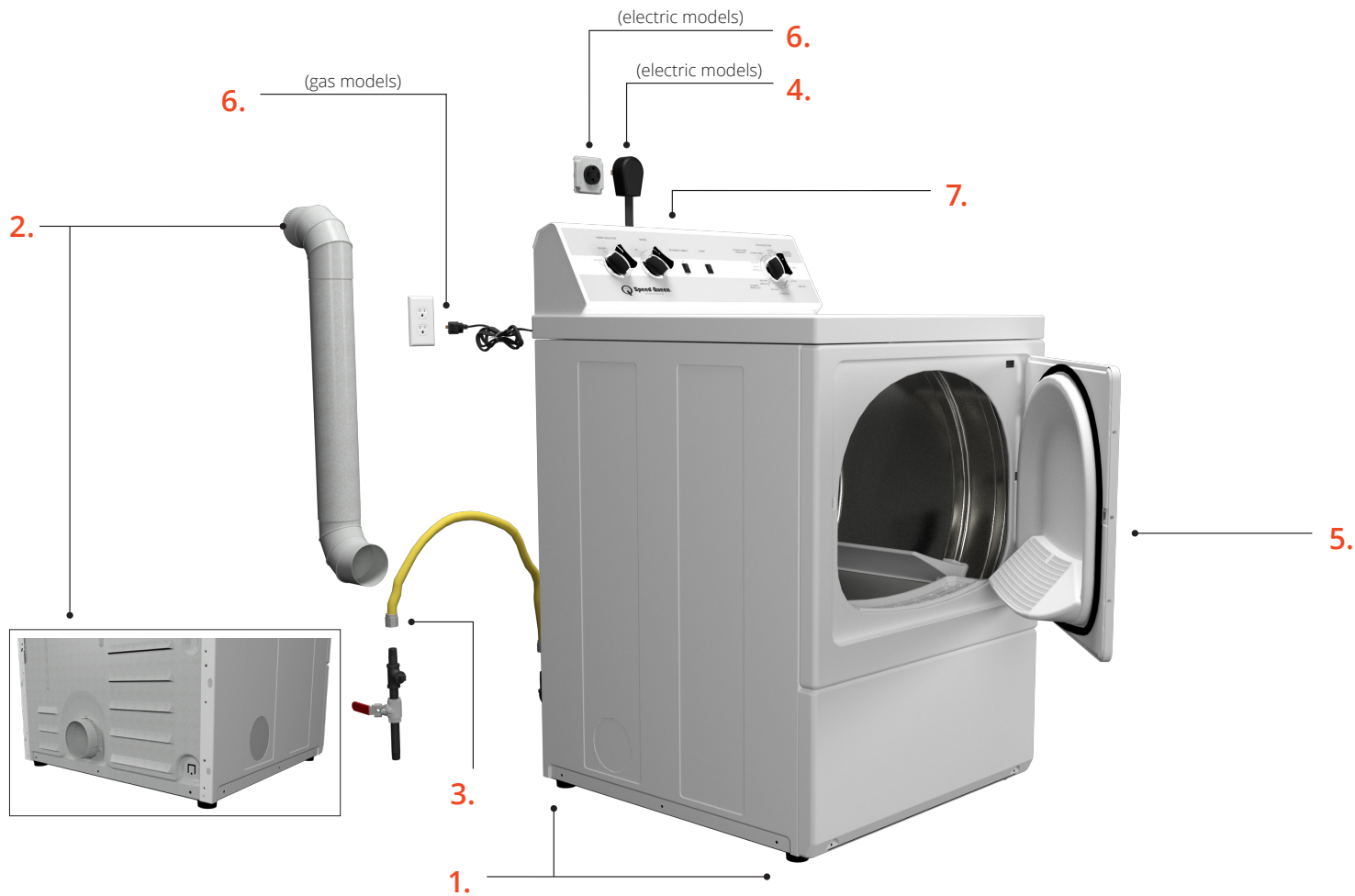

# Operating - Washer



1. Prepare laundry



2. Add laundry supplies  
Fabric Softener



Bleach      Detergent  
(bottom of washtub)

3. Load laundry



4. Close lid



5. Set cycle

6. Set temperature

7. Set options

8. Press start/pause

NOTE: The Normal Eco Cycle is designed for providing an eco-friendly solution for washing everyday cottons and linens. You will notice that this cycle uses less water and less hot water than other cycles. These functions are unique to the Normal Eco Cycle. All other cycles and options have no temperature restriction and use a full tub rinse.

# Operating - Dryer



1. Prepare laundry



2. Clean lint filter by wiping lint out of screen area

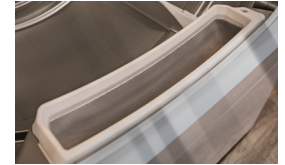

3. Load dryer half full with laundry



4. Close door



5. Set cycle

6. Set fabric selector

7. Set extended tumble, if desired

8. Press start or push timer knob in to start

9. Remove laundry from dryer once cycle has ended

# Register

1. Register your product at [www.speedqueen.com](http://www.speedqueen.com) to take full advantage of the limited warranty.



3 Year Warranty.  
Covers all parts and in-home labor.

**Note:** This unit includes a limited warranty. Refer to [Speedqueendoc.net](http://Speedqueendoc.net) to download the full warranty bond.

2. Download full documentation and view installation and operating videos for an immersive experience at [Speedqueendoc.net](http://Speedqueendoc.net) or scan the QR code below.

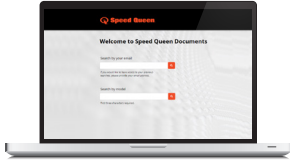

3. If you wish to receive printed documents at no cost, please complete the order form and return by mail to the address on the form, or email your request to [technicalcommunications@alliancels.com](mailto:technicalcommunications@alliancels.com).

## Order Form for Printed Documentation

- Please send me a printed Installation Manual, User's Guide, and Warranty Bond.
- I understand this card does not register my product. I must go to [www.speedqueen.com](http://www.speedqueen.com) to register.

Model No. \_\_\_\_\_

Serial No. \_\_\_\_\_

Name \_\_\_\_\_

Address \_\_\_\_\_ City \_\_\_\_\_ State \_\_\_\_\_

Zip Code \_\_\_\_\_ Phone No. \_\_\_\_\_

Email Address \_\_\_\_\_

Allow 1-2 weeks for delivery.



Part No. 204824R2  
January 2020

© Published by permission of the copyright owner - DO NOT COPY or TRANSMIT  
Speed Queen by Alliance Laundry Systems



NO POSTAGE  
NECESSARY IF  
MAILED IN THE  
UNITED STATES

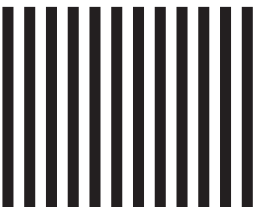

**BUSINESS REPLY MAIL**

FIRST CLASS MAIL

PERMIT NO. 489

RIPON, WI

POSTAGE WILL BE PAID BY ADDRESSEE

**SPEED QUEEN**

TECHNICAL DOCUMENTATION

SHEPARD STREET

P O BOX 990

RIPON WI 54971-9967

