

# Quick Consumer Manual



 **Speed Queen.**

# Welcome

Thank you for purchasing a Speed Queen® appliance. We value you as a customer. At Speed Queen, leading performance is our daily reality. We seek to deliver an outstanding experience in every aspect of laundry. Your machine was built to last 25 years in your home and Speed Queen support has been built to provide you with the best service in the industry.

## Installation

### Parts included:

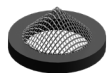

Two (2) filter  
screen washers



Two (2) plain  
rubber washers

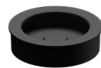

Four (4) rubber  
feet



Beaded strap



Two (2) plugs

1. Move unit to area within 4 ft (1.2 m) of final installation.
2. Remove shipping materials.
  - Remove lower panel (2 screws)
  - Remove four (4) bolts securing shipping brace. Remove brace and blue label
  - Remove two (2) bolts from rear of washer
  - Insert two (2) plugs into rear bolt holes
  - Reinstall panel
3. Connect fill hoses – water pressure = 20-120 psi [138-827 kPa].
  - Flush water supply lines
  - Use two filter screen washers with screen facing faucet
  - Use two rubber washers in end of hose connecting to the machine
4. Connect drain hose to drain receptacle – 36 in. [91 cm] recommended height.
  - Use beaded strap to secure drain hose to drain receptacle
5. Position and level the unit.
  - Place four (4) rubber feet on leveling legs
  - Unit must not rock
6. Wipe out inside of washtub.
7. Connect washer to electrical power – on individual branch circuit. Refer to serial plate for electrical ratings.
8. Run washer through one complete cycle to make sure it is operating properly and properly leveled.
9. Check for leaks.

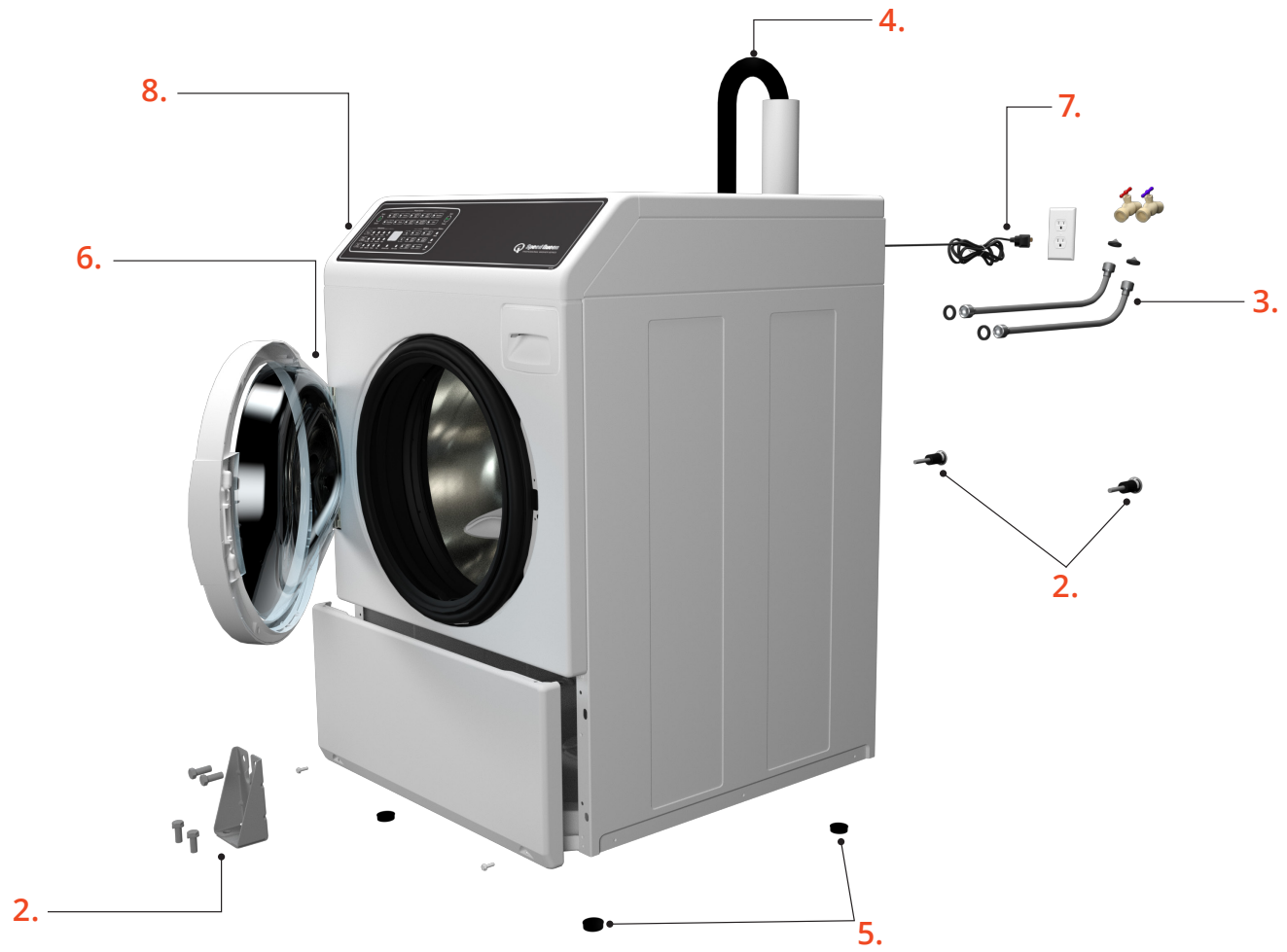

# Cycle Information

The following cycle descriptions will help determine which cycle to choose depending on the type of laundry being washed. The cycle settings may be modified using the Selections and Options.

## Heavy Duty

Use for sturdy items, like play or work clothes, towels, T-shirts, etc. The cycle includes a longer wash tumble and two rinses. The final spin extracts moisture at a high spin speed.

## Normal Eco

This cycle includes a wash tumble and two rinses, but uses less water than the other cycles. It also uses less hot water. Only the high spin speed is available in this cycle. This cycle is recommended for washing everyday cottons and linens.

## Perm Press

Use for permanent press items and synthetics. This cycle includes a wash tumble and two rinses. The final spin extracts moisture at a low spin speed.

## Delicate

Wash delicate items usually washed by hand on this cycle. The cycle includes a wash tumble and two rinses. The final spin extracts moisture at a low spin.

## Whites

This cycle is designed to keep white laundry white. It utilizes a longer, hot water wash tumble and two rinses. The final spin extracts moisture at a high spin speed.

## Sanitize with Oxi

This cycle has been verified to reduce 99.9% of bacteria found in the typical household laundry load when used with an Oxi additive in addition to detergent. In addition there is no significant contamination transferred to later washer loads.

## Favorite

The Favorite keypad allows the user to save nine different cycles, selections and options for later use.

1. Press the Favorite keypad. The control will display the settings for the first Favorite cycle. The display will switch between F1 and the cycle time for the selected cycle. If a Special Cycle is selected, the display will switch between F1, P1 and the cycle time.
2. Press the keypads for the desired settings.
3. Press the Favorite, Start/Pause or Delay Start keypad to save the current settings.
4. Press the Power/Cancel keypad to discard the current settings.
5. The next Favorite cycle, F2, will be displayed.

After the cycles have been saved, they can be accessed using the up and down arrow keypads after pressing the Favorite keypad.

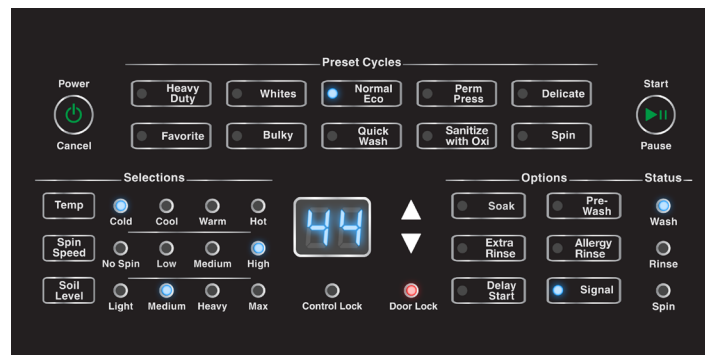

# Operating

1. Prepare laundry



2. Add high efficiency (he) laundry supplies\*



3. Load laundry



4. Close door



5. Set cycle

6. Set temperature

7. Set spin speed

8. Set soil level

9. Press start/pause

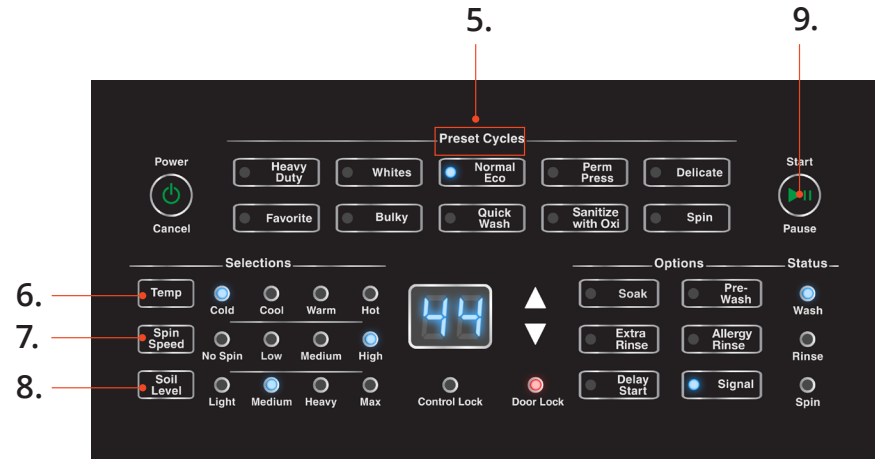

\*Note: Pods must be placed in washtub with laundry.



# Register

1. Register your product at [www.speedqueen.com](http://www.speedqueen.com) to take full advantage of the limited warranty.



5 Year Warranty.  
Covers all parts and in-home labor.

**Note:** This unit includes a limited warranty. Refer to [Speedqueendoc.net](http://Speedqueendoc.net) to download the full warranty bond.

Download full documentation and view installation and operating videos for an immersive experience at [Speedqueendoc.net](http://Speedqueendoc.net) or scan the QR code below.

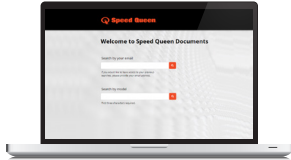

3. If you wish to receive printed documents at no cost, please complete the order form and return by mail to the address on the form, or email your request to [technicalcommunications@alliancels.com](mailto:technicalcommunications@alliancels.com).

## Order Form for Printed Documentation

Please send me a printed Installation Manual, User's Guide, and Warranty Bond.  
 I understand this card does not register my product. I must go to [www.speedqueen.com](http://www.speedqueen.com) to register.

Model No. \_\_\_\_\_

Serial No. \_\_\_\_\_

Name \_\_\_\_\_

Address \_\_\_\_\_ City \_\_\_\_\_ State \_\_\_\_\_

Zip Code \_\_\_\_\_ Phone No. \_\_\_\_\_

Email Address \_\_\_\_\_

Allow 1-2 weeks for delivery.



Part No. 807535R1  
November 2019

© Published by permission of the copyright owner - DO NOT COPY or TRANSMIT  
Speed Queen by Alliance Laundry Systems

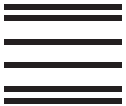

NO POSTAGE  
NECESSARY IF  
MAILED IN THE  
UNITED STATES

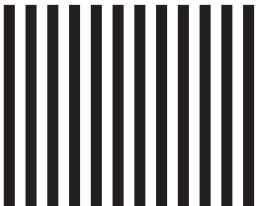

**BUSINESS REPLY MAIL**

FIRST CLASS MAIL

PERMIT NO. 489

RIPON, WI

POSTAGE WILL BE PAID BY ADDRESSEE

**SPEED QUEEN**

TECHNICAL DOCUMENTATION

SHEPARD STREET

P O BOX 990

RIPON WI 54971-9967

