

## Instructions for Models:

SI-A101  
SI-A101-BN

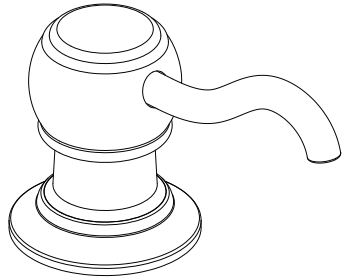

### Need Help?

For additional assistance or service call:

**SPEAKMAN** Company  
400 Anchor Mill Road  
New Castle, DE 19720

PHONE: 800-537-2107  
EMAIL: [customerservice@speakmancompany.com](mailto:customerservice@speakmancompany.com)  
WEB: [www.speakmancompany.com](http://www.speakmancompany.com)

92-SI-A101-R1

## What You Need To Know: Important Notes:

Be sure to read instructions thoroughly before beginning installation. Do not overtighten any connections or damage may occur. This soap dispenser has an operating range of 20-80 psi.

### Safety Tips:

Cover your drain to prevent loss of parts.  
Be sure to wear eye protection while cutting pipe.

### Maintenance:

Your new Soap Dispenser is designed for years of trouble-free performance. Keep it looking new by cleaning it periodically with a soft cloth. Avoid abrasive cleaners, steel wool and harsh chemicals as these will dull the finish and void your warranty.

- 1 Remove the bottle. Separate the soap dispenser head from the flange body assembly.



- 2 Insert the body assembly through the selected hole in the sink. Secure the body to the sink by screwing the mounting nut from the underside of the sink. Hand tighten only.

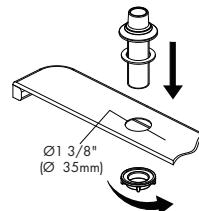

- 3 Screw the bottle onto the body assembly shank.

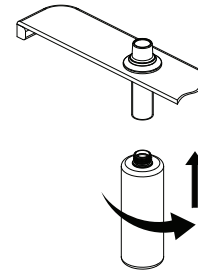

- 4 Pour in the soap (not included) into the shank orifice.

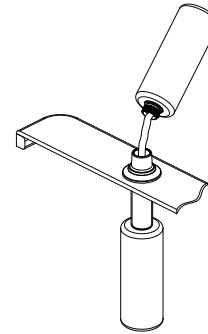

- 5 Reinsert the soap head into the top of the flange.

