

Important: Always disconnect the power before installing or replacing bulb and before cleaning or other maintenance.

This light should be installed by a licensed electrician

Assembly & Installation Instructions

1. Shut off power to outlet box (Fig A).
2. Make appropriate electrical connections using wire nuts:
 - a. Connect the fixture's hot wire (black) to the black outlet box wire.
 - b. Connect the fixture's neutral wire (white) to the white outlet box wire.
 - c. Connect fixture's ground wire (green or uncoated) to the ground outlet box wire. If no ground is present in outlet box, connect fixture's ground wire to the mounting plate using the green screw (included).
 - d. Carefully place connections in outlet box.
3. Place mounting plate over outlet box and secure it with outlet box screws.
4. Attach back plate to the back plate screws and tighten with back plate knobs.
5. Install candelabra base bulbs.(not included)
6. Attach the plastic washer and the large glass to the threaded stem 1.
7. Attach the plastic washer and spacer to threaded stem 1 and screw until tight,attach the plastic washer and front small glass to threaded stem 2, and tighten with the plastic washer and knob.
8. Attach the plastic washers and side small glass to threaded stems 3 and tighten with plastic washers and knobs.
9. Restore power to fixture.

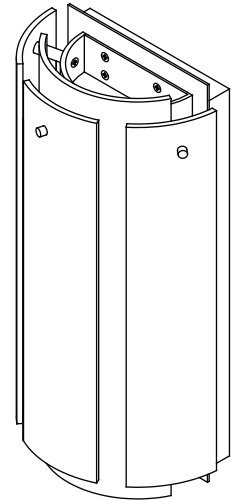
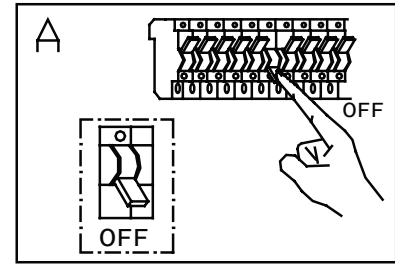

3181

CARE INSTRUCTIONS

Dusting – Use a clean, dry cloth.

Cleaning – To protect the finish, avoid any harsh abrasives or chemicals.

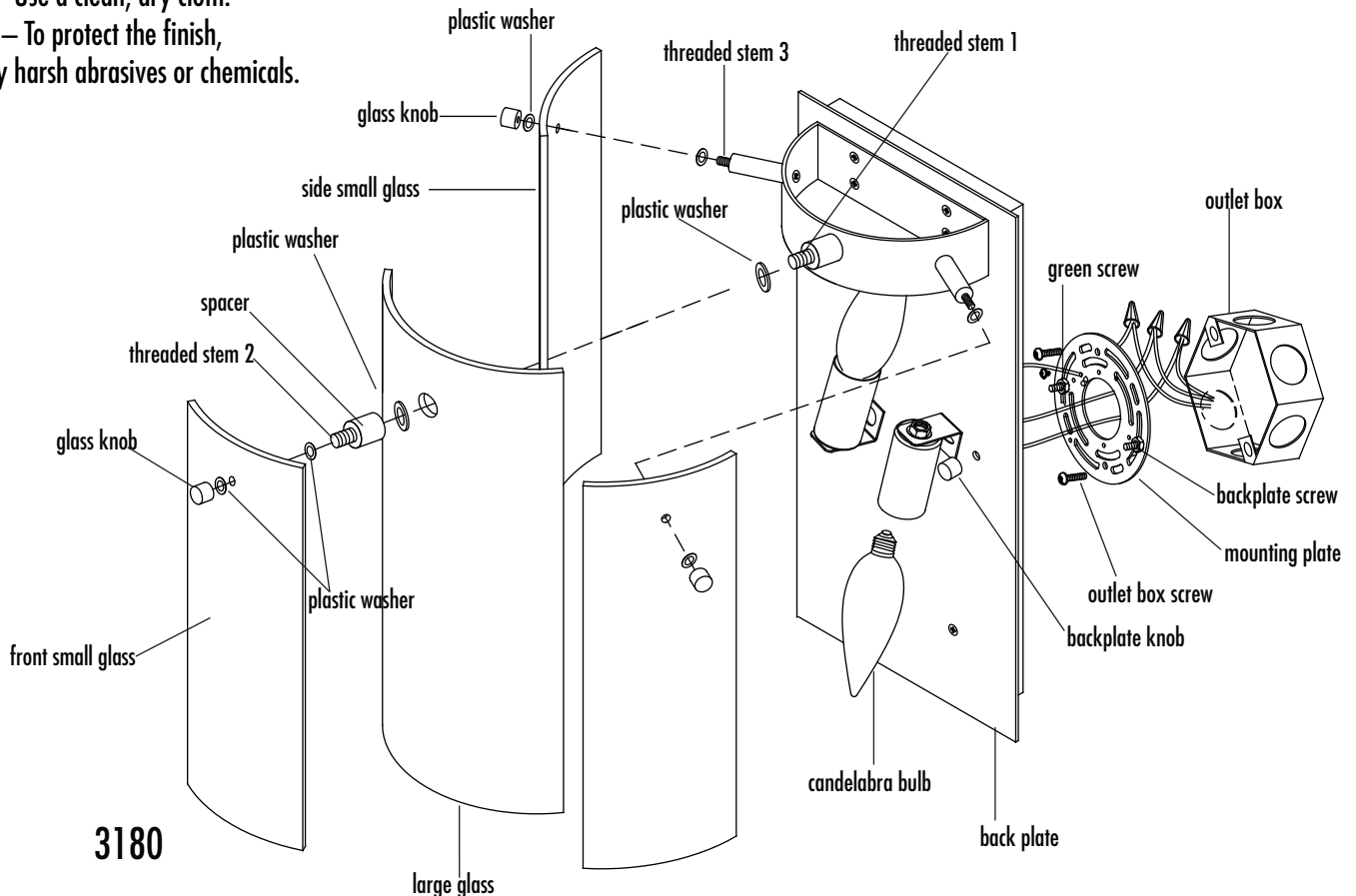

3180