

INSTALLATION INSTRUCTIONS FOR WES-212 DUAL-FLUSH HANDLE AND WES-213 WATER CONSERVATION TUNE-UP KIT (DUAL-FLUSH HANDLE AND DIAPHRAGM KIT)

DUAL-FLUSH HANDLE INSTALLATION FOR WES-212 AND WES-213 KITS

IMPORTANT: Water does not need to be shut off, but use caution to NOT ACTIVATE the valve.

- 1** Remove Handle Coupling and Gasket from Flushometer Valve Body.

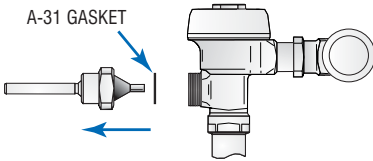

- 2** Replace with Dual-Flush Handle Assembly and new Gasket using the existing Handle Coupling.

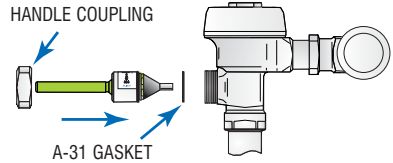

- 3** Install Handle with "line" indicator on Label facing "UP."

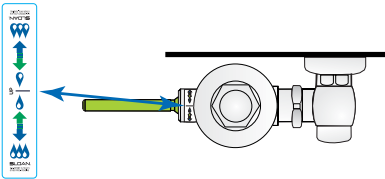

- 4** Tighten the Handle Coupling securely.

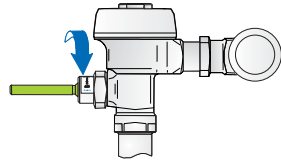

- 5** Recommended Plate Locations:

- Centered over Flush Valve
- On Stall Door

Water-Saving Dual-Flush Handle

UP for #1 (liquid waste)



DOWN for #2 (solid waste)

By installing this water-saving, dual-flush handle, this facility has demonstrated its commitment to protect and preserve the environment. For the system to work, we need your help. Please take a look at the diagram above and push the handle in the direction which best suits your needs. With your assistance, we can do our part to conserve this precious resource.

SLOAN.

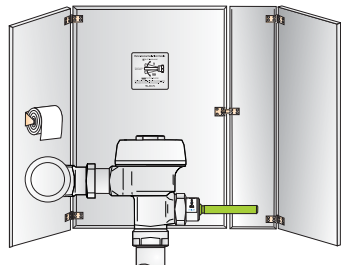
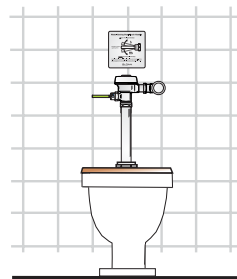

DIAPHRAGM KIT INSTALLATION (WES-213 KIT ONLY)

NOTE: Always determine the required flush volume (see label on valve or markings on fixture). Match Diaphragm Assembly and Fixture for appropriate flush discharge (example, 1.6 gpf diaphragm to 1.6 closet fixture).

- 1** Remove Stop Cap and **close** Supply Stop.

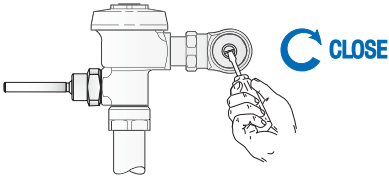

- 2** Remove Outside and Inside Covers and lift out old Inside Parts Assembly.

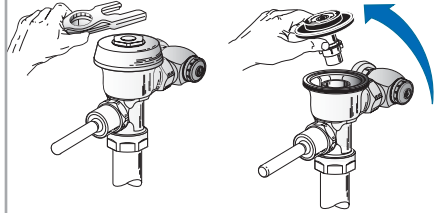

- 3** Install new Inside Parts Assembly.

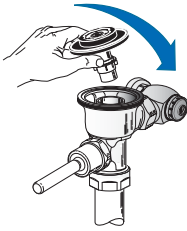

- 4** Reinstall Inside and Outside Covers wrench tight.

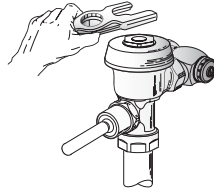

- 5** Open Control Stop **COUNTERCLOCKWISE** one FULL turn from closed position.

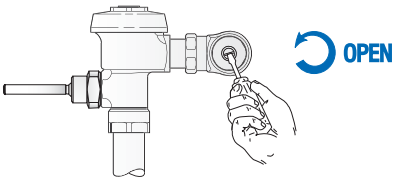

- 6** Activate Flushometer. Adjust Control Stop after each flush until the rate of flow delivered properly cleanses the fixture without excessive splashing. Replace Stop Cap.

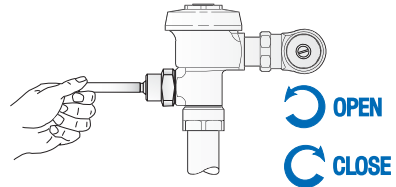

This document serves as a guide when installing the Sloan WES-212 Dual-Flush Handle and WES-213 Water Conservation Tune-up Kit. As always, good safety practices and care are recommended when installing your new Water Conservation Kit.

The information contained in this document is subject to change without notice.

Patent pending.

SLOAN VALVE COMPANY • 10500 Seymour Avenue • Franklin Park, IL 60131
Phone: 1-800-9-VALVE-9 or 1-847-671-4300 • Fax: 1-800-447-8329 or 1-847-671-4380

Copyright © 2005 SLOAN VALVE COMPANY

www.sloanvalve.com
Printed in the U.S.A. 09-05