

SkyPlug Retrofit Kit

For cord, rod and chain suspended light fixtures

INSTALLATION MANUAL

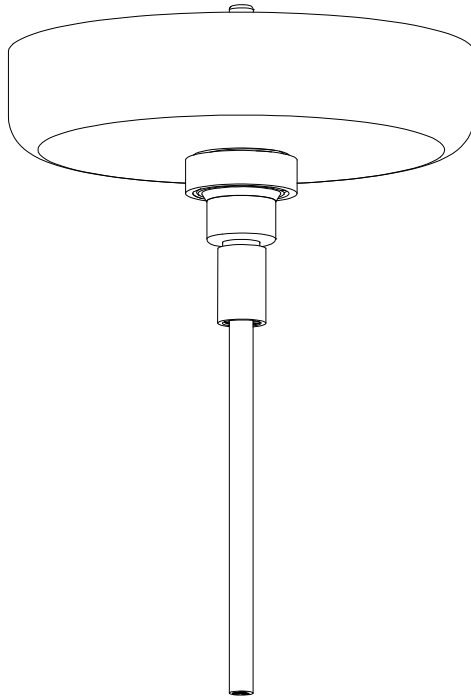

View Instructional Video
before beginning



For Chain, Cord and Metal Rod Hanging Fixtures



IMPORTANT SAFETY INFORMATION

1. Disconnect power by turning off the circuit breaker or by removing the fuse at the fuse box. (All electrical steps should be performed by a qualified person or electrician.)
2. Ensure wiring and outlet box are compliant with national and local electrical codes, including the NEC. SkyOutlet requires installation on the branch circuit (Solid 12 or 14 AWG wire) and should be installed by a qualified person or electrician.
3. For cord suspended fixtures - Do not use with luminaire weight greater than 5 lbs for SVT and 10 lbs for SJT cord and use overhand knot for strain relief.
4. For chain or metal rod suspended fixtures - Suitable for luminaire support max.50 lbs.

Parts Included:

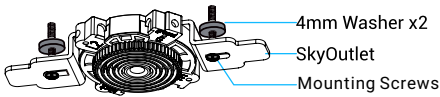
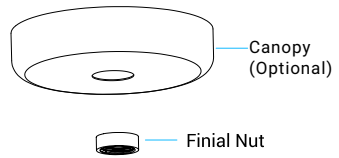
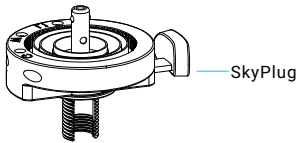

NOTE: The original fixture canopy can be used if the spacing meets below:

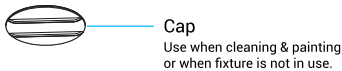
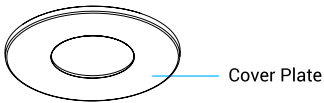
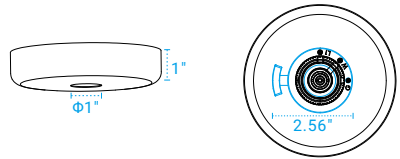

For Chain Suspended Fixture

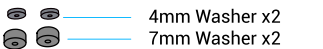
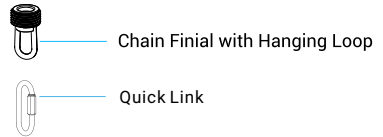

For Cord or Rod Suspended Fixture

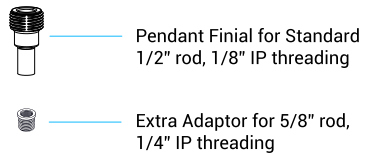

Prepare for SkyOutlet Installation

Push the middle of SkyOutlet to separate cover plate and SkyOutlet

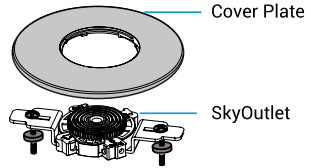
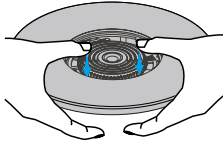

SkyOutlet Wiring and Installation

IMPORTANT: Disconnect power by turning off the circuit breaker or by removing the fuse at the box. All electrical steps should be performed by a qualified person or electrician.

1 Wire SkyOutlet to ceiling junction box.

1. Strip wire to 9/16"/14mm.

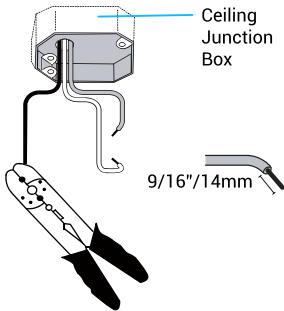

2. Loosen terminal screws to insert branch circuit wires into the corresponding terminals. Tighten to secure wires. Check to make sure wires are securely inserted into terminals. Set screw torque value at 6.3 lb/in.

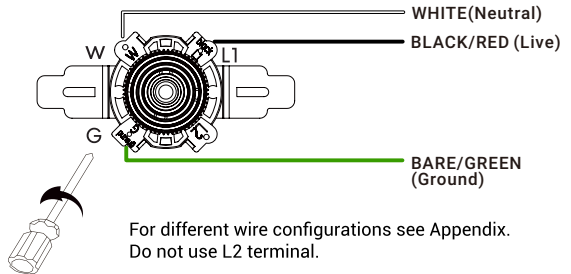

2 Secure SkyOutlet to outlet box using 2 screws and washers (included).

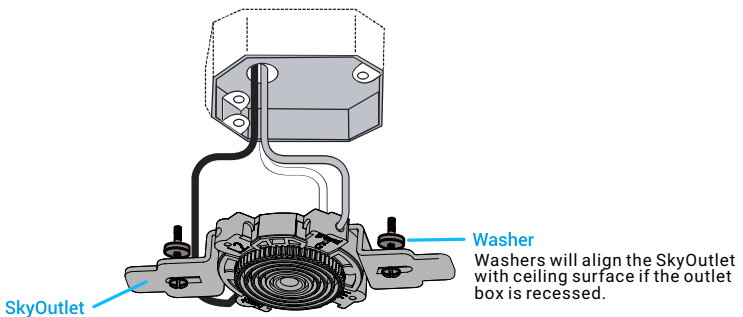

IMPORTANT: If your box is flush with ceiling or recessed less than 1.5 mm (0.06"), use 4 mm washer. If recessed between 1.5 mm (0.06") and 3 mm (0.12") use larger 7 mm rubber washer. If recessed more, use combination of both washers.

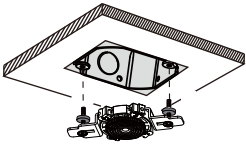

4mm rubber washer

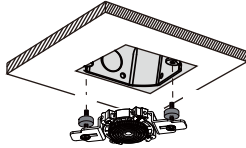

7mm rubber washer

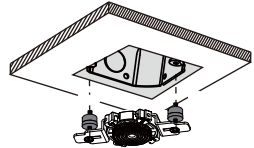

4mm rubber washer
7mm rubber washer

3 Secure cover plate as shown.

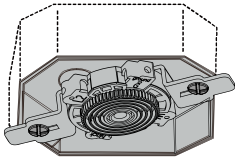

Align tabs on the cover plate with the SkyOutlet bracket and press to secure in place.

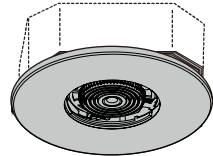
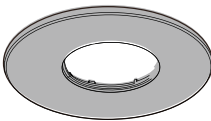

NOTE: A center cap is provided to cover and protect the SkyOutlet when the light fixture is removed for painting, maintenance, etc. To install the center cap, align the two slots on the cover plate and turn to secure.

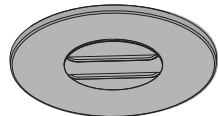
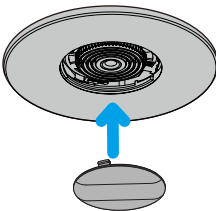

Assemble Standard Lighting Kit to Light Fixture

- 1 Prepare your light fixture and remove original canopy parts if needed. You will be using the new canopy and fixture parts from the kit to attach to your chain, cord or metal rod lighting fixture.
- 2 Determine desired fixture hanging height and wire length. Leave at least 6 inches of wire from canopy for making electrical connection.

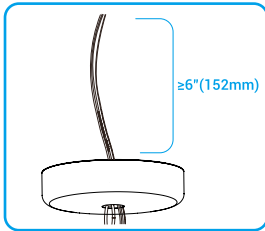

Fixture height is usually 36" from table top and 66" from floor.

- 3 When ready to begin, select the adaptor parts from the kit for your type of fixture.

Chain Fixture

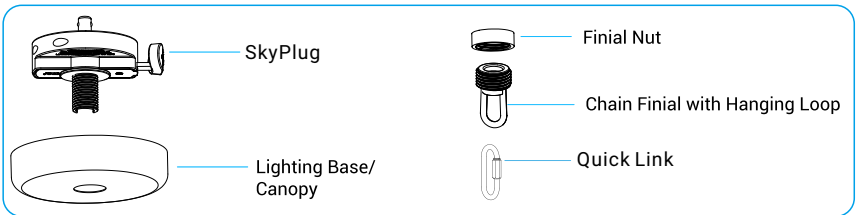

Metal Rod Fixture

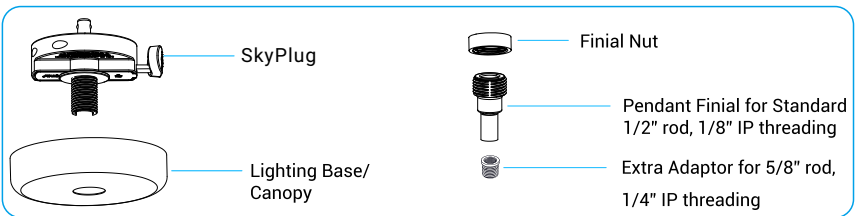

Cord Fixture

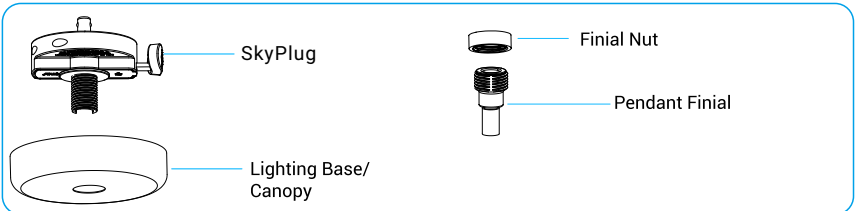

4 Place Finial Nut & Lighting Base Parts down the chain, rod or cord in the order as shown. Insert fixture wire through Finial.

Chain Fixture

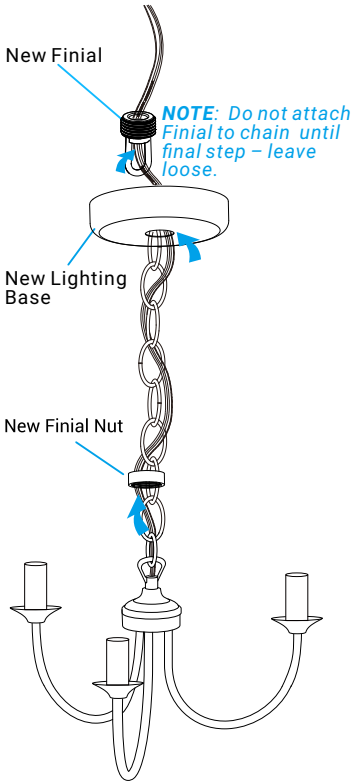

Metal Rod Fixture

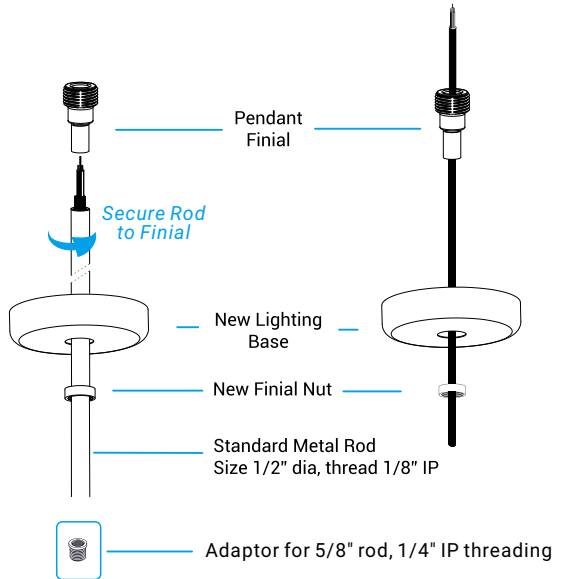

If using 5/8" metal rod

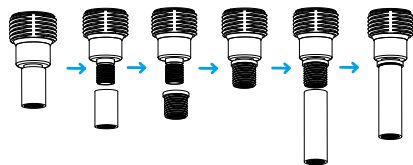

Remove the nipple on the pendant finial.
Attach 1/4" adaptor to the finial.
Attach the 5/8" rod.

5 Wire the SkyPlug

5A Measure the leads to cut excess wire and strip the leads.

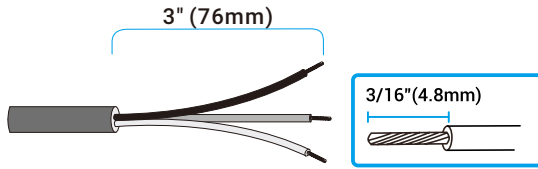

5B Follow Steps 6A, 6B or 6C for assembly and wiring to your specific fixture type (Chain, Rod and Cord).

5C Separate the wires and insert each wire into the corresponding terminals. Insert Live into L1, Neutral into N, Ground wire (usually bare copper or green) into G. Tighten screws to secure wire.

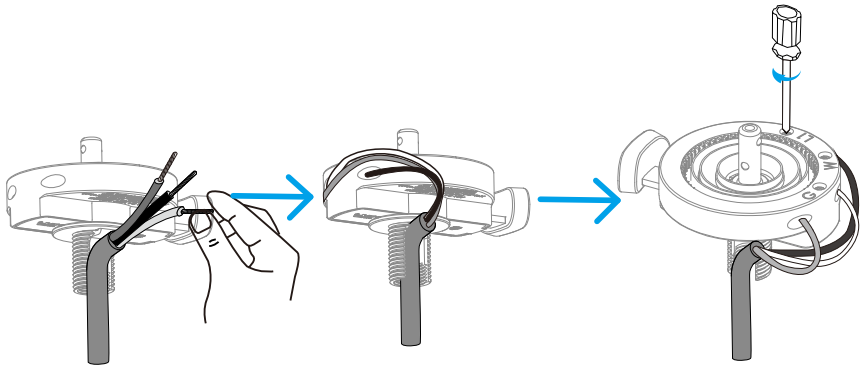

Typical Fixture Wire

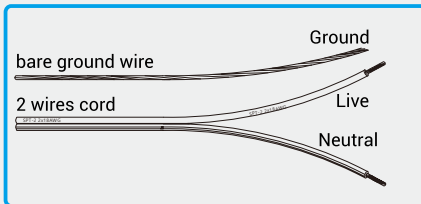

For cord without color wires - Live wire is with writing and smooth edge. Neutral wire is with rough edge and no writing. Ground is bare wire.

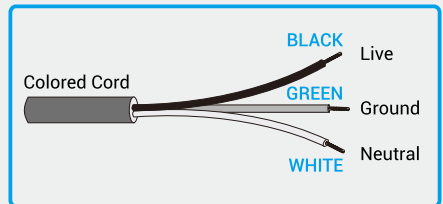

For cord with color wires - Live wire is black, neutral is white and ground is usually green.

6 Attach SkyPlug to Light Fixture.

A -Chain Fixtures

Before cutting wires, recheck wire length for desired fixture height.

- A1** Route wire through metal U shape opening in wire tunnel. Attach chain finial to SkyPlug, turning to secure in place. Do not overtighten. Cut excess wire and strip the leads.

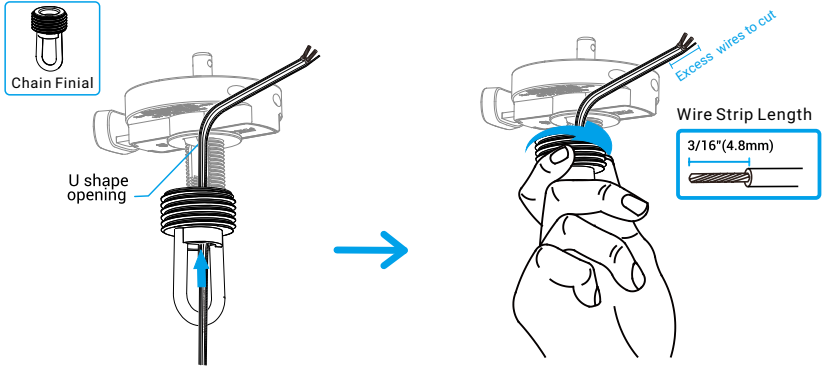

- A2** See step 5C for additional wiring info. Loosen terminal screws and insert wires into the terminal:
Live into L, Neutral into N, Ground into G.

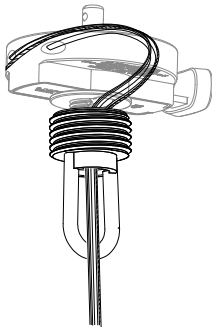

- A3** Attach assembled unit to chain using quick link. (Included)

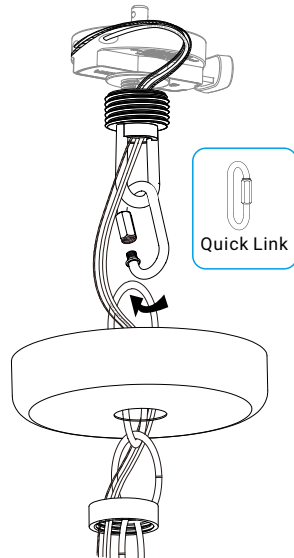

B -Metal Rod Fixtures

Before cutting wires, recheck wire length for desired fixture height.

- B1** Route wire through metal U shape opening in wire tunnel. Attach finial (with metal rod and fixture attached) to SkyPlug. Turn Pendant Finial to secure in place. Do not overtighten. Cut excess wire and strip the leads.

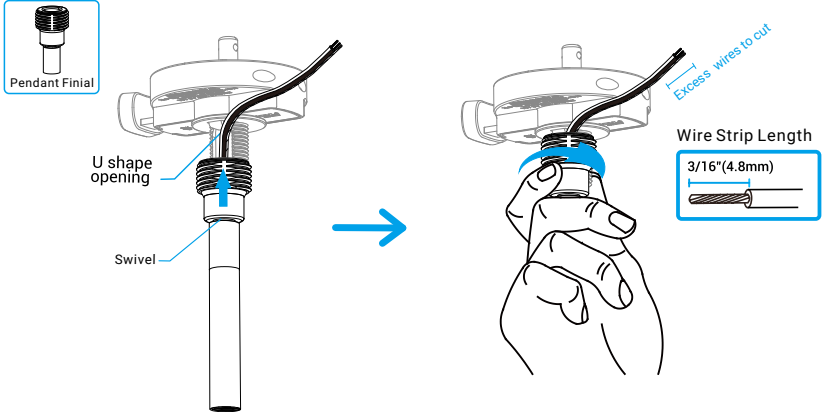

- B2** See step 5C for additional wiring info. Loosen terminal screws and insert wires into the terminal:
Live into L, Neutral into N, Ground into G.

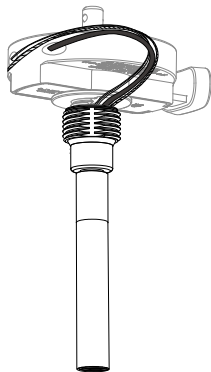

C - Cord Suspended Fixtures

Before cutting wires, recheck wire length for desired fixture height.

- C1** Route wire through metal U shape opening in wire tunnel. Attach finial (with cord and fixture attached) to SkyPlug. Turn to secure in place. Do not overtighten. Cut excess wire and strip the leads.

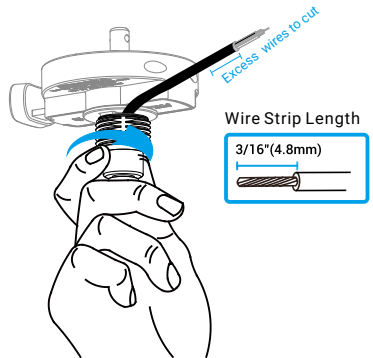
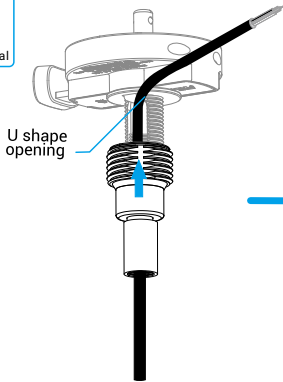

IMPORTANT: Ensure the finial is secure to the outer sleeve of the cable instead of the three wires.

- B2** See step 5C for additional wiring info. Loosen terminal screws and insert wires into the terminal:
Live into L, Neutral into N, Ground into G.

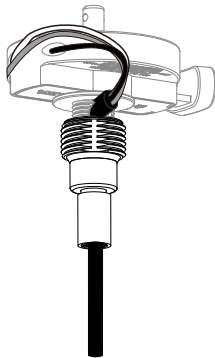

Installation of Fixture with SkyPlug

1 After assembling kit to the fixture, plug into the SkyOutlet.

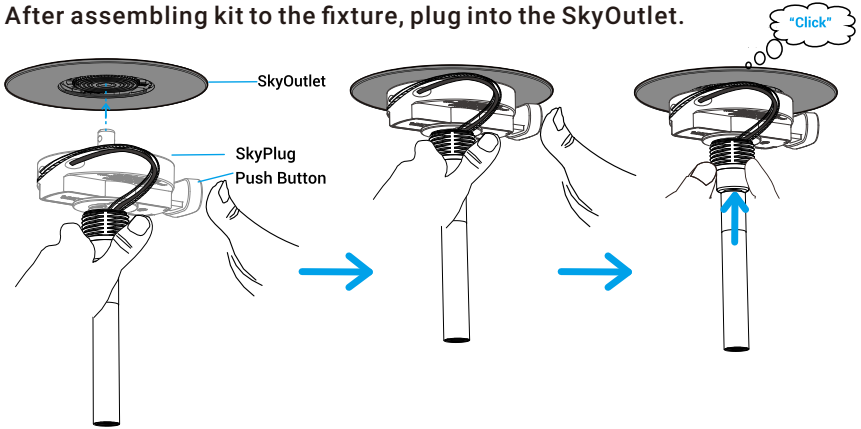

Align with the center hole, keep pressing the push button to insert into the SkyOutlet.

Keep button pressed in while inserting SkyPlug into the SkyOutlet.

Once inserted, push up until you hear the "click" sound.

2 Once plugged in, slide the Lighting Base up to the ceiling surface and secure in place with the finial nut.

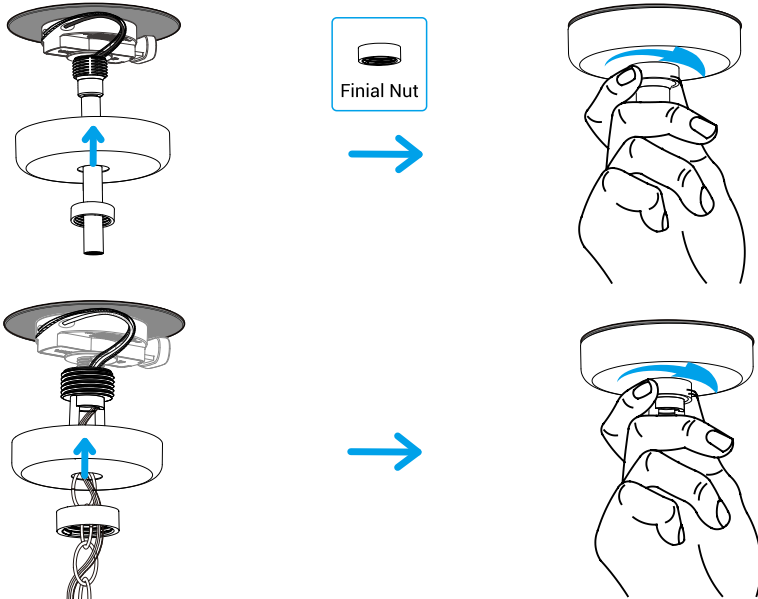

Removing SkyPlug Fixtures

- 1 Loosen finial nut and allow canopy to drop down.

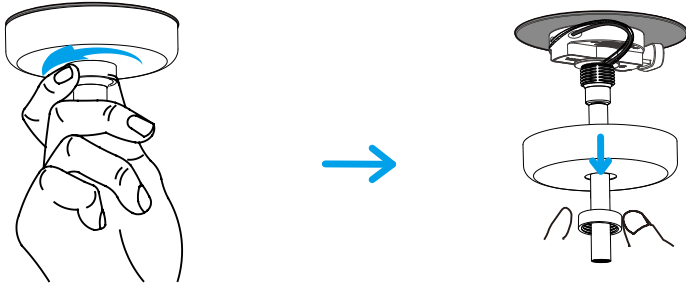

- 2 Release the fixture from ceiling.

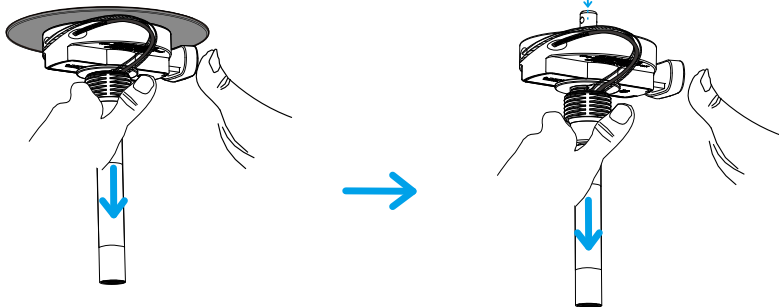

While holding the fixture securely, press the side push button.

Keep button pressed in and remove SkyPlug from SkyOutlet

- 3 The small cap is available to cover up SkyOutlet when not in use .



APPENDIX

Additional Wiring Diagram

IMPORTANT: If you have multiple wires inside your outlet box, you will need to determine which lead is the live or switched lead and insert this lead into L1. If you are not sure how your house is wired, contact 1-866-885-4649 for questions or contact an electrician. When multiple wires are connected together use a solid wire 12 or 14 AWG JUMPER LEAD (included) to insert into the receptacle terminal. **Do not use L2.**

WIRING DIAGRAM #1:

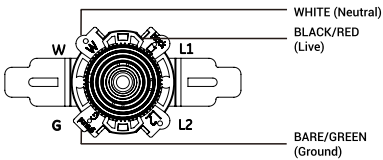

WIRING DIAGRAM #4:

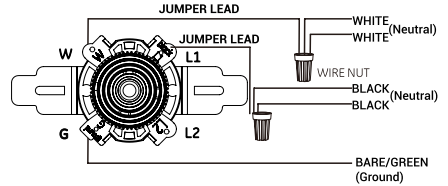

WIRING DIAGRAM #2:

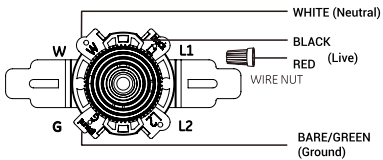

WIRING DIAGRAM #5:

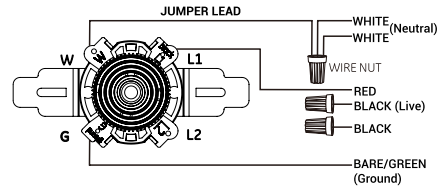

WIRING DIAGRAM #3:

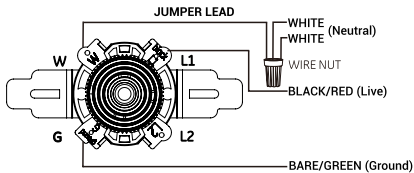

NOTE: If you have multiple wires connected together, add the included JUMPER LEAD and insert jumper lead into terminal. Only one single wire can be inserted into terminal (See diagram 3-5).

WARRANTY

LIMITED 1 YEAR WARRANTY

SKYX Platforms Corp. (SKYX), provides this limited warranty to the purchaser (Purchaser) of SKYX's SkyPlug Canopy Retrofit Kit (Product). This warranty is not assignable or transferable to any party.

This Product is warranted against any electronic or mechanical defects for a period of one (1) year from the date of original purchase (Warranty Period). SKYX will repair or, at its option, replace the defective Product or component parts without charge if, within the Warranty Period, the Product has been proven to be defective and is returned by Purchaser to SKYX with satisfactory proof of purchase. Any replacement or repaired Product or components will be warranted to the original Purchaser for the remaining portion of the Warranty Period. This warranty does not cover any Product (a) installed by any party other than SKYX; (b) that has been subject to neglect, accident, abuse, improper wiring, incorrect voltage or any other forms of misuse; (c) that has been used in a manner inconsistent with the warnings and instructions contained in the product documentation; (d) that appears to have been opened, disassembled or tampered with; or (e) purchased from a third-party. This warranty does not cover costs for removal or installation of the Product for repair.

EXCEPT FOR THE LIMITED WARRANTY SET FORTH ABOVE, SKYX EXPRESSLY DISCLAIMS ALL WARRANTIES WITH RESPECT TO THE PRODUCT, EITHER EXPRESS, IMPLIED OR STATUTORY, INCLUDING, BUT NOT LIMITED TO, THE IMPLIED WARRANTIES OF MERCHANTABILITY, FITNESS FOR A PARTICULAR PURPOSE, QUIET ENJOYMENT, TITLE AND NON-INFRINGEMENT.

To obtain warranty service, email support@skyplug.com.

LIMITATION OF LIABILITY

TO THE MAXIMUM EXTENT NOT PROHIBITED BY LAW, IN NO EVENT AND UNDER NO CIRCUMSTANCES SHALL SKYX BE LIABLE TO THE PURCHASER OF ITS PRODUCT OR ANY THIRD PARTY FOR ANY INCIDENTAL, SPECIAL, INDIRECT OR CONSEQUENTIAL DAMAGES WHATSOEVER, INCLUDING, WITHOUT LIMITATION, DAMAGES FOR LOSS OF PROFITS, LOSS OF DATA, LOSS OF GOODWILL, BUSINESS INTERRUPTION OR ANY OTHER DAMAGES OR LOSSES, ARISING OUT OF OR RELATED TO PURCHASER'S POSSESSION OR USE OF THE PRODUCT, HOWEVER CAUSED, REGARDLESS OF THE THEORY OF LIABILITY (WHETHER BY BREACH OF CONTRACT, WARRANTY, NEGLIGENCE, STRICT LIABILITY IN TORT, OR OTHERWISE) AND EVEN IF ADVISED OF THE POSSIBILITY OF SUCH DAMAGES. IN NO EVENT WILL SKYX'S TOTAL LIABILITY ARISING OUT OF OR RELATED TO THE PRODUCT, WHETHER ARISING OUT OF OR RELATED TO BREACH OF CONTRACT, TORT (INCLUDING NEGLIGENCE) OR OTHERWISE, EXCEED THE AMOUNT THE PURCHASER PAID FOR SUCH PRODUCT.