

60" WATSON

DOUBLE-WALL HAMMERED COPPER SOAKING TUB

SKU: 921994



CONTENTS

60" TUB	PAGE 2
AIR TUB	PAGE 3
60" AIR TUB	PAGE 4

FEATURES

- Dimensions: 60" L x 30" W (front to back) x 34" H (± 1").
- Interior seat: 19" L x 11" W x 7" H (± 1").
- Made of 14-gauge copper.
- Hand-polished finish.
- Patina applied using French hot process, so color is ingrained in the copper.
- Tubs are handmade and therefore unique. Expect slight variations in finish and dimensions (± 1").
- Requires wall- or floor-mount tub filler.
- Air tub option: features 12 air jets that massage and relax. Remote control works within 15-foot radius and is designed to float. Tub and air system come fully assembled.
- Insulation option: increases heat retention and prevents condensation due to water and air temperature fluctuations.
- To keep the tub in premium condition, it is recommended to not use anything abrasive for bathing or cleaning, including products like Epsom salts, bristle brushes, and harsh soaps.
- Design: Modern
- Product Finish: Antique Copper Patina
- Overflow Hole: No
- Shape: Oval
- Material: Copper
- Exterior Treatment: Hammered
- Interior Treatment: Hammered
- Metal Gauge/thickness: 14 Gauge
- Tap Deck: No
- Drain Included: No
- Drain Placement: Center
- Faucet Included: No
- Faucet Drillings: No Drillings

REVISED 06/23/2021

60" WATSON

DOUBLE-WALL HAMMERED COPPER SOAKING TUB

SKU: 921994

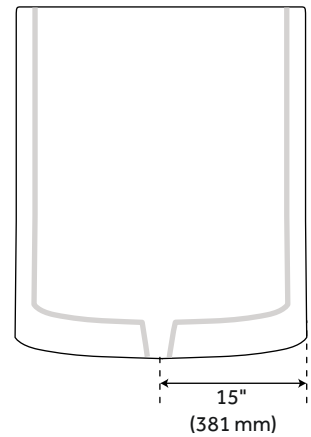
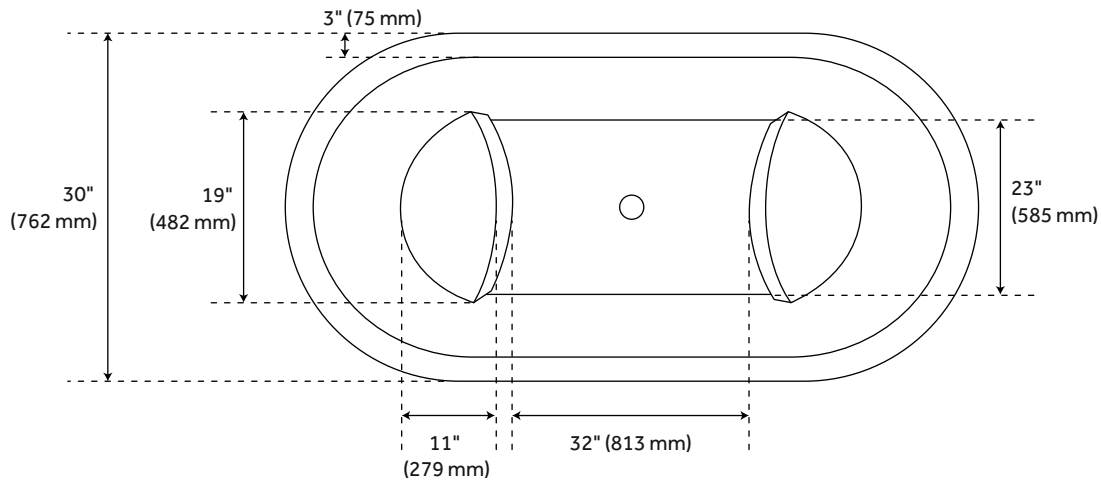

FEATURES

Length: 60"
Width: 30"
Height: 34"
Tub Interior Length: 54"
Tub Interior Width: 23"
Water Depth To Rim: 28-3/4"
Tub Weight Uncrated (Lbs): 200
Tub Weight Crated (Lbs): 310

PRODUCT IMAGE



60" WATSON AIR TUB

COMPONENTS LIST

- BM-TWP BALL CHECK VALVE JETS
- MANI-SD-A SECURITY DEVICE
- MAN-A-4-AC MANIFOLD
- SILVER SLS+ VARIABLE SPEED BLOWER

INSTALLATION

Install blower behind a wall (with an access panel) or in a closet. Blower can also be installed under floor. Ensure the security device, MANI-SD-A, is at least:

- 2" Above the tub rim

Security device and hose can be mounted in wall

REMOTE CONTROL

- CG+/RTC-SENSOR-WP
- 12 – 15 YEAR BATTERY LIFE

INSIDE OF BATH

- (12) MAXI AIR JETS WITH 24 OPENINGS



ELBOWS FOR
AIR JETS



TEES FOR
AIR JETS

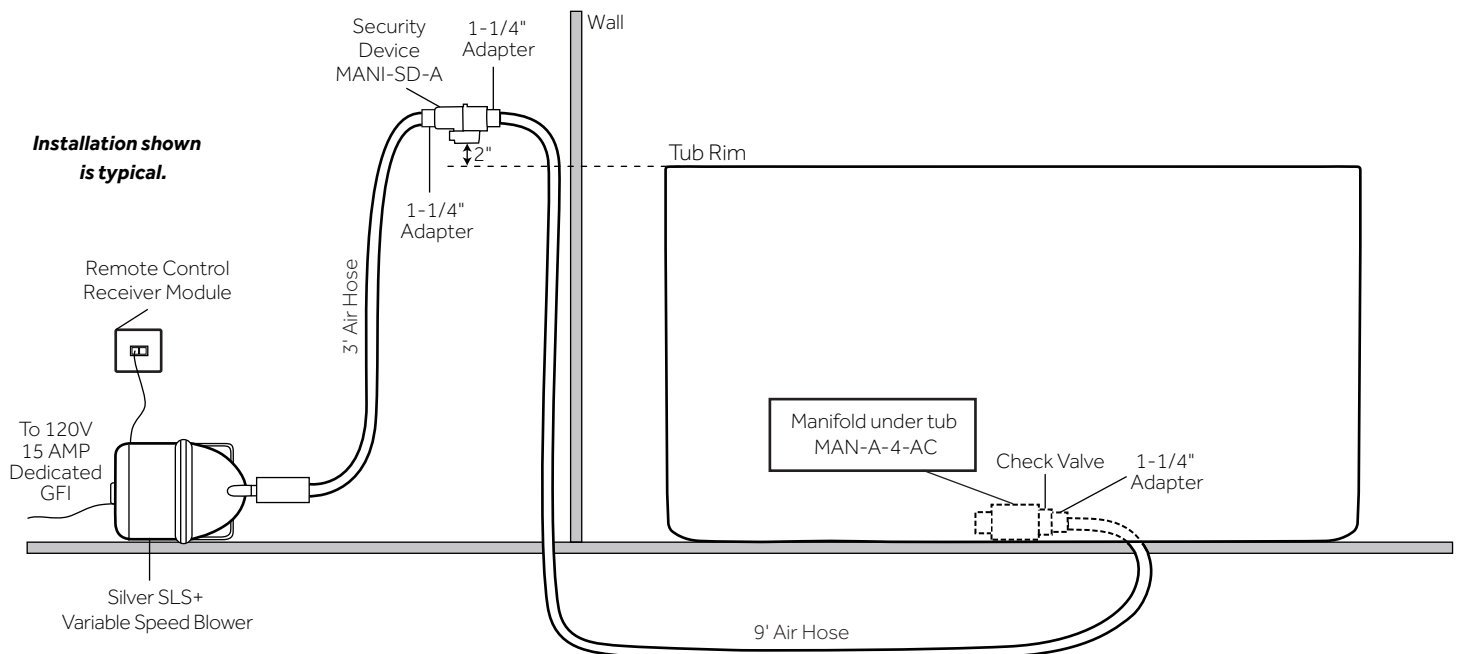
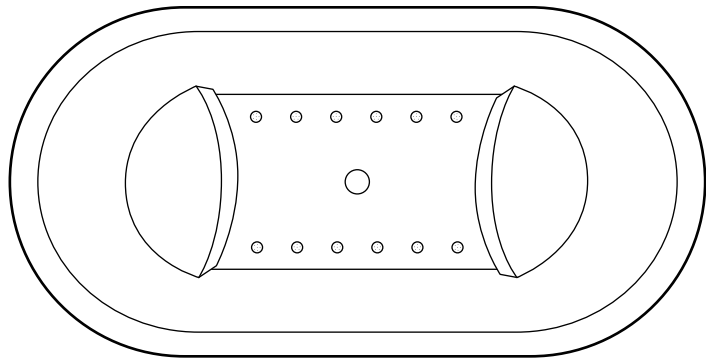

60" WATSON

DOUBLE-WALL HAMMERED COPPER SOAKING TUB

SKU: 921994

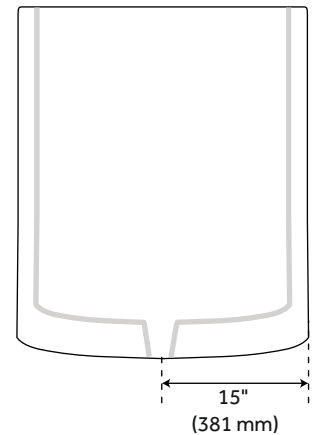
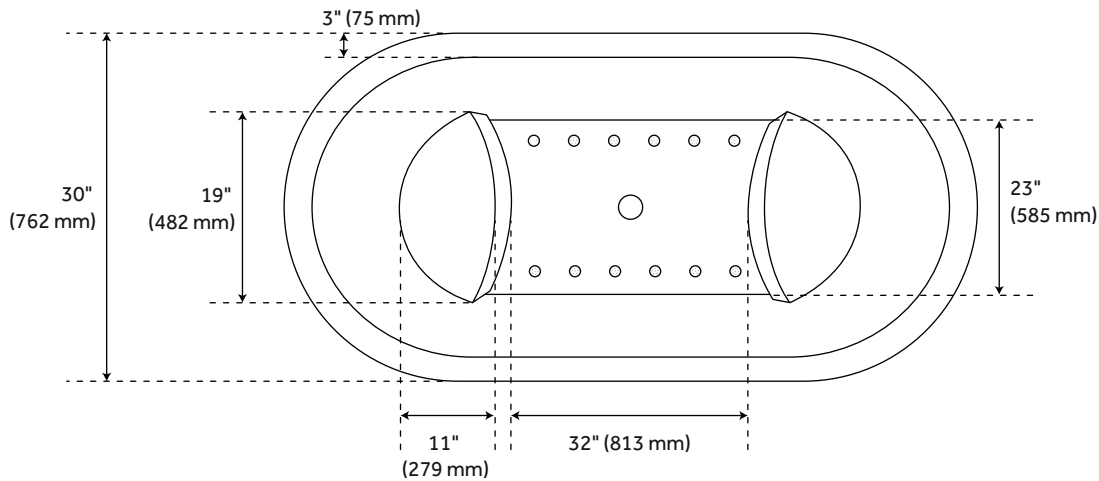

FEATURES

Length: 60"
Width: 30"
Height: 34"
Tub Interior Length: 54"
Tub Interior Width: 23"
Water Depth To Rim: 28-3/4"
Tub Weight Uncrated (Lbs): 200
Tub Weight Crated (Lbs): 310

PRODUCT IMAGE

