

DROP-IN BATHROOM SINK

SKU: 949207, 949208, 949209, 949210

BEFORE YOU BEGIN

We recommend consulting a professional if you are unfamiliar with installing plumbing fixtures. Signature Hardware accepts no liability for any damage to the faucet, plumbing, sink, countertop, or for personal injury during installation.

Observe all local plumbing and building codes.

Unpack and inspect the sink for shipping damage. If any damage is found, contact our Customer Relations team at 1-866-855-2284.

GETTING STARTED

- Ensure that you have gathered all the required materials that are needed for the installation. For these instructions, it is assumed that the vanity and the countertop are in place.

TOOLS AND MATERIALS:



Silicone Sealant
(100% Neutral Cure)



Damp Cloth



Safety Glasses



Scissors



Drill

DROP-IN BATHROOM SINK

SKU: 949207, 949208, 949209, 949210

INSTALLATION

1. Locate the cut out template included with sink. Cut out the inside of the template and discard the cutout portion. Locate the template front to rear and right to left on the countertop so the bowl will not interfere with the cabinets below. Position the template as desired and trace the outline onto the countertop. Discard the template.

Note: Dimensions vary from sink to sink, verify exact size of sink before using the template. Manufacturer is not responsible for miscut templates.

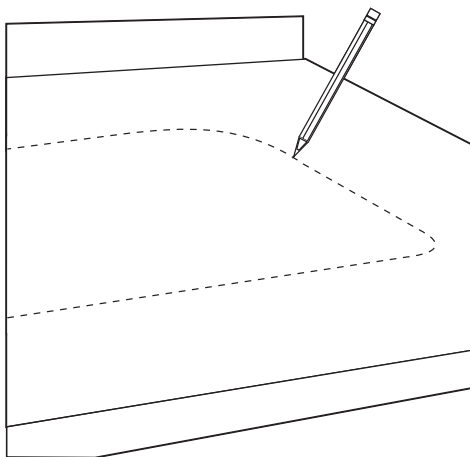

2. Drill starter hole inside of cutout line. Cut inside of line.

Note: Cutting of granite, marble, quartz or stone countertops will require a professional. Consult with a contractor for this step.

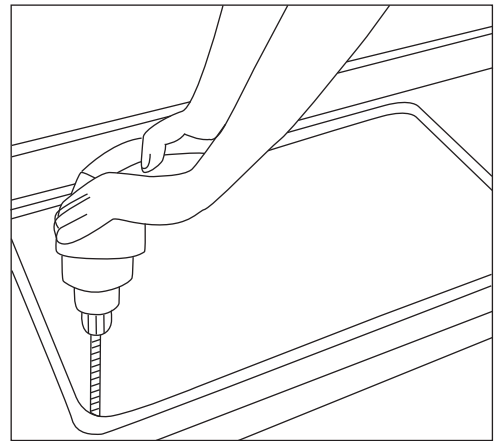

3. Lower the sink into the cutout on the counter to confirm the sink will fit properly. The rim of the sink should sit flat on the countertop.

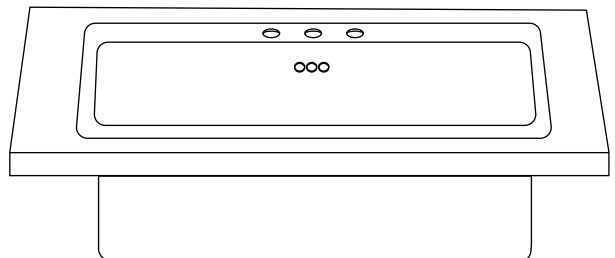

DROP-IN BATHROOM SINK

SKU: 949207, 949208, 949209, 949210

4. Remove the sink and apply a bead of neutral cure silicone sealant around the underside of the rim.

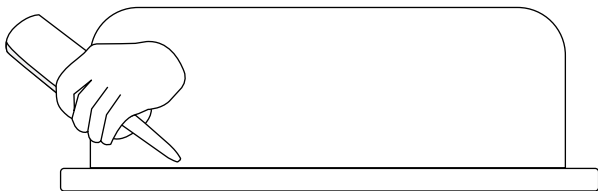

5. Carefully lower the sink back into the cutout and press the sink firmly into place. Wipe any excess sealant with a damp cloth.

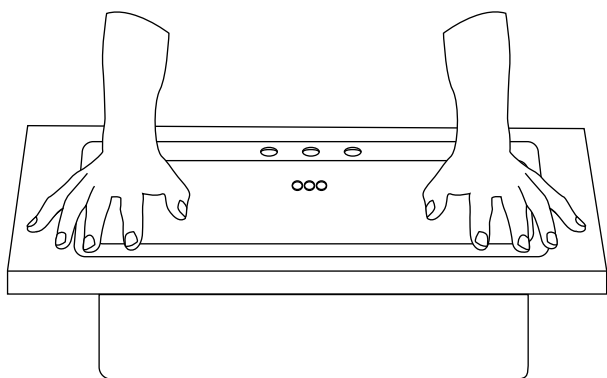

6. Apply a thin bead of silicone sealant around the perimeter of the sink, where the sink meets the countertop. This will prevent moisture from getting underneath the rim of the sink.

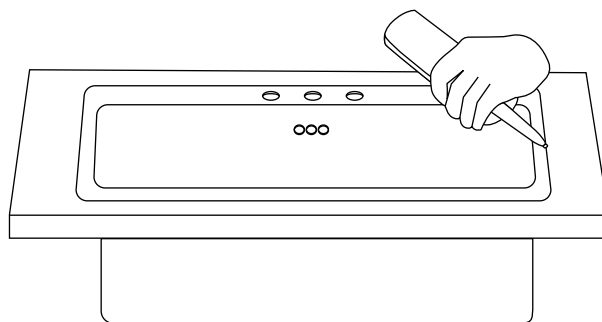

7. Proceed to the installation of your drain and faucet. Allow 24 hours for the silicone sealant to fully cure.

Cleaning and Maintenance

We recommend cleaning sink with soap and water after each use and wiping dry with a soft cloth. Do not use any abrasive scrubs or sponges to clean your porcelain sink, which can scratch or dull the surface.