

FLOORIGAMI™

EASY EDGE

Let's do this

ALL YOU NEED IS SCISSORS

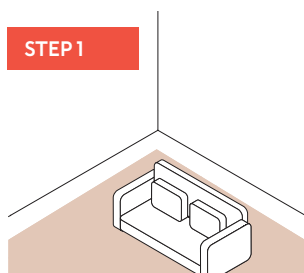

Before you begin, your Floorigami™ tiles should be secure and stuck to the floor. Sweep the surrounding area to ensure it's clean, dry and dust free.

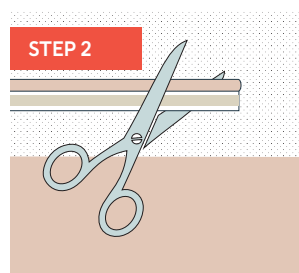

Give your Easy Edge™ a clean cut to start. Pick any side of your rug to begin, just make sure you start in the middle, not the corner.

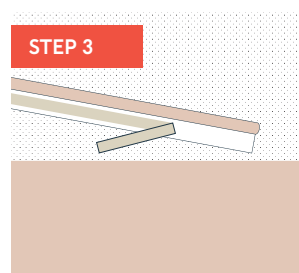

Simply peel the yellow liner off and stick the flat fabric to the back of your Floorigami tiles as you go.

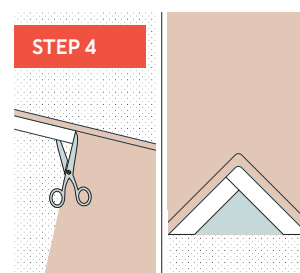

When going around a corner, cut the flat fabric until you get to the rope. Don't cut the rope! Overlap the backing while rounding the corner.



To finish, join your first and last ends together with a clean cut. You can even add a drop of hot melt glue for a secure fit. Voila! Your beautiful Floorigami rug is ready for entertaining.



F

Let's — be friends

Don't forget to snap some pics before you begin.
Your wow-worthy transformation should be seen by all.
Show the world your masterpiece using **#Floorigami**.

Join fellow trendsetters at **floorigami.com** to suggest ideas for new products, tell us what went right and what needs improvement. We'll keep you up to date on new products, promotions and exciting news.

