



SCHONBEK®

GENZANO GE4708N- __ __A



8 Lights
Diameter: 30"
Height: 27"
Hanging Weight: 48lbs.

THIS DESIGN IS THE PROPRIETARY
TRADE DRESS/TRADEMARK OF
SWAROVSKI LIGHTING, LTD.



SCHONBEK®



MAX 60 W

110-120 V

SCHONBEK® is a member of the Swarovski group.

All electrical components must be installed by a licensed electrician in accordance with the National Electric Code and the appropriate local electrical codes.

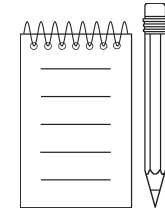
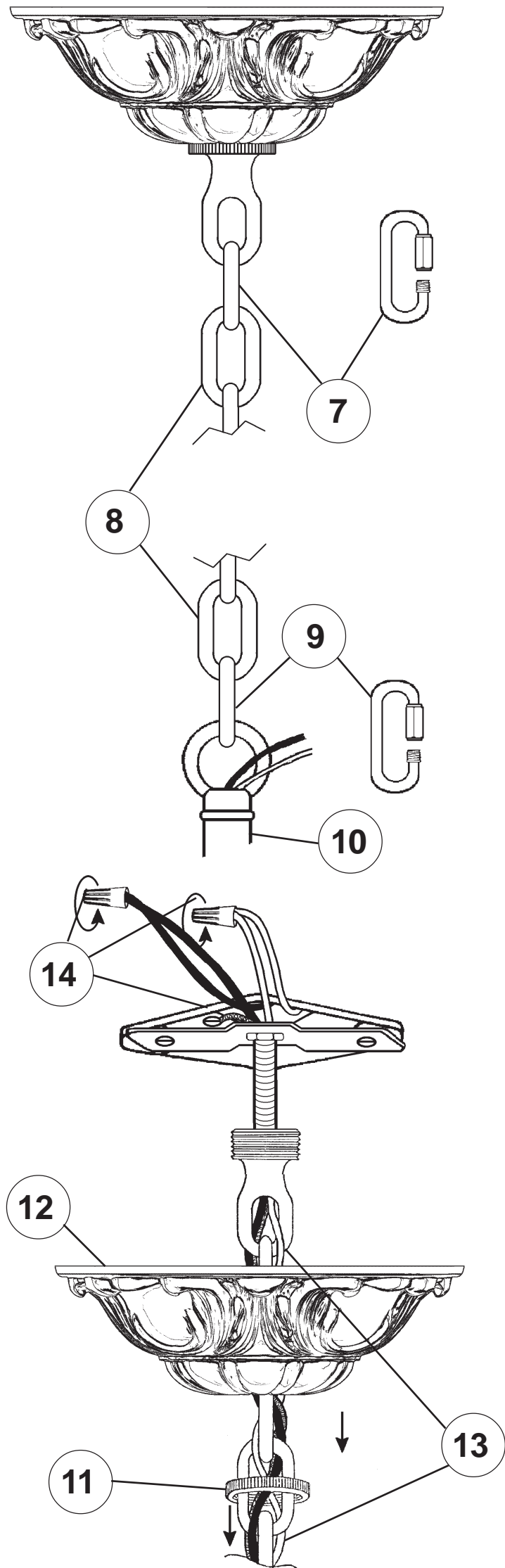
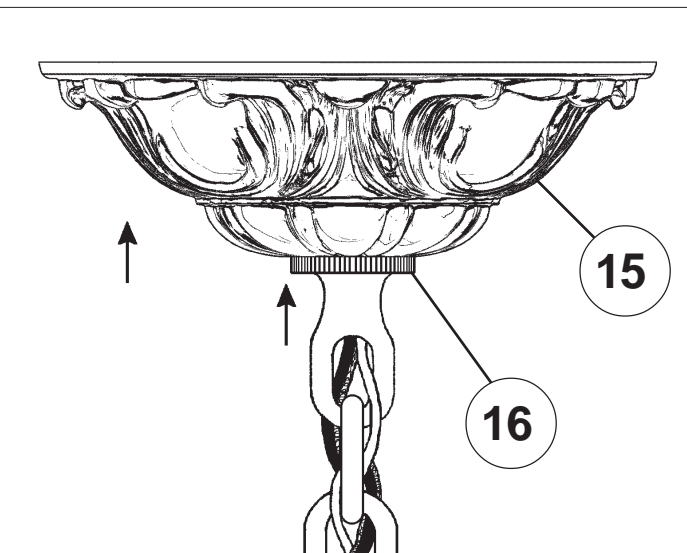
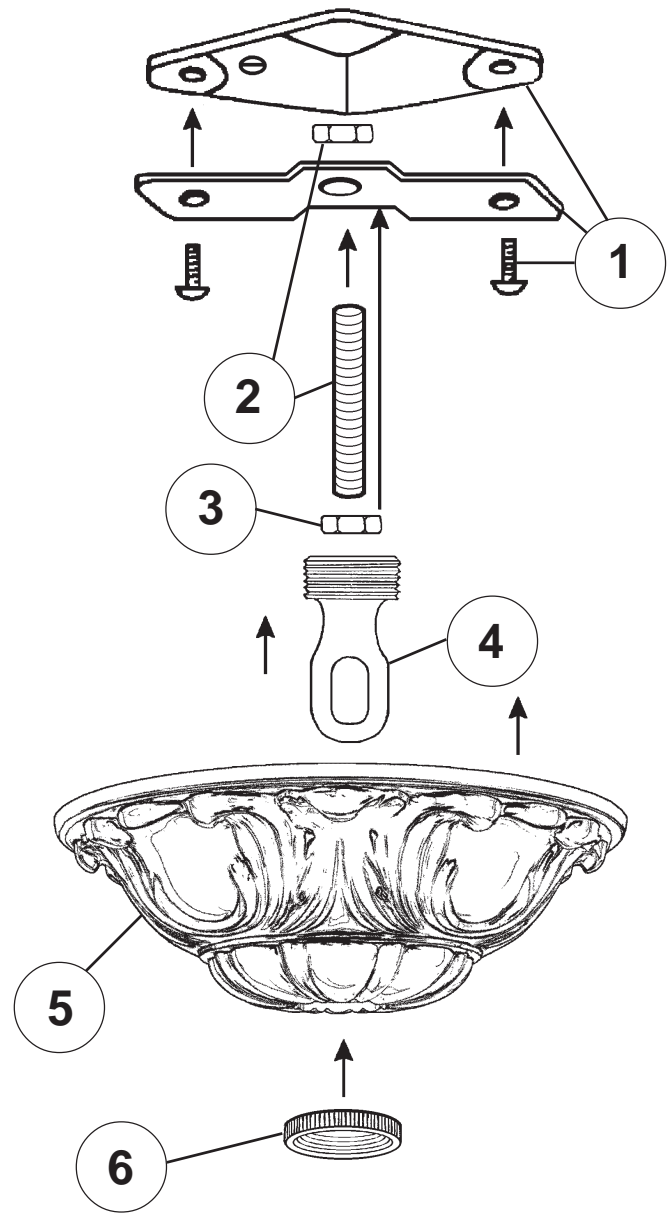

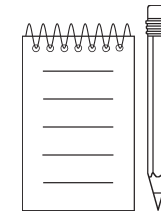
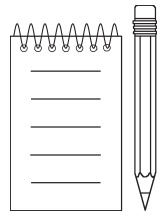

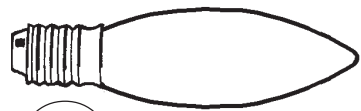

17

You will need 8 - B10
25 Watts Recommended
60 Watts Max

Install bulbs and be sure
to test fixture BEFORE
trimming.

NOTE: CHAIN "D"
SWAGS FROM PIGTAIL
ON "B" TO PIGTAIL ON
"C".

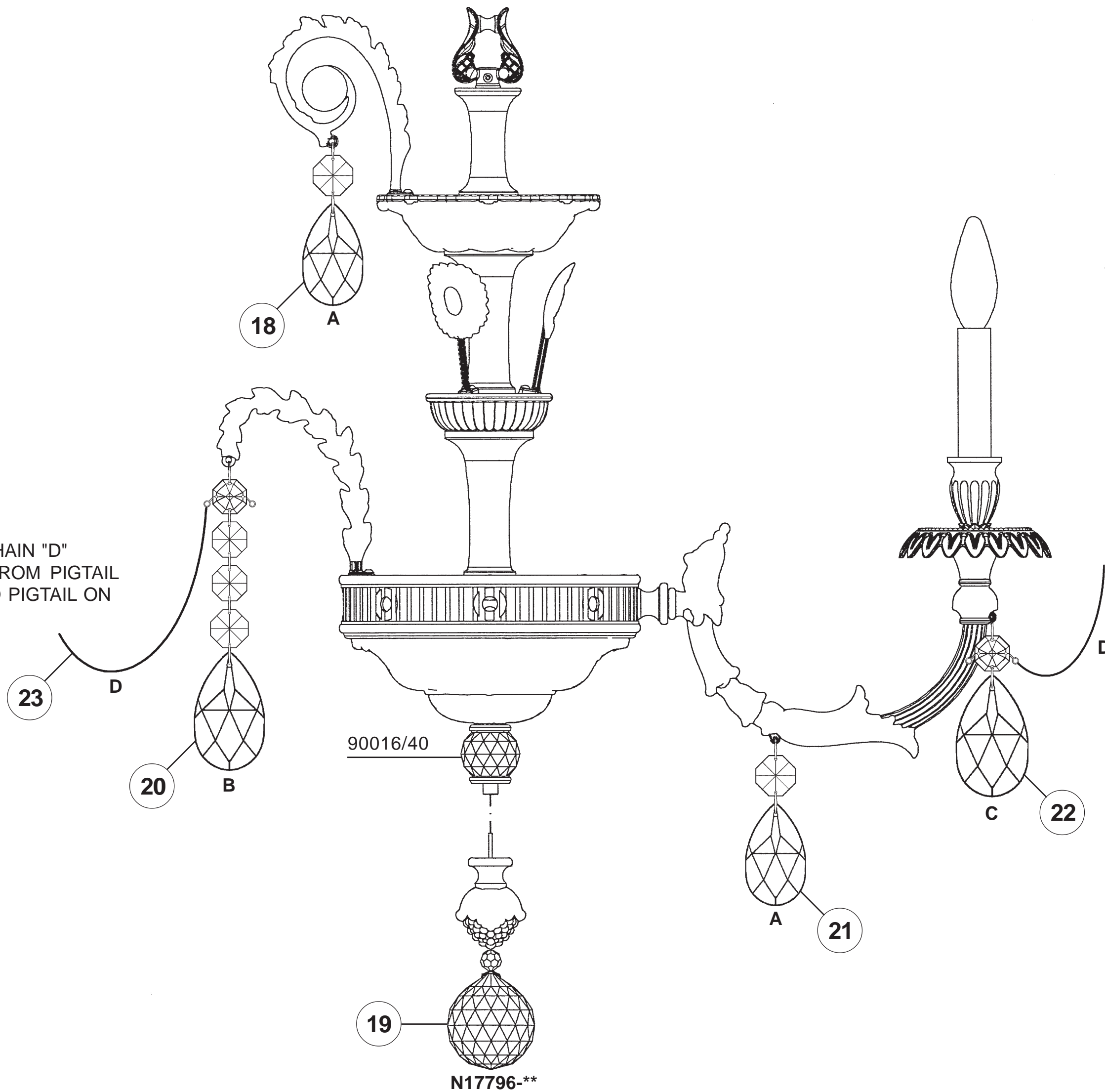

N17796-**

