

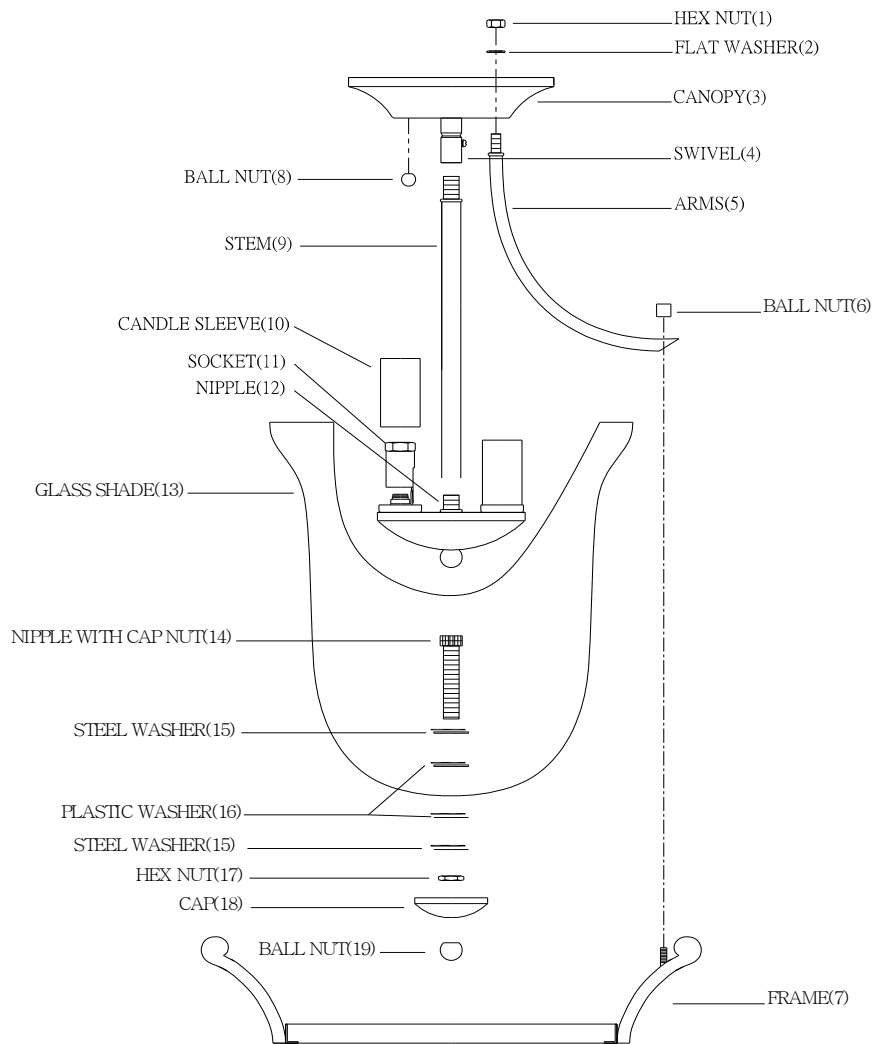

ITEM NO: 6-7133-3-13

## LIGHTING



### INSTALLATION INSTRUCTIONS

1. Carefully remove the fixture out of the carton, and check that all parts are included referring to the above illustration. Make sure not to misplace any parts that are needed for the installation;
2. Install the arm(5) of the canopy (3), flat washer(2), and secure them with fixture hex nut(1);
3. Thread stem(9) into nipple (12), Install stem(9) into swivel(4);
4. Put the candle sleeve(10) onto socket(11);
5. Thread nipple(14) install steel washer(15), plastic washer(16), glass shade(13), steel washer(15) onto nipple(14), and secure them with hex nut(17);
6. Install cap(18) onto nipple(14), secure it with finial(19);
7. Install body onto glass frame(7);
8. Install glass frame(7) onto the arm(5) and secure them with ball nut(6);
9. The fixture is assembled!